

TEMPORARY AND DURABLE 4in YELLOW LINE
 STA 367+00 TO 376+38 SOLID LT&RT
 STA 369+70 DOUBLE SOLID RT
 STA 376+38 TO 383+23 SOLID LT & DASHED RT
 STA 383+23 TO 391+14 DASHED LT & SOLID RT
 STA 391+14 TO 416+50 SOLID LT&RT
 (WITH CENTERLINE BREAKS FOR TOWN HIGHWAYS)

REMOVING SIGNS
 5
 STA 369+70 RT TH #13

YIELDING MARKER POST
 STA 382+68 RT

TEMPORARY AND DURABLE 24in STOP BAR
 STA 369+70 RT

TEMPORARY AND DURABLE LETTER OR SYMBOL
 STA 369+70 RT "STOP"

STEEL BEAM GUARD RAIL, GALVANIZED
 STA 367+00 TO 368+96 LT
 STA 367+00 TO 368+59 LT⁴⁷
 STA 387+12 TO 391+00 LT⁹⁰⁺⁹⁸
 STA 392+27 TO 396+28 LT^{25 37.5}

MANUFACTURED TERMINAL SECTION, FLARED
 STA 368+59 TO 368+96 LT⁴⁷
 STA 386+75 TO 387+12 LT³⁵
 STA 391+00 TO 391+37 LT⁹⁰⁺⁹⁸
 STA 391+90 TO 392+27 LT^{87.5 25}
 STA 396+28 TO 396+65 LT^{37.5 75}

DITCHING LOCATIONS (REFER TO SHEET 10 FOR DETAILS)
 STA 367+00 TO 368+00 RT
 STA 392+30 RO 403+50 RT

TEMPORARY AND DURABLE 4in WHITE LINE
 STA 367+00 TO 416+50 SOLID LT&RT
 (WITH EDGELINE BREAKS FOR TOWN HIGHWAYS)

STA 367+00 TO 368+96 LT
 REMOVAL AND DISPOSAL OF GUARD RAIL⁴⁷
 STA 367+00 TO 368+59 LT
 INSTALL STEEL BEAM GUARD RAIL, GALVANIZED⁴⁷
 STA 368+59 TO 368+96 LT⁸⁵
 INSTALL MANUFACTURED TERMINAL SECTION, FLARED

BRIDGE #16
 STA 368+54 - MM 6.980
 RECLAIM & PAVE

BRIDGE #17
 STA 390+03 - MM 7.387
 RECLAIM & PAVE

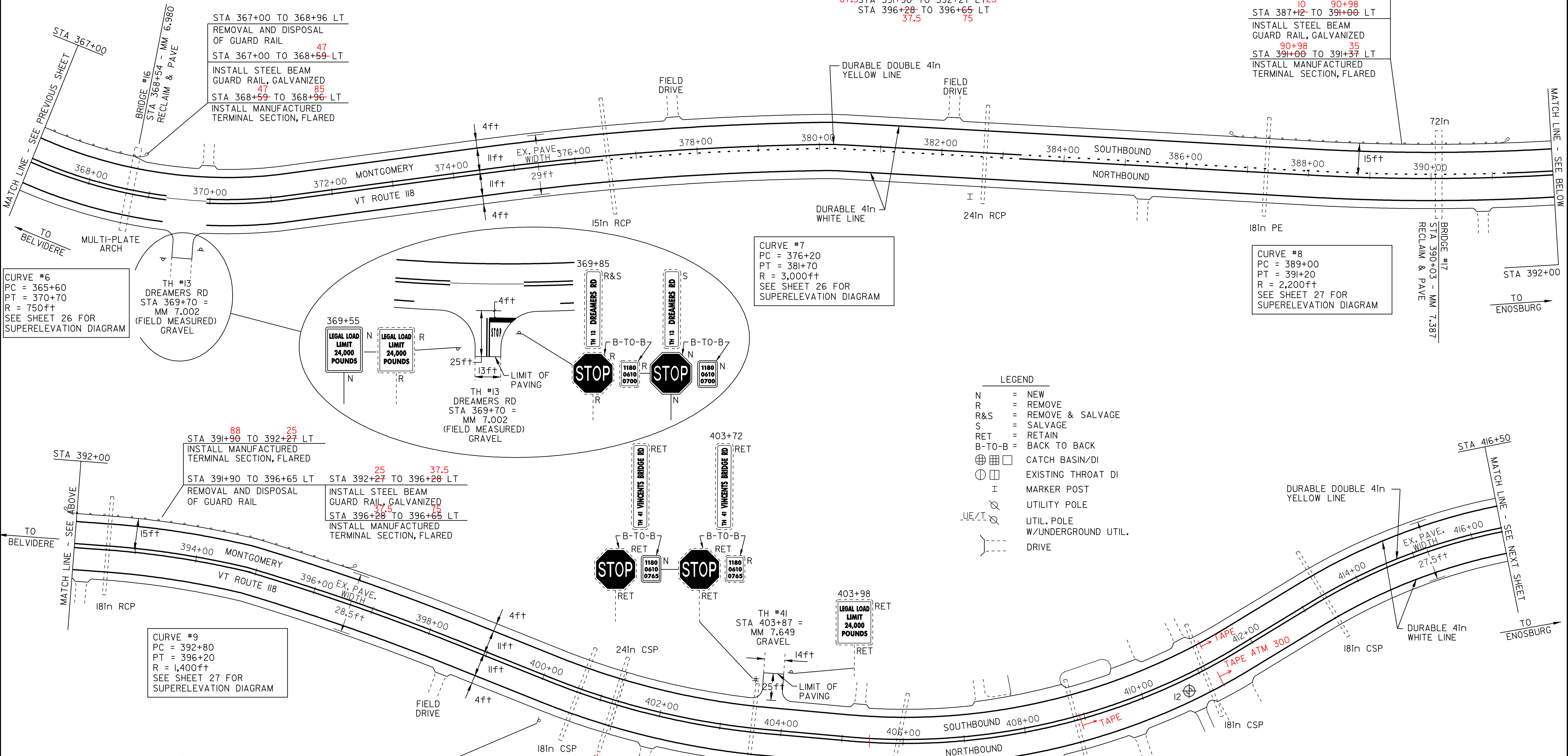

CURVE #6
 PC = 365+60
 PT = 370+70
 R = 750ft
 SEE SHEET 26 FOR SUPERELEVATION DIAGRAM

CURVE #7
 PC = 376+20
 PT = 381+70
 R = 3,000ft
 SEE SHEET 26 FOR SUPERELEVATION DIAGRAM

CURVE #8
 PC = 389+00
 PT = 391+20
 R = 2,200ft
 SEE SHEET 27 FOR SUPERELEVATION DIAGRAM

CURVE #9
 PC = 392+80
 PT = 396+20
 R = 1,400ft
 SEE SHEET 27 FOR SUPERELEVATION DIAGRAM

CURVE #10
 PC = 398+80
 PT = 403+40
 R = 1,700ft
 SEE SHEET 27 FOR SUPERELEVATION DIAGRAM

- LEGEND
- N = NEW
 - R = REMOVE
 - R&S = REMOVE & SALVAGE
 - S = SALVAGE
 - RET = RETAIN
 - B-TO-B = BACK TO BACK
 - ⊕ ⊞ ⊠ CATCH BASIN/DI
 - ⊙ ⊞ EXISTING THROAT DI
 - ⊞ MARKER POST
 - ⊞ UTILITY POLE
 - ⊞ UTIL. POLE
 - ⊞ W/UNDERGROUND UTIL.
 - ⊞ DRIVE

PAVEMENT CORES - ⊕

#	TOTAL DEPTH (in)	SOLID CORE	DRAINABLE BASE	COMMENTS
12	6.0	NO	NO	LITTLE RUTTING

NOTE:
 - NO PCC UNDER ANY CORES
 - NO CORES OVER ASPHALTED
 - NO SHOULDER CORES

PAVING PROJECT LAYOUT SHEET #4

DESIGNED BY BCE/PJM DATE 6-06
 DRAWN BY C.E.A., INC. DATE 6-06
 DESIGN FILE NO. p98c182.dgn
 PRF FILE p98c182104.i DATE PLOTTED 10-FEB-2010 14:
 PROJ. NAME **MONTGOMERY - BERKSHIRE**
 PROJ. NO. **STP 2125(1)S**
 SHEET **14** OF **41** SHEETS