

TEMPORARY AND DURABLE 4in YELLOW LINE
 STA 293+83 TO 305+00
 SOLID LT&RT
 STA 294+89 DOUBLE SOLID RT
 STA 296+89 DOUBLE SOLID RT
 (WITH CENTERLINE BREAKS FOR TOWN & STATE HIGHWAYS)

TEMPORARY AND DURABLE 4in WHITE LINE
 STA 293+83 TO 305+00
 SOLID LT&RT
 (WITH EDGELINE BREAKS FOR TOWN & STATE HIGHWAYS)

TEMPORARY AND DURABLE 24in STOP BAR
 STA 294+89 RT NOTCH RD
 STA 296+89 RT VT ROUTE 242

TEMPORARY AND DURABLE LETTER OR SYMBOL
 STA 294+89 RT "STOP"
 STA 296+89 RT "STOP"

BITUMINOUS CONCRETE GUTTER
 STA 297+50 TO 298+95 RT
 STA 299+73 TO 300+84 LT

REMOVING SIGNS
 7

REHABILITATION OF C.B.'S, D.I.'S, OR M.H.'S

STA 294+77 RT
 STA 298+64 LT
 STA 298+71 RT
 STA 300+55 LT
 STA 300+74 RT
 STA 303+10 RT
 STA 303+17 LT
 297+75 LT
 293+15 RT

CHANGE ELEVATION OF C.B.'S, D.I.'S, OR M.H.'S

STA 294+97 RT
 STA 297+15 RT 77
 STA 297+63 RT
 STA 297+75 LT

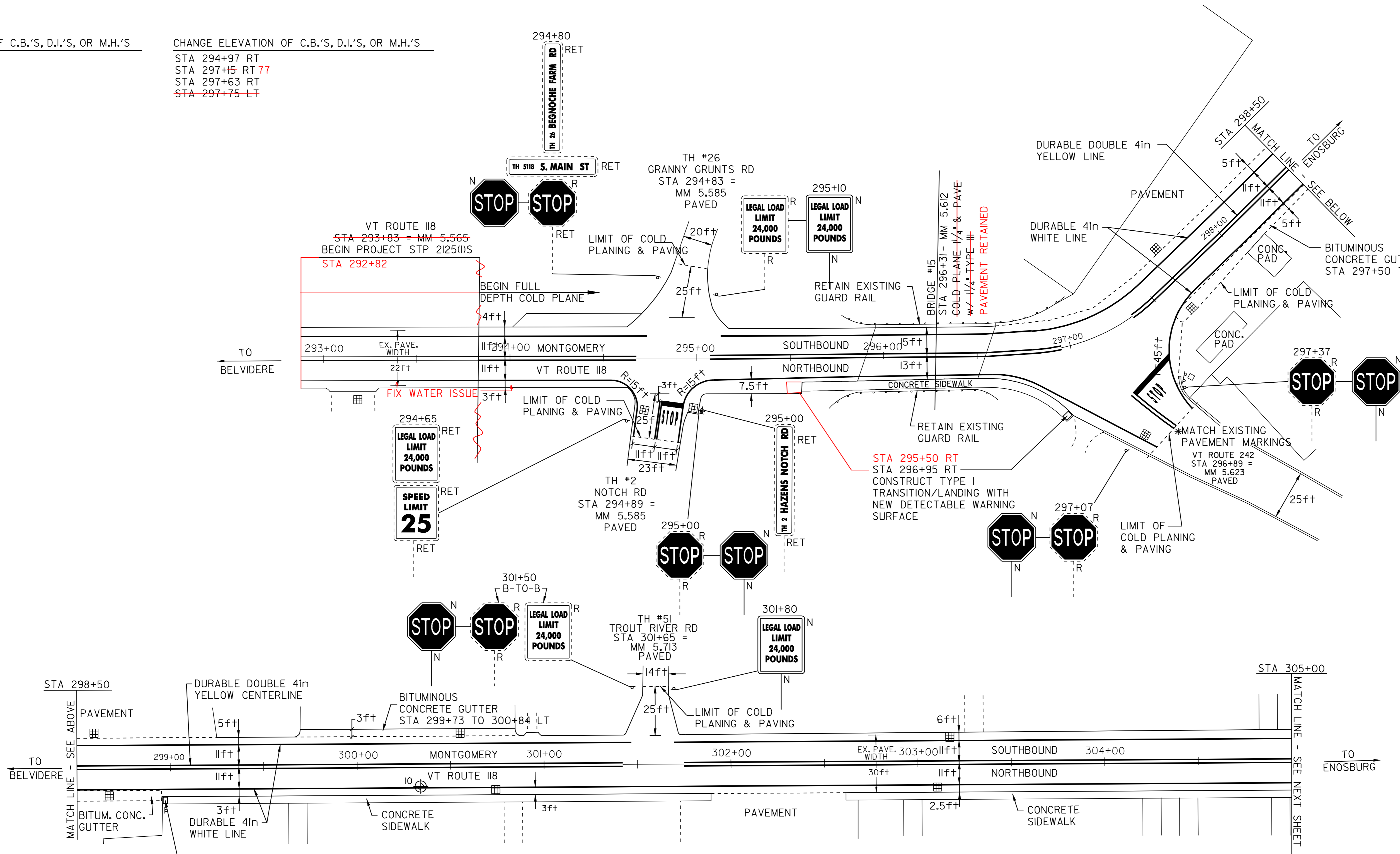

PAVEMENT CORES -

#	TOTAL DEPTH (in)	SOLID CORE	DRAINABLE BASE	COMMENTS
10	1.5	YES	YES	3' OFF SIDEWALK

NOTE:
 - NO PCC UNDER ANY CORES
 - NO CORES OVER ASPHALTED
 - NO SHOULDER CORES

- LEGEND
- N = NEW
 - R = REMOVE
 - R&S = REMOVE & SALVAGE
 - S = SALVAGE
 - RET = RETAIN
 - B-TO-B = BACK TO BACK
 - ⊕ □ = CATCH BASIN/DI
 - ⊙ □ = EXISTING THROAT DI
 - I = MARKER POST
 - ⊗ = UTILITY POLE
 - ⊗/I = UTIL. POLE W/UNDERGROUND UTIL.
 - ⋯ = DRIVE

PAVING PROJECT LAYOUT SHEET #1

DESIGNED BY BCE/PJM DATE 6-06
 DRAWN BY C.E.A., INC. DATE 6-06
 DESIGN FILE NO. p98cl82.dgn
 PRF FILE p98cl8210.l DATE PLOTTED 10-FEB-2010 14:
 PROJ. NAME **MONTGOMERY - BERKSHIRE**
 PROJ. NO. **STP 2125(1)S**
 SHEET **11** OF **41** SHEETS