

TEMPORARY & DURABLE 100 mm WHITE LINE (MOD. I)  
 STA. 4+800.0 TO 5+200.0, SOLID LT. & RT.

TEMPORARY & DURABLE 100 mm YELLOW LINE (MOD. I)  
 STA. 4+800.0 TO 4+956.8, SOLID LT. & RT.  
 STA. 4+956.8 TO 5+182.1, SOLID LT./ DASHED RT.  
 STA. 5+182.1 TO 5+200.0, DASHED CENTERLINE.

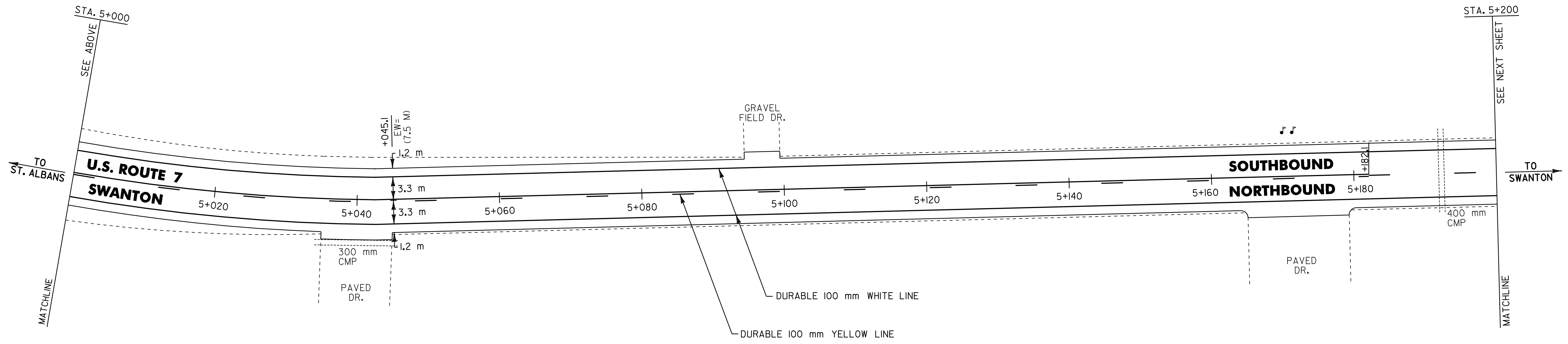
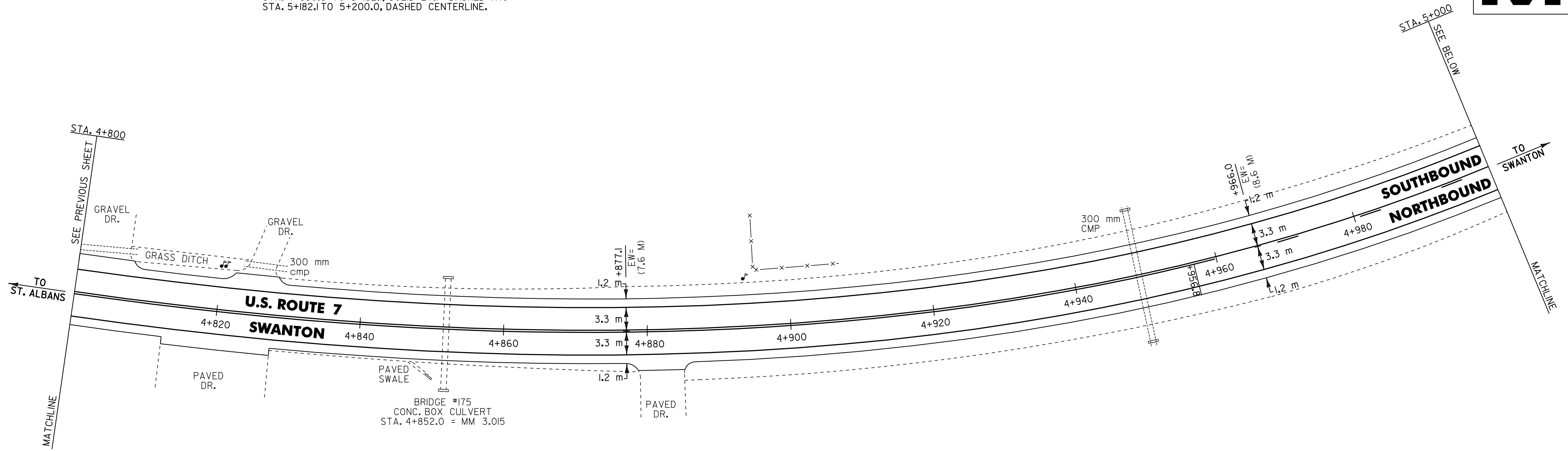

- NOTES: 1) ALL DIMENSIONS IN MILLIMETERS EXCEPT WHERE OTHERWISE INDICATED.
- 2) ALL EXISTING SIGNS NOT SHOWN SHALL BE RETAINED AS DIRECTED BY THE RESIDENT ENGINEER.
- 3) FOR ANY TOWN HIGHWAY OR STREET DETAILS, SEE VTrans STANDARDS E-121M & E-193M.
- 4) EW = EXISTING ROADWAY WIDTH.

<b>LAYOUT SHEET #21</b>	PROJECT NAME: ST. ALBANS - SWANTON
	PROJECT NUMBER: STP 2335(I)S
	FILE NAME: /pave/01c016/p01c016.dgn
	DESIGNED BY: D-H
	PLOT DATE: 16-SEP-2005
	DRAWN BY: D-H
	CHECKED BY: D-H
	SHEET 77 OF 89

