

TEMPORARY AND DURABLE 100 mm WHITE LINE (MOD. 2)  
STA. 2+700.0 TO 2+860.0, SOLID LT. & RT.

TEMPORARY AND DURABLE 100 mm YELLOW LINE (MOD. 2)  
STA. 2+700.0 TO STA. 2+860.0, SOLID LT. & RT.

CHANGING ELEVATION OF D'S, CB'S OR MH'S  
STA. 2+707.5, LT. & RT. - D'S  
STA. 2+742.0, LT. & RT. - D'S

TREATED TIMBER CURB  
STA. 2+776.0 TO 2+795.1, RT.

STEEL BEAM GUARD RAIL  
STA. 2+781.7 TO 2+799.9, RT.  
STA. 2+781.7 TO 2+802.9, LT.

ANCHOR FOR STEEL BEAM RAIL  
STA. 2+799.9, RT.  
STA. 2+802.9, LT.

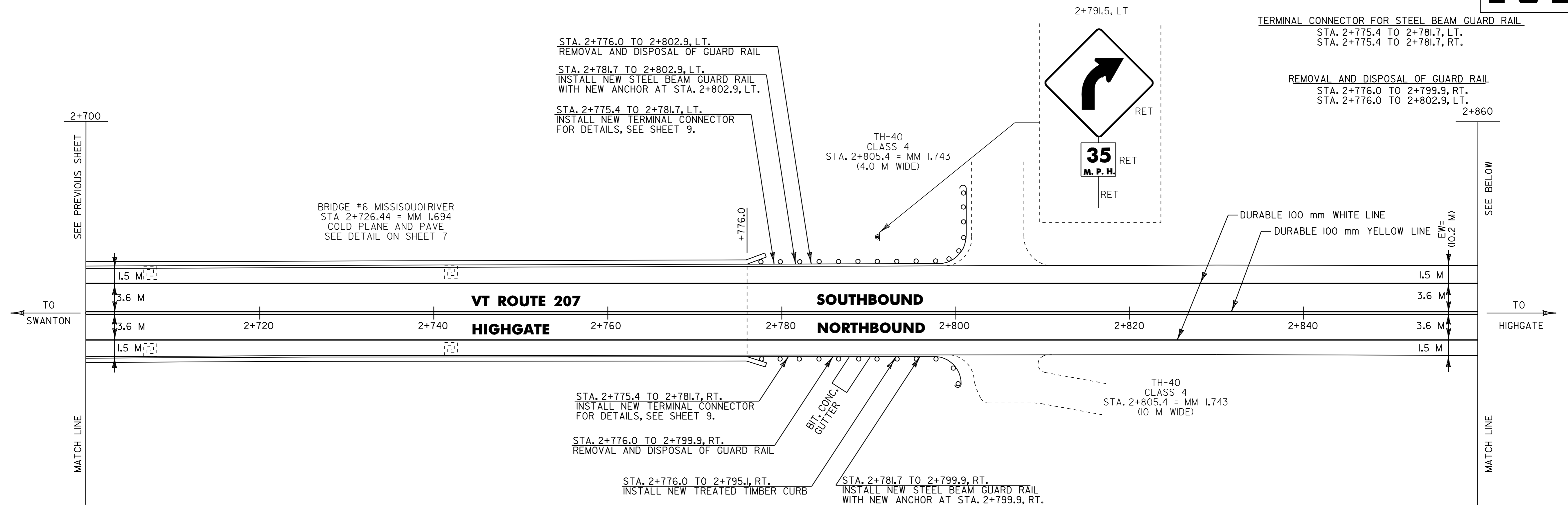

TEMPORARY AND DURABLE 100 mm WHITE LINE (MOD. 2)  
STA. 2+860.0 TO 3+000.0, SOLID LT. & RT.

TEMPORARY AND DURABLE 100 mm YELLOW LINE (MOD. 2)  
STA. 2+860.0 TO STA. 3+000.0, SOLID LT. & RT.

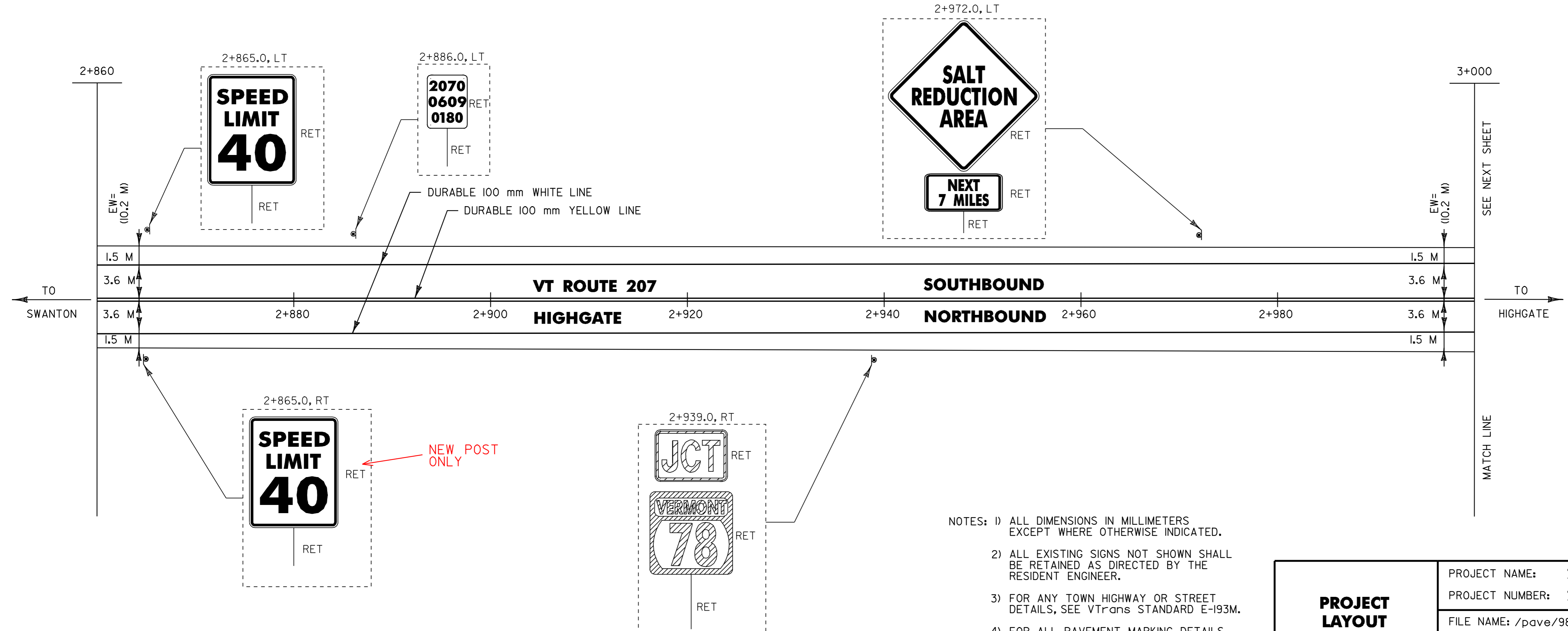

- NOTES: 1) ALL DIMENSIONS IN MILLIMETERS EXCEPT WHERE OTHERWISE INDICATED.  
2) ALL EXISTING SIGNS NOT SHOWN SHALL BE RETAINED AS DIRECTED BY THE RESIDENT ENGINEER.  
3) FOR ANY TOWN HIGHWAY OR STREET DETAILS, SEE VTrans STANDARD E-193M.  
4) FOR ALL PAVEMENT MARKING DETAILS, SEE VTrans STANDARDS E-191M & E-192M  
5) EW= EXISTING ROADWAY WIDTH

<b>PROJECT LAYOUT #23</b>	PROJECT NAME: ST. ALBANS-HIGHGATE	PLOT DATE: 16-SEP-2005 13:17
	PROJECT NUMBER: STP 2114(1)S	DRAWN BY: D-H
	FILE NAME: /pave/98c110/pcl10.dgn	CHECKED BY:
	DESIGNED BY: D-H	SHEET 38 OF 89
	IPARM FILE NAME: pcl10p23.i	

