

TEMPORARY AND DURABLE 100 mm WHITE LINE (MOD. 2)
STA. 2+400.0 TO 2+540.0, SOLID LT. & RT.
(WITH EDGELINE BREAK FOR PARK ST.)

TEMPORARY AND DURABLE 100 mm YELLOW LINE (MOD. 2)
STA. 2+400.0 TO STA. 2+540.0, SOLID LT. & RT.
(WITH CENTERLINE BREAKS FOR PARK ST.)

BITUMINOUS CONCRETE GUTTERS AND TRAFFIC ISLANDS
STA. 2+513.1 TO 2+536.1, RT.
STA. 2+529.1 TO 2+540.0, LT.

REMOVING SIGNS
AS SHOWN - 4

ERECTING SALVAGED SIGNS
AS SHOWN - 2

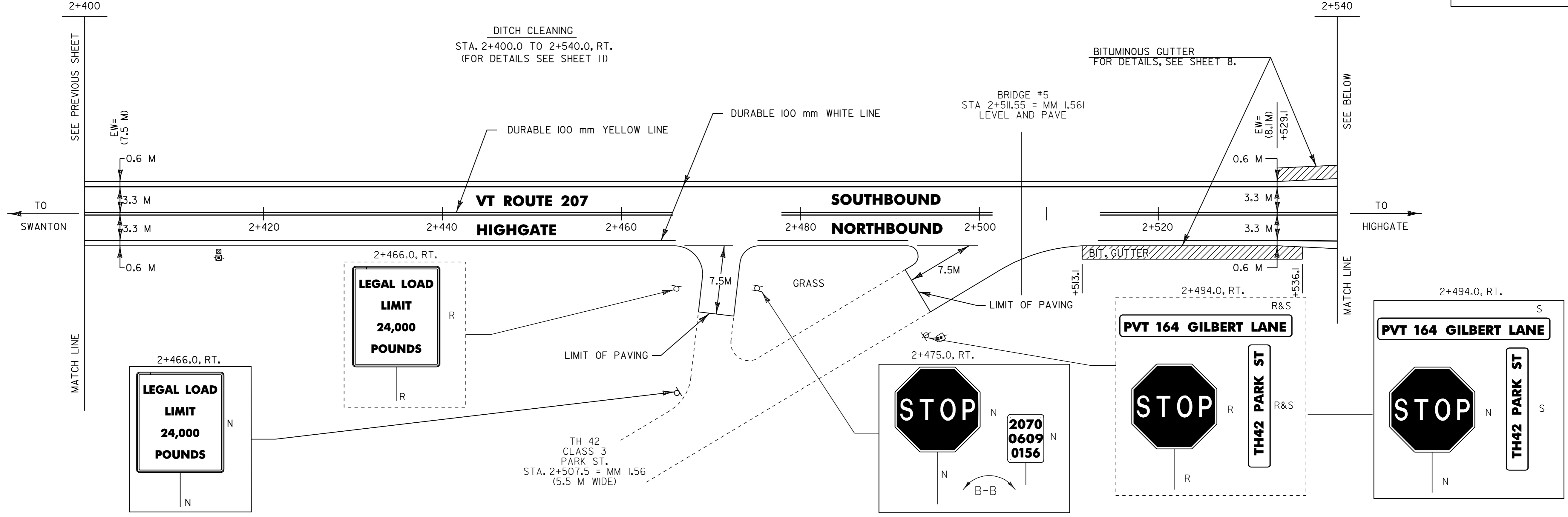

TEMPORARY AND DURABLE 100 mm WHITE LINE (MOD. 2)
STA. 2+540.0 TO 2+700.0, SOLID LT. & RT.

TEMPORARY AND DURABLE 100 mm YELLOW LINE (MOD. 2)
STA. 2+540.0 TO STA. 2+700.0, SOLID LT. & RT.

BITUMINOUS CONCRETE GUTTERS AND TRAFFIC ISLANDS
STA. 2+540.0 TO 2+563.5, LT.

CHANGING ELEVATION OF DI'S, CB'S OR MH'S
STA. 2+680.3, LT. & RT. - DI'S

TERMINAL CONNECTOR FOR STEEL BEAM GUARD RAIL
STA. 2+673.3 TO 2+679.6, LT.
STA. 2+673.3 TO 2+679.6, RT.

REMOVAL AND DISPOSAL OF GUARD RAIL
STA. 2+582.5 TO 2+679.0, RT.
STA. 2+620.1 TO 2+679.0, LT.

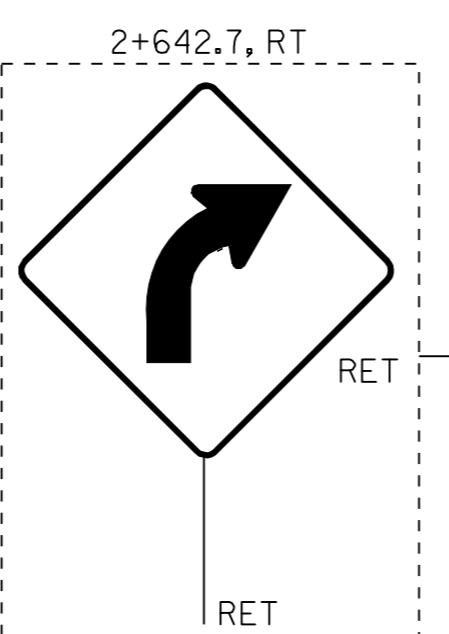
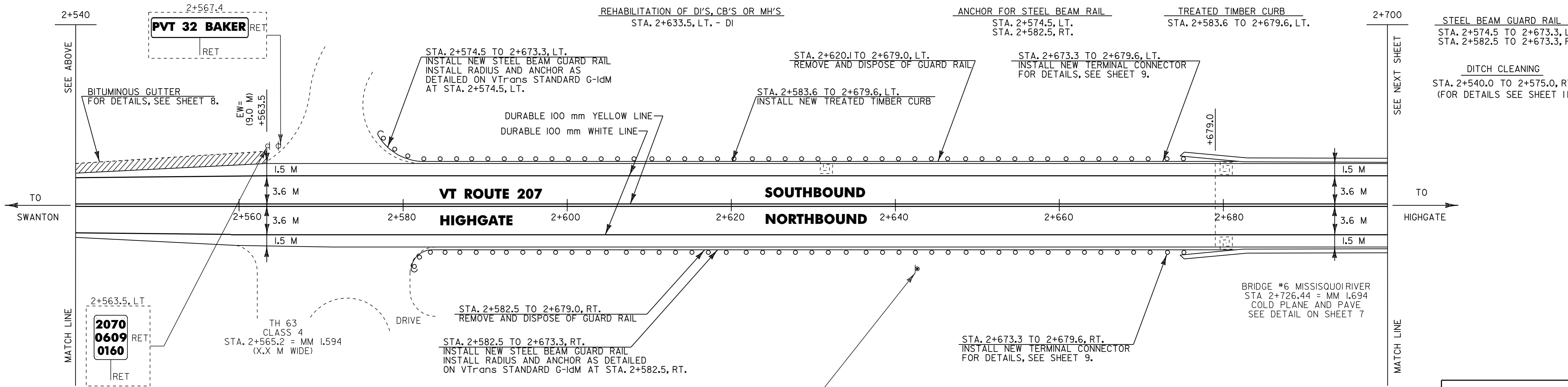

- NOTES: 1) ALL DIMENSIONS IN MILLIMETERS EXCEPT WHERE OTHERWISE INDICATED.
2) ALL EXISTING SIGNS NOT SHOWN SHALL BE RETAINED AS DIRECTED BY THE RESIDENT ENGINEER.
3) FOR ANY TOWN HIGHWAY OR STREET DETAILS, SEE VTRANS STANDARD E-193M.
4) FOR ALL PAVEMENT MARKING DETAILS, SEE VTRANS STANDARDS E-191M & E-192M
5) EW= EXISTING ROADWAY WIDTH

PROJECT LAYOUT #22	PROJECT NAME: ST. ALBANS-HIGHGATE	FILE NAME: /pave/98c110/pcl10.dgn	PLOT DATE: 16-SEP-2005 13:16
	PROJECT NUMBER: STP 2114(1)S	PROJECT LEADER: JLL	DRAWN BY: D-H
		DESIGNED BY: D-H	CHECKED BY:
		IPARM FILE NAME: pcl10p22.i	SHEET 37 OF 89