

TEMPORARY AND DURABLE 100 mm YELLOW LINE
 STA 15+900 TO 16+017 SOLID LT & RT
 STA 16+024 DOUBLE SOLID LT (TH 65)
 STA 16+029 TO ~~16+174~~ SOLID LT & RT **16+205**
~~16+174~~ STA ~~16+174~~ TO ~~16+366~~ DASHED LT, SOLID RT **16+389**
~~16+389~~ STA ~~16+366~~ TO 16+600 SOLID LT & RT

TEMPORARY AND DURABLE 100 mm WHITE LINE
 STA 15+900 TO 16+012 SOLID LT
 STA 15+900 TO 16+600 SOLID RT
 STA 16+036 TO 16+600 SOLID LT

TEMPORARY AND DURABLE LETTER OR SYMBOL
 STA 16+024 LT "STOP" (TH 65)

TEMPORARY AND DURABLE 600 mm STOP BAR
 STA 16+024 LT (TH 65)

CHANGING ELEV. OF DI, CB OR MH
 REHABILITATION OF DI, CB OR MH CLASS I
 STA 16+036 LT

REMOVING SIGNS
 AS SHOWN - 5

ERECTING SALVAGED SIGNS
 AS SHOWN - 3

MANUFACTURED TERMINAL SECTION (FLARED)

STA 16+232 RT - **16+243**

REMOVE AND DISP GUARDRAIL
 STA 16+232 ~ 16+243 RT

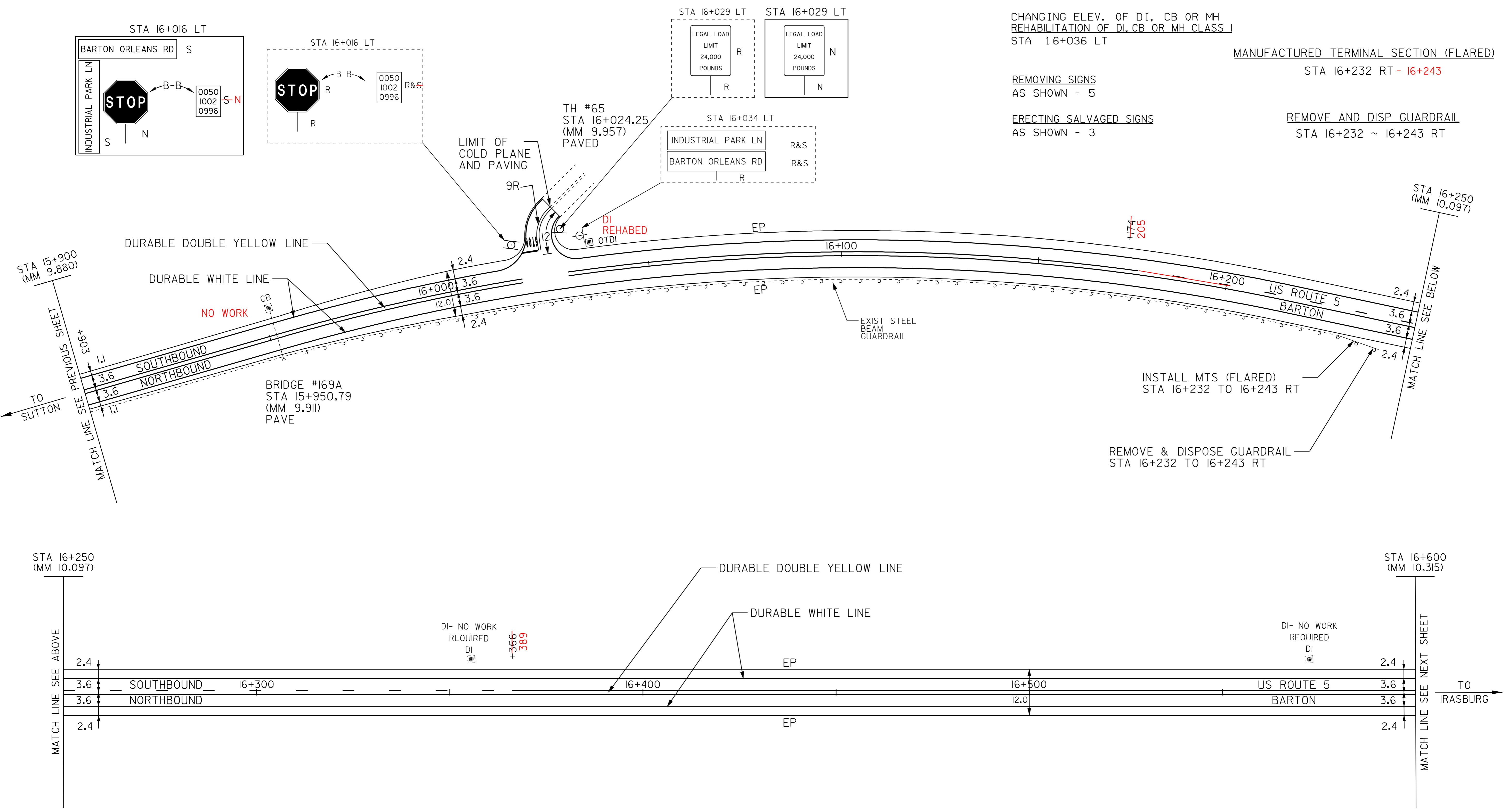

DATUM
 VERTICAL N/A
 HORIZONTAL N/A

NOT TO SCALE

- LEGEND**
- R = REMOVE EXISTING
 - S = SALVAGE
 - R&S = REMOVE AND SALVAGE
 - N = NEW
 - RET = RETAIN
 - B-B = BACK TO BACK
 - = NEW RAIL
 - = EXISTING RAIL
 - ⊗ = BORING LOCATION

NOTE: ALL DIMENSIONS IN METERS EXCEPT AS INDICATED

PAVING PROJECT LAYOUT #13	PROJECT: BARTON-IRASBURG	PROJECT NO.: STP 2107(I)S
	DESIGN FILE NAME: pave/98c096/pc096.dgn	PLOT DATE: 21-MAY-2007
	IPARM FILE NAME: pc096i13.i	SURVEY DATE: 6/99
	SURVEYED BY: CLD ENGINEERS INC	DRAWN BY: NLL
SQUAD LEADER: WRH	SHEET: 24 OF 49	