

H = HOLE SIDE
 SS = SHORT SLOTTED SIDE
 LS = LONG SLOTTED SIDE

- NOTE:
- THIS CONTRACT IS BASED UPON THE CONTRACTOR SETTING AND THE CONTRACTOR IS BASED UPON THE SPACING THE ANCHOR BOLTS TO THE MEASUREMENTS SHOWN ON THE APPROVED SHOP DRAWINGS. THE L.B. FOSTER CO. WILL NOT BE RESPONSIBLE FOR WORK RESPONSIBLE NECESSITATED BY ANY OTHER SETTING AND SPACING.
 - THIS DRAWING IS NOT TO SCALE.
 - FOR GENERAL NOTES AND TYPICAL DETAILS SEE DRAWING LB1.
 - LENGTH OF RAILING ON THIS SHEET IS 402 LF PAY LENGTH.
 - POST SPACING IS MEASURED HORIZONTALLY FF OR RAIL.
 - SPLICE GAP AT SLEEVE = 3/4" TYP. U.N.
 - * RAIL LENGTHS DO NOT INCLUDE GAPS.
 - * COMPENSATION FOR VERTICAL CURVE IS NOT NECESSARY.
 - RAILS ON LARGE RADIUS TO BE FIELD BENT.

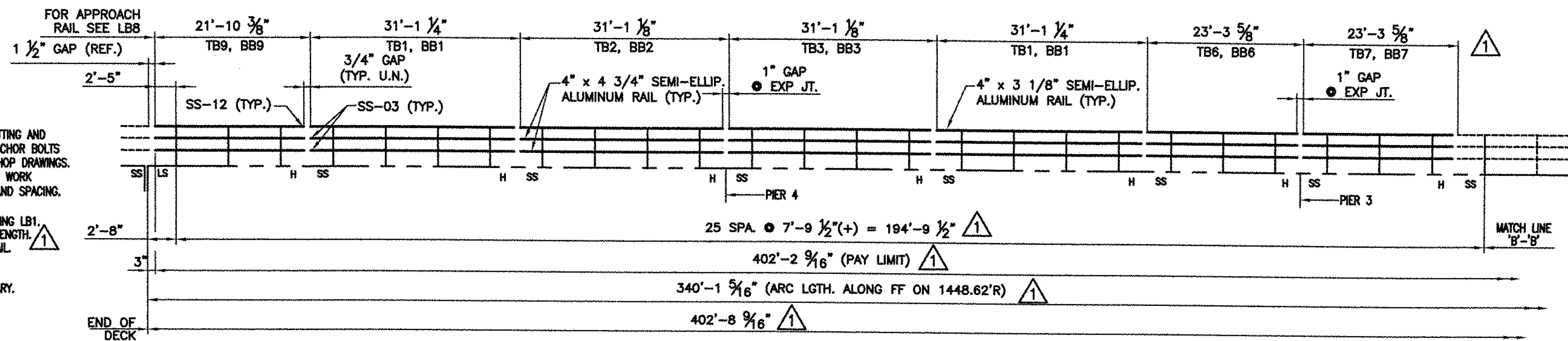

(SPICES @ ENDS TO BE BILLED OUT ON APPR. SHEETS) (TYP.)

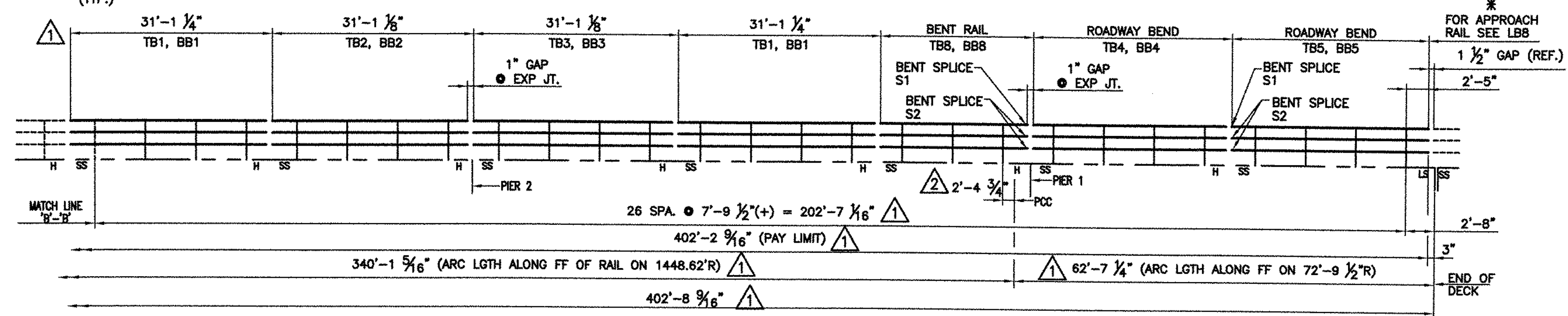

OUTSIDE ELEVATION ~ EAST RAIL ~ CURB SIDE

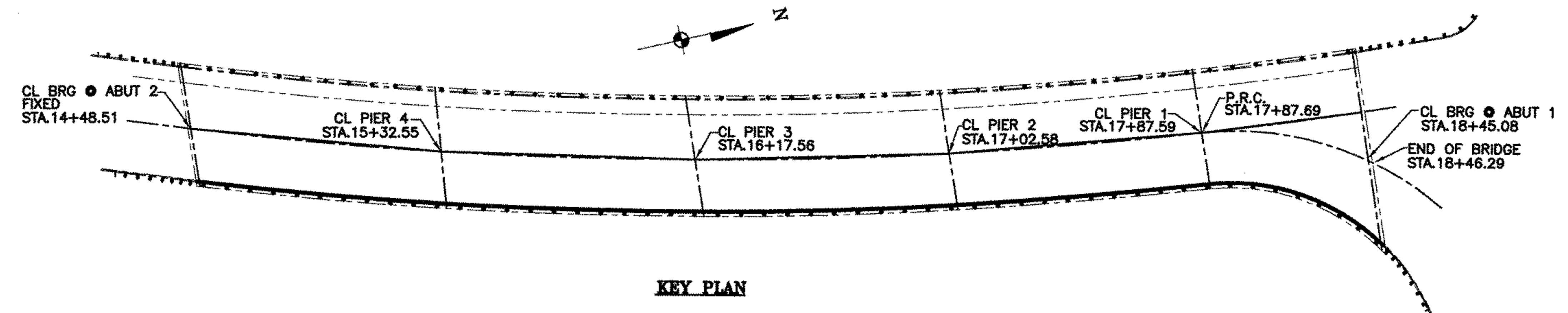

KEY PLAN

ANODIZED
 (SEE NOTES ON LBS)

BRIDGE No. 20
 PROJECT No. BHF 030-2(19)S
 ITEM No. 525.22

APPROVED:	REC'D APPROVAL
DRAWING	
L.B. FOSTER COMPANY	
1016 GREENTREE ROAD PITTSBURGH, PENNSYLVANIA 15220	
FOR: BECK & BELLUCCI, INCORPORATED	
VERMONT AGENCY OF TRANSPORTATION	
TOWN OF CAMBRIDGE, COUNTY LAMOILLE	
BRIDGE RAILING FOR VT15 (MINOR ARTERIAL) OVER LAMOILLE RIVER	
3L ALUM BRIDGE RAILING ~ GENERAL NOTES & TYP. DETAILS	
MADE CMS DATE 01/30/07 JOB No. ARO364 CUST. No.	
CHECK. BLJ DATE 02/28/07 DRAWING LB6	REV. No. 2

REV.	DESCRIPTION	BY	DATE
2	REVISED DIMENSION APPROVER MARKUP	CMS	03/27/07
1	REVISED PER APPROVER MARKUP	CMS	03/22/07