

REINFORCING STEEL (INTERMEDIATE GRADES)

BAR	PIER	SIZE	NO.	TOTAL LENGTH	DETAIL
P1	1	5"	96	6'-4"	3' 4' 5'-3"
P1	2	5"	96	6'-4"	
P1	3	5"	96	6'-4"	
P1	4	5"	98	6'-4"	
P2	1	5"	78	17'-0"	STRAIGHT
P2	2	5"	78	17'-0"	
P2	3	5"	78	17'-10"	
P2	4	5"	80	18'-7"	
P3	1	1"	26	25'-3"	STRAIGHT
P3	2	1"	26	25'-3"	
P3	3	1"	27	25'-6"	
P3	4	1"	27	25'-11"	
P4	1	5"	20	5'-5"	3' 4' 3'-2" 4'
P4	2	5"	20	5'-5"	
P4	3	5"	21	5'-5"	
P4	4	5"	21	5'-5"	
P5	1	1"	8	21'-2"	STRAIGHT
P5	2	1"	8	21'-4"	
P5	3	1"	8	21'-6"	
P5	4	1"	8	21'-6"	
P6	1	5"	20	7'-6"	3'-3" 10" 3'-0" 10"
P6	2	5"	20	7'-6"	
P6	3	5"	21	7'-6"	
P6	4	5"	21	7'-6"	
P7	1	5"	34	30'-6"	STRAIGHT. BEND IN FIELD.
P7	2	5"	34	30'-6"	
P7	3	5"	34	30'-6"	
P7	4	5"	34	30'-6"	
P8	1	5"	18	24'-0"	STRAIGHT
P8	2	5"	18	24'-0"	
P8	3	5"	18	24'-3"	
P8	4	5"	18	24'-7"	
P9	1	5"	30	8'-10"	STRAIGHT
P9	2	5"	30	9'-0"	
P9	3	5"	30	9'-2"	
P9	4	5"	30	9'-2"	
P10	1	3"	6	8'-6"	STRAIGHT
P10	2	3"	6	8'-6"	
P10	3	3"	6	8'-9"	
P10	4	3"	6	8'-9"	

PIER	1	2	3	4
STATION FINISH GRADE	101+06.6	101+91.62	102+76.63	103+61.64
A	445.04	445.84	446.66	447.47
B	445.19	445.99	446.80	447.61
C	445.090	445.90	446.69	447.51
D	445.23	446.04	446.84	447.65
E	445.16	445.96	446.76	447.55
F	445.29	446.09	446.90	447.70
G	445.22	446.02	446.82	447.60
H	445.35	446.15	446.94	447.74
I	445.16	445.94	446.74	447.53
J	445.29	446.09	446.88	447.68
K	445.09	445.88	446.67	447.46
L	445.23	446.02	446.82	447.60
M	445.02	445.81	446.60	447.39
N	445.17	445.95	446.74	447.53
O	3'-0" RAD	3'-0 3/4" RAD	3'-1 1/8" RAD	3'-2 3/8" RAD
R	3'-53'-59"	7'-17'-58"	10'-4'-57"	14'-06'-20"
S	1'-5'-59"	3'-53'-59"	7'-17'-58"	10'-4'-57"
TE	6'-0"	6'-0 1/2"	6'-0 3/4"	6'-1 1/2"
TF	6'-0"	6'-0 1/2"	6'-1 1/4"	6'-2 1/4"
UF	6'-0"	6'-0 1/2"	6'-0 3/4"	6'-1 1/2"
VE	12'-0"	12'-0 1/2"	12'-1 1/4"	12'-2 1/4"
VF	12'-0"	12'-0 1/2"	12'-1 1/4"	12'-2 1/4"
WE	12'-0"	12'-0 1/2"	12'-1 1/4"	12'-2 1/4"
WF	12'-0"	12'-0 1/2"	12'-1 1/4"	12'-2 1/4"
XE	17'-3 1/2"	17'-3 1/2"	17'-6 3/4"	17'-3 3/4"
XF	18'-0"	17'-3 1/2"	17'-10 1/2"	18'-0 1/2"
YE	17'-9 1/2"	17'-10 1/2"	18'-0 3/4"	18'-3 3/4"
YF	0'-2 1/2"	0'-9 1/2"	0'-1 1/2"	0'-2 1/2"
AA	9'-0"	9'-1 1/2"	9'-3 1/4"	9'-4 3/4"
BB	6'-0"	6'-1 1/2"	6'-3 1/4"	6'-4 3/4"
CC	23'-1"	23'-2 1/2"	23'-5 1/2"	23'-6 3/4"
DD	23'-4 1/4"	23'-2 1/2"	23'-5 1/2"	23'-8 3/4"
EE	46'-5 1/2"	46'-5 1/2"	46'-11"	47'-5 1/2"
FF	21'-2"	21'-3 1/2"	21'-4 1/2"	21'-7 1/2"
GG	21'-2 1/4"	21'-3 1/2"	21'-4 1/2"	21'-7 1/2"
HH	42'-4 1/4"	42'-6 1/4"	42'-9 1/4"	43'-2 1/2"
II	20'-2 3/8"	21'-0 1/4"	21'-3 1/8"	22'-7 1/4"

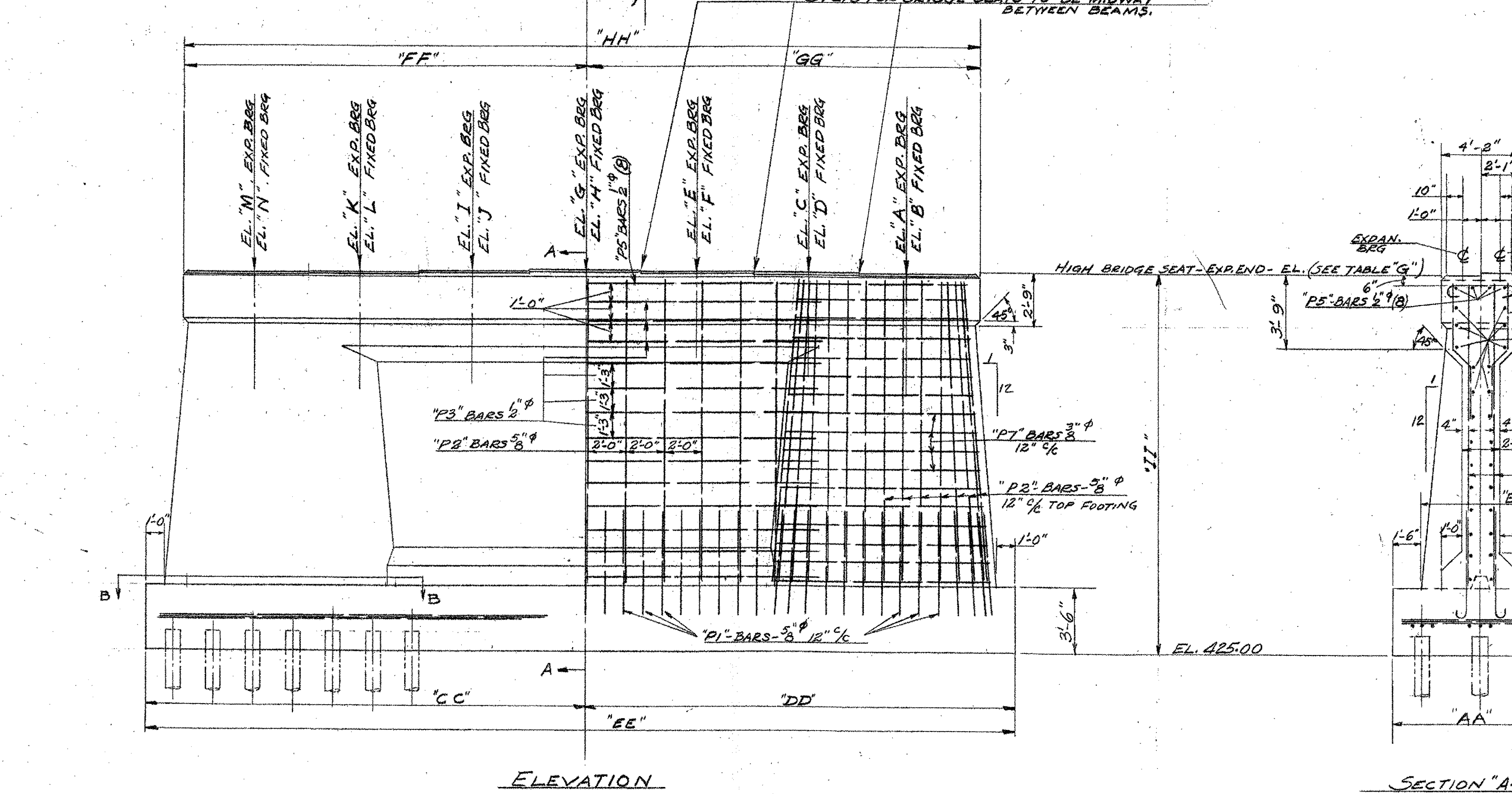

SECTION "A-A"

NOTES

- ALL CONCRETE TO BE CLASS "C"
- ALL EXPOSED EDGES OF CONCRETE TO BE CHAMFERED 1"
- CONSTRUCTION JOINTS WHERE AND AS NECESSARY TO BE IN ACCORDANCE WITH DETAIL "D" ON DWG. SB-20.
- TIMBER PILES TO BE DRIVEN TO A BEARING CAPACITY OF 16 TONS EACH, THEN TRIMMED TO SIZE. UNTREATED TIMBER MAY BE USED. APPROXIMATE LENGTH OF PILES ASSUMED TO BE 30 FEET.
- ALL REINFORCING STEEL DIMENSIONED TO $\frac{1}{8}$ ".

REFERENCE SHEET ONLY
SHEET 68 OF 68

PIER	FINALS			
	1	2	3	4
STRUCTURE EXCAVATION	139 cy.	139 cy.	489 cy.	355 cy.
CONCRETE CLASS "C"	1917 cy.	1931 cy.	2051 cy.	171 cy.
REINFORCING STEEL	4527 lbs.	4604 lbs.	4728 lbs.	4856 lbs.
PILING (SEE NOTES)	1371 LF.	1272 LF.	1502 LF.	1582 LF.
PILING (CUT-OFFS)	277 LF.	333 LF.	154 LF.	216 LF.

PIER	FINALS			
	1	2	3	4
STRUCTURE EXCAVATION	80 cy.	85 cy.	398 cy.	356 cy.
CONCRETE CLASS "C"	147 cy.	154 cy.	161 cy.	168 cy.
REINFORCING STEEL	4530 lbs.	4605 lbs.	4725 lbs.	4850 lbs.
PILING (SEE NOTES)	1410 LF.	1410 LF.	1410 LF.	1410 LF.

CAMBRIDGE
ROUTE-15
PIER Nos 1, 2, 3 & 4
SCALE 1/4" = 1'-0"

Surveyed by
Designed by H.R.D. 6/14/49
Drawn by H.R.D. 6/14/49
Traced by (Retal/Quantities only)
Checked by (J.L.H. Except Quant.)
Series ST No. 122 (M) Filed
Sheet 13 of 29 Sheets