

NOTES
 ALL REINFORCING STEEL DIMENSIONED TO 1/4" OF BARS.
 EXPOSED EDGES OF CONCRETE TO BE CHAMFERED 3/4".
 HAUNCHES TO BE POURED AFTER SUPER-STRUCTURE IS IN PLACE.
 PILING TO BE DRIVEN TO A BEARING CAPACITY OF 15 TONS EACH AND TRIMMED TO SIZE. UNTREATED TIMBER MAY BE USED. APPROXIMATE LENGTH OF PILES ASSUMED TO BE 30 FEET.
 LAP ALL BARS 45 DIAM. IN SPlicing.

REINFORCING STEEL (INTERMEDIATE GRADE)			
BAR SIZE	NO.	TOTAL REQ. LENGTH	DETAIL
A	8	29'-3"	
B	4	28'-3"	
C	4	43'-0"	STRAIGHT
D	2	41'-6"	STRAIGHT
E	48	22'-7"	
F	18	12'-0"	STRAIGHT
G	39	8'-9"	
H	27	12'-1"	
J	51	19'-0"	STRAIGHT (BEND IN FIELD TO SUIT)
K	8	6'-6"	STRAIGHT
L	18	11'-11"	
M	54	8'-10"	

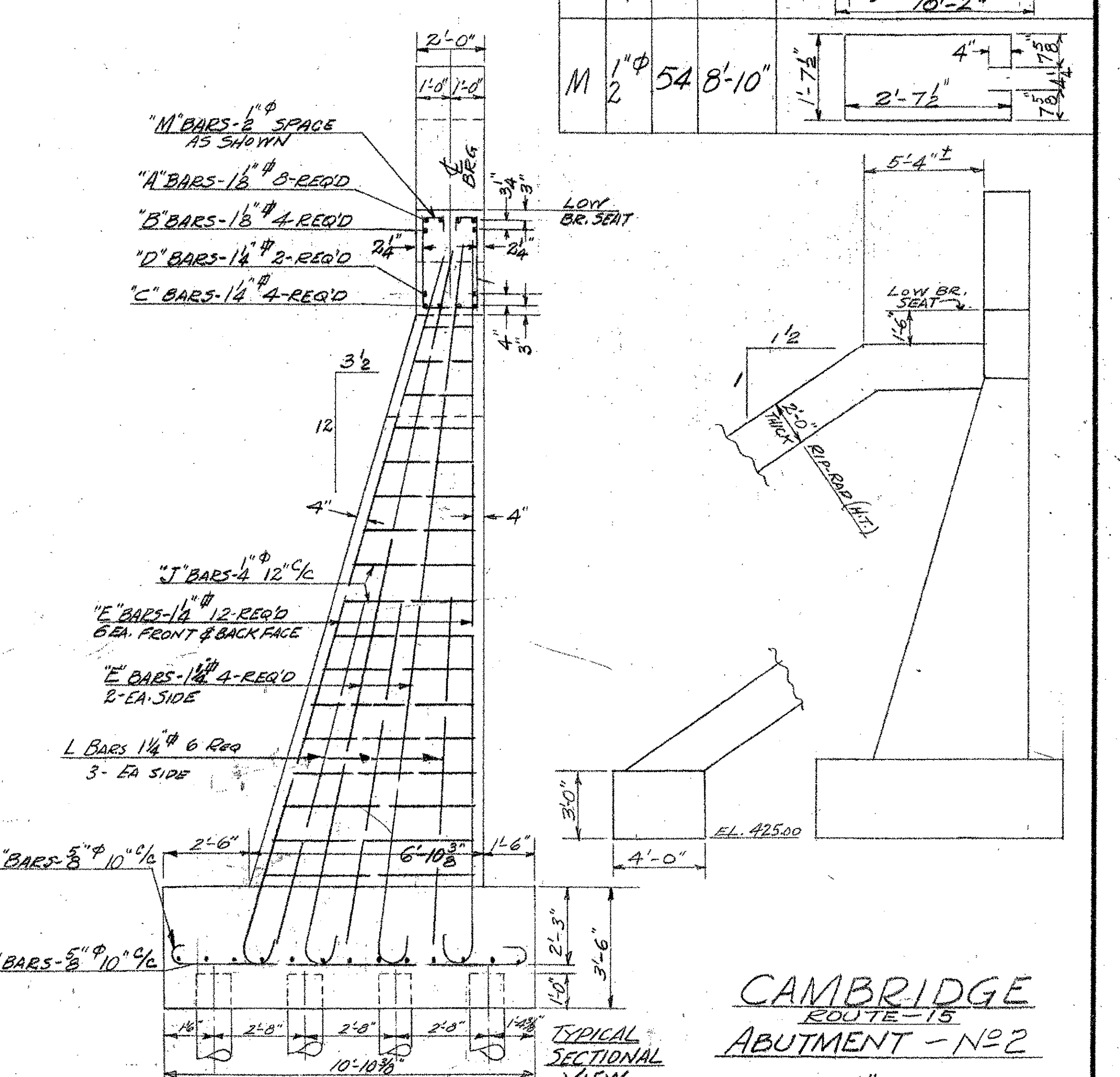
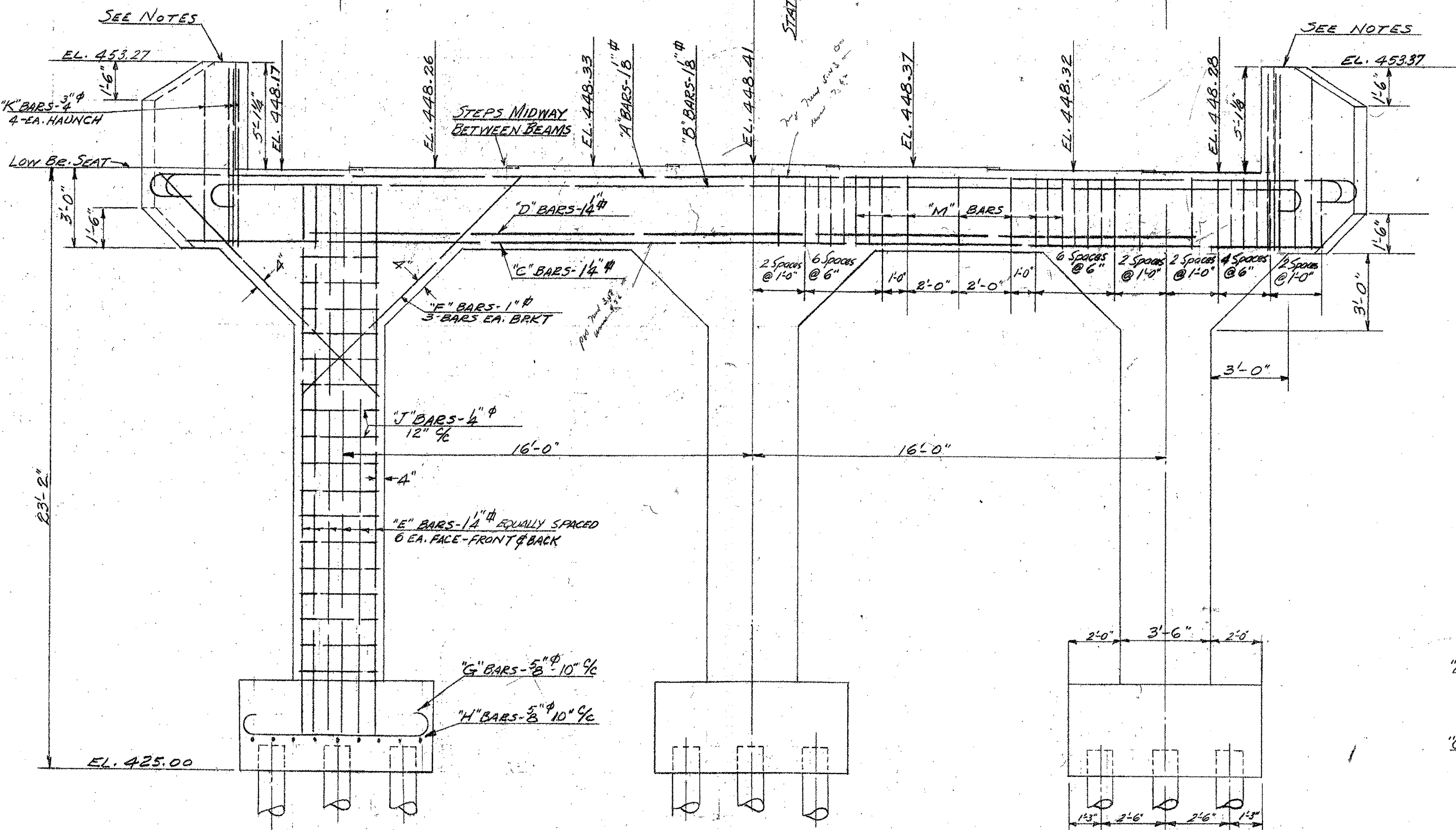

CAMBRIDGE ROUTE-15 ABUTMENT - NO. 2
 Scale - 3/8" = 1'-0"

FINAL	ESTIMATED QUANTITIES	
373 c.y.	STRUCTURE EXCAVATION	277 c.y.
88.5 "	CONCRETE CLASS "B"	34 c.y.
13,632 lbs	REINFORCING STEEL	11,550 lbs
835 L.F.	PILING (SEE NOTES)	1,080 L.F.
237 c.y.	PIP-RAP	403 c.y.
245 L.F.	PILING CUT-OFFS	

Surveyed by
 Designed by H.R.D. 9/1
 Drawn by H.R.D. 12/49
 Traced by (HAS QUANTITIES ONLY)
 Checked by (JLH EXCEPT QUANT.)
 Series ST No. 122 M Filed
 Sheet 12 of 29 Sheets

REFERENCE SHEET ONLY
 SHEET 67 OF 68