

**CURB AND RAIL SECTION**  
SCALE: 1" = 1'-0"

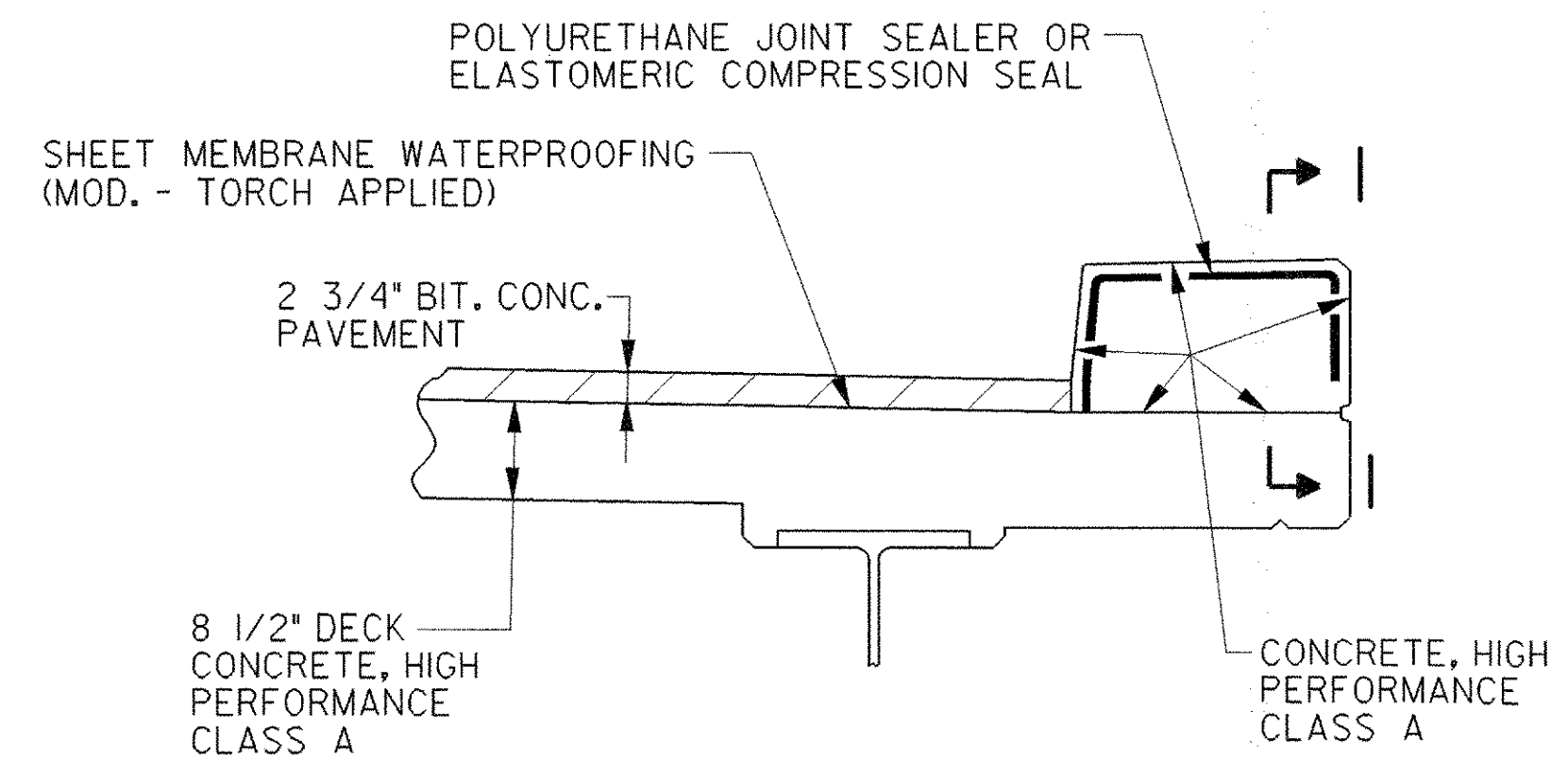

**TYPICAL SECTION THROUGH CONCRETE CURB CONSTRUCTION JOINT**  
N.T.S.

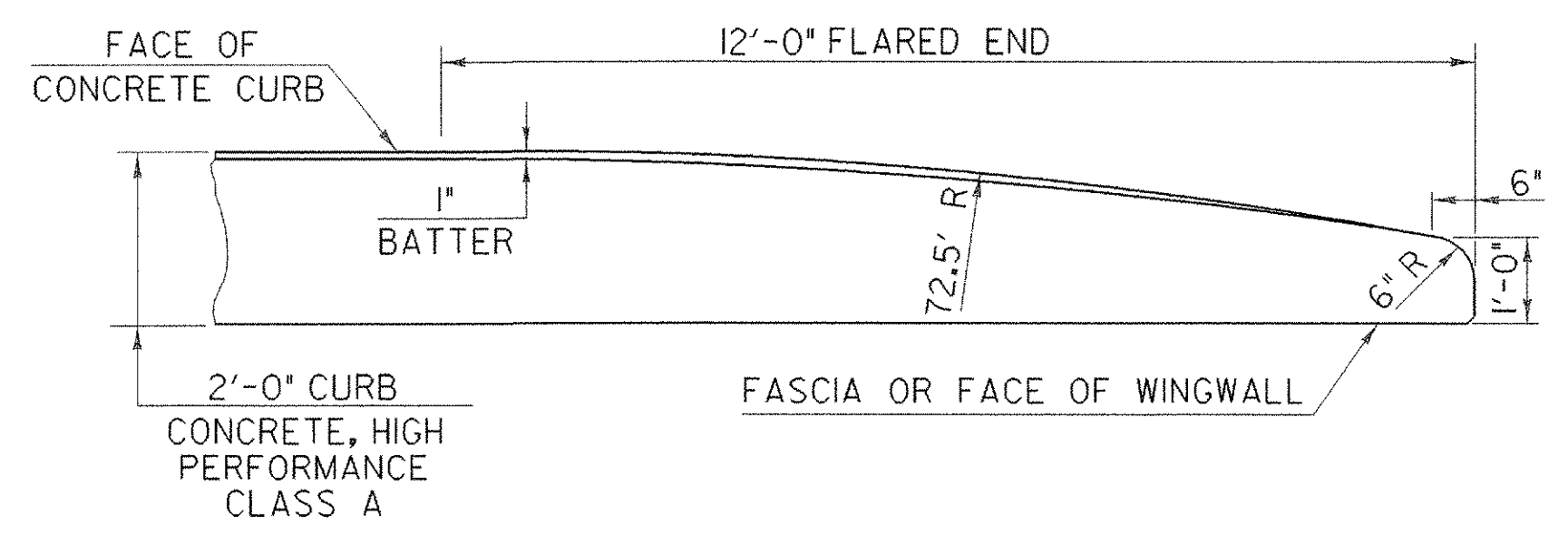

**FLARED END DETAIL FOR 2'-0" CURB**  
N.T.S.

**NOTES**

- INDICATES AREA ALONG DECK AND UP FACE OF CURB FOR PLACEMENT OF 2 COATS OF POLYURETHANE MEMBRANE.
- POLYURETHANE MEMBRANE AND BLAST CLEANING SHALL BE INCLUDED IN THE UNIT PRICE BID FOR SHEET MEMBRANE WATERPROOFING (MOD. - TORCH APPLIED).
- SHEET MEMBRANE WATERPROOFING (MOD. - TORCH APPLIED) SHALL EXTEND TO FACE OF CURB AS SHOWN.
- BLAST CLEAN 3'-0" FROM FACE OF CURB AND 3" UP CURB FACE PRIOR TO PLACING MEMBRANE.
- THERE SHALL BE A CONSTRUCTION JOINT IN THE CURB AND SIDEWALK CENTERED OVER PIERS 1 AND 2 AND 15'-0" EACH SIDE OF THOSE PIERS. THE REMAINDER OF THE CURBS AND SIDEWALKS MAY BE POURED CONTINUOUSLY.
- CONSTRUCTION JOINTS THROUGH CONCRETE CURBS AND SIDEWALKS SHALL BE 1'-6" MINIMUM FROM THE CENTER OF THE NEAREST BRIDGE RAIL POST. CONCRETE PLACED IN SECTIONS SHALL HAVE A MINIMUM OF 48 HOURS DELAY BETWEEN ADJACENT POURS.
- REINFORCING SHALL PASS THROUGH CONCRETE CONSTRUCTION JOINTS.

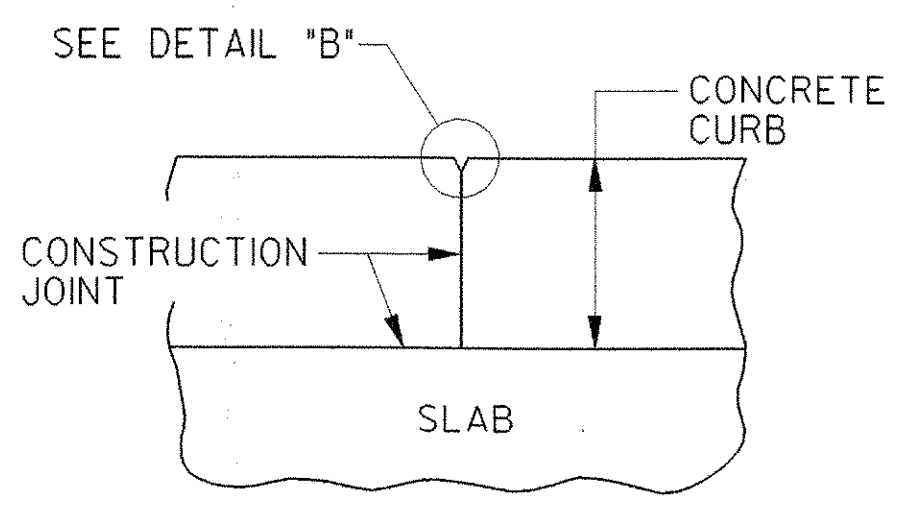

**SECTION I-I**  
N.T.S.

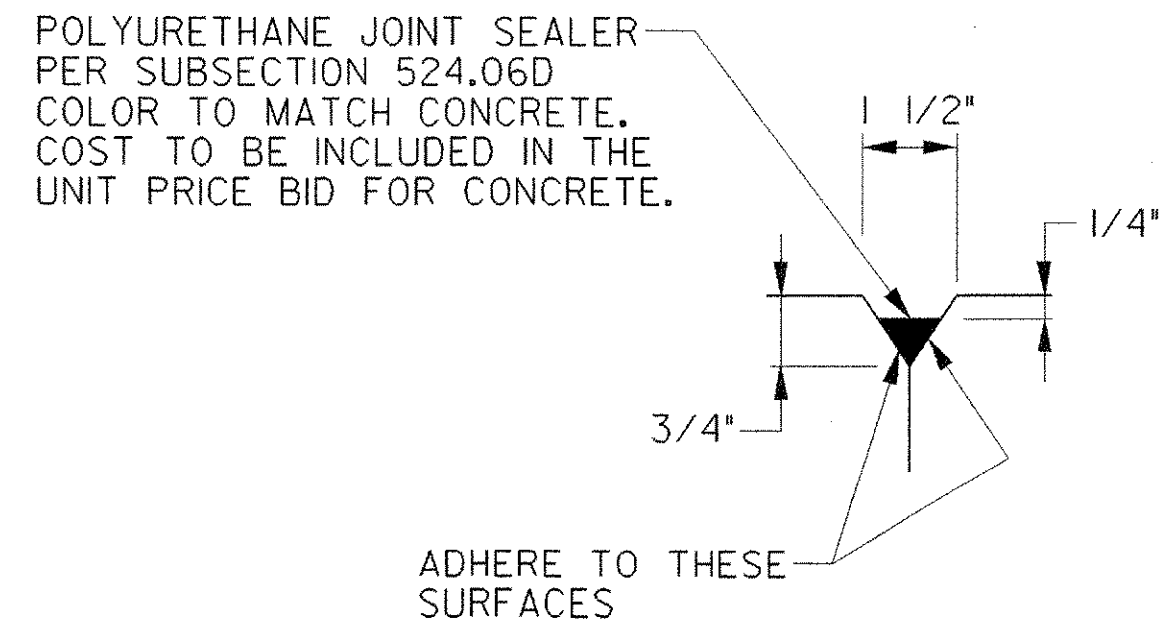

**DETAIL "B"**  
N.T.S.

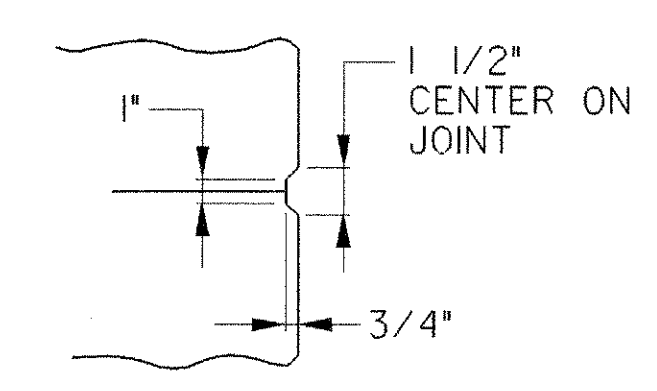

**SCORE MARK DETAIL**  
N.T.S.

<b>STATE OF VERMONT AGENCY OF TRANSPORTATION</b>		
Town Of	CAMBRIDGE	Bridge No. 20
Highway No.	VT 15	Log Sta.
		Surv. Sta.
<b>VT 15 OVER LAMOILLE RIVER CURB AND RAIL DETAILS</b>		
Designed By	E.A. HARTWELL	Drawn By C.L. SZCZEPANSKI
Checked By	Date	Bridge Design Supervisor
	R. SACCHI	R. R. WHITCOMB Date 11/3/2006
PROJECT	CAMBRIDGE	PROJECT NO. BHF 030-2(19)S
I.G.C. Info.		zb308crl.dgn
Bridge Sheet No.		Sheet 52 of 68