

**P.V.C. WATERSTOP FOR JOINTS**

THE COSTS FOR P.V.C. WATERSTOP SHALL BE INCLUDED IN THE UNIT PRICE BID FOR ITEM #501.33, "CONCRETE, HIGH PERFORMANCE CLASS A". OTHER CONFIGURATIONS MAY BE USED UPON APPROVAL OF THE STRUCTURES ENGINEER.  
N.T.S.

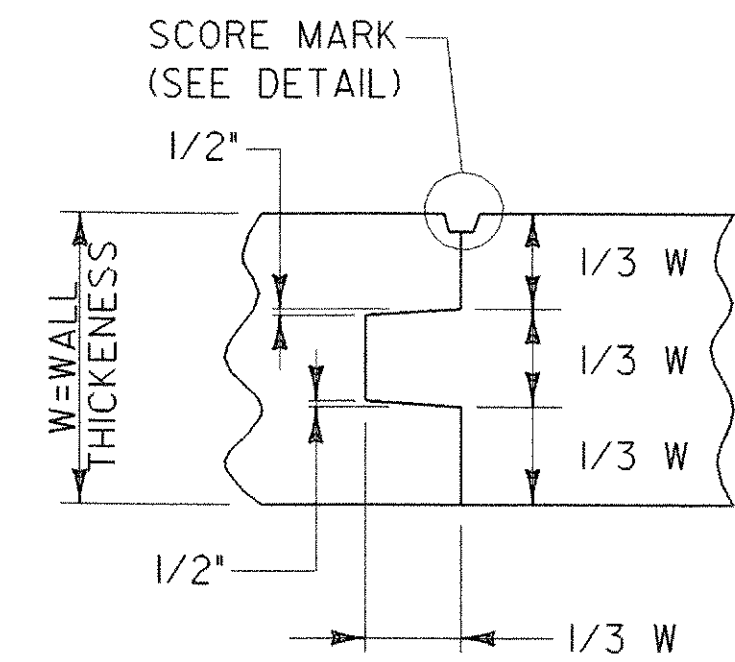

**TYPICAL CONCRETE CONSTRUCTION JOINT**

N.T.S.

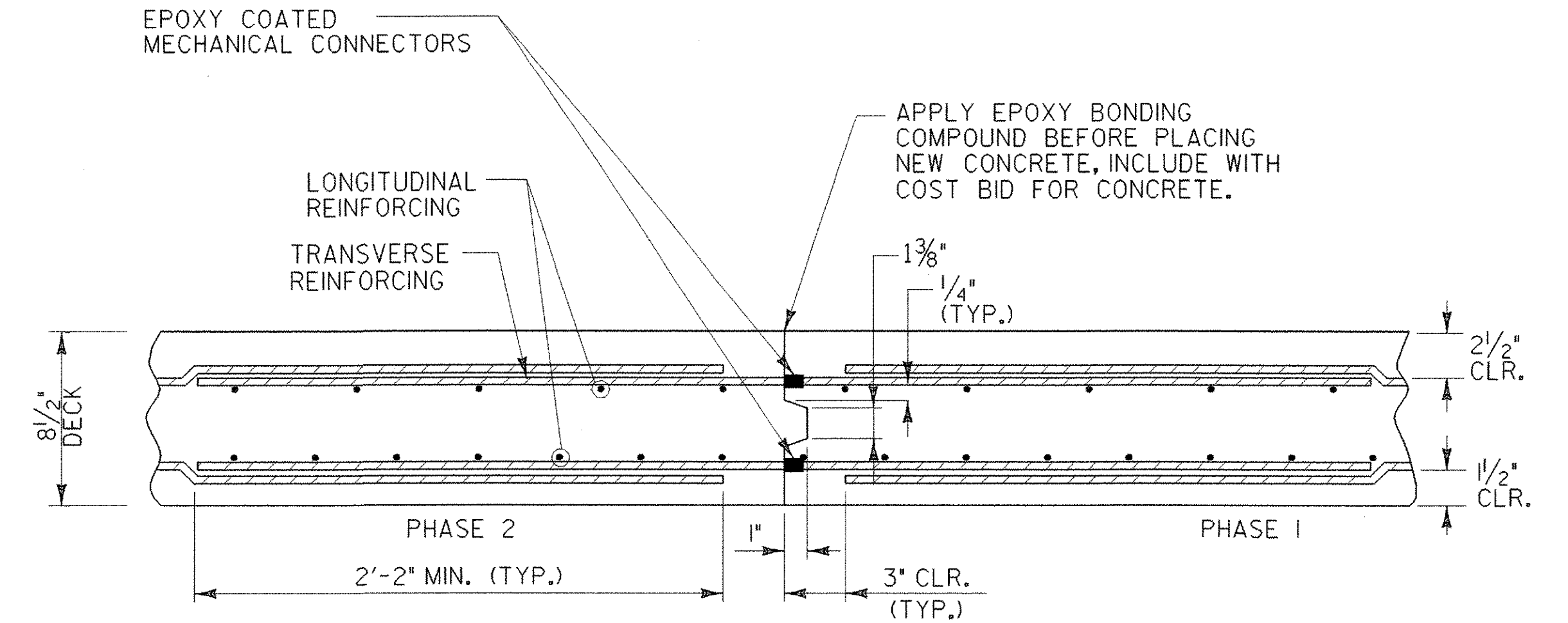

**LONGITUDINAL BRIDGE SLAB CONSTRUCTION JOINT DETAIL WITH MECHANICAL CONNECTORS**

SPAN NO. 1 & APPROACH SLAB CONSTRUCTION JOINT SIMILAR  
N.T.S.

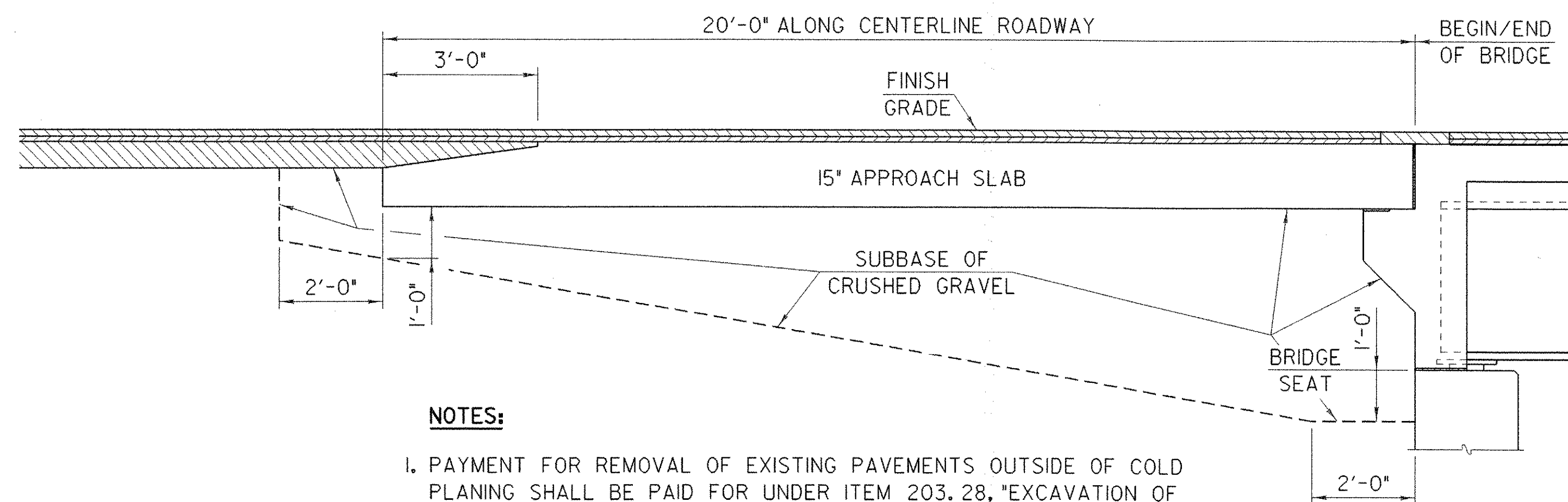

**NOTES:**

- PAYMENT FOR REMOVAL OF EXISTING PAVEMENTS OUTSIDE OF COLD PLANING SHALL BE PAID FOR UNDER ITEM 203.28, "EXCAVATION OF SURFACES AND PAVEMENTS".
- PAYMENT FOR EXCAVATION OF EXISTING MATERIAL BELOW EXISTING PAVEMENTS TO LIMITS OF NEW SUBGRADE SHALL BE PAID FOR UNDER ITEM 203.15, "COMMON EXCAVATION".
- NEW SUBBASE OF CRUSHED GRAVEL SHALL BE PAID FOR UNDER ITEM 310.26, "SUBBASE OF CRUSHED GRAVEL (FINE GRADED)".

**EXCAVATION PAYMENT LIMITS DETAIL**

N.T.S.

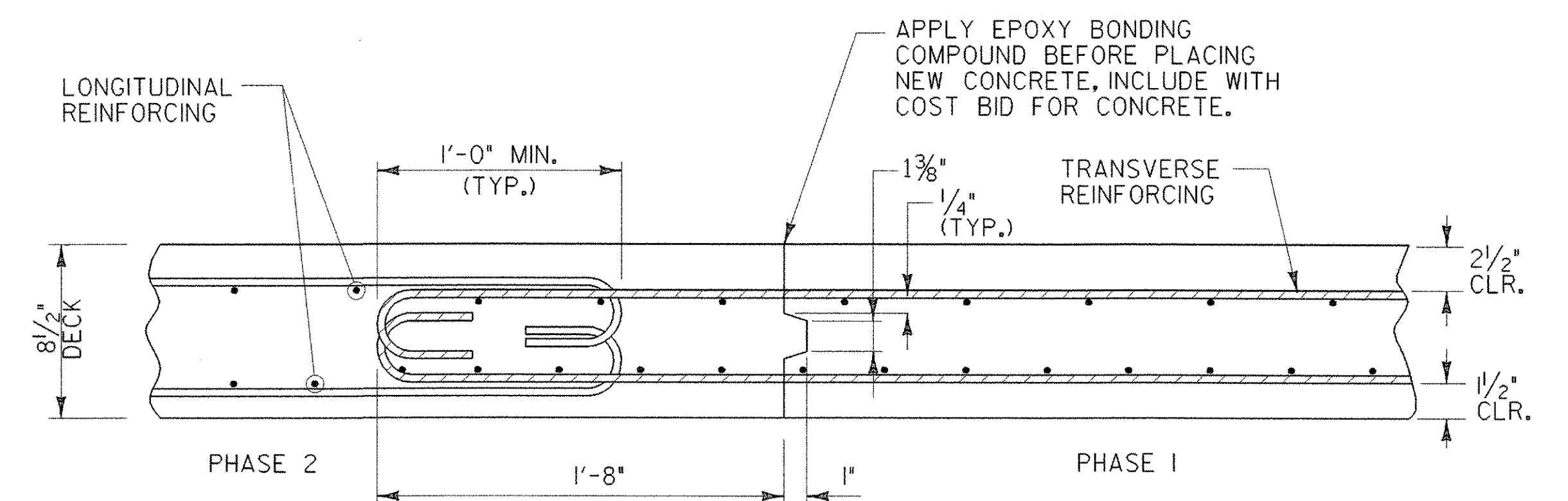

**LONGITUDINAL BRIDGE SLAB CONSTRUCTION JOINT DETAIL WITH HOOKED REINFORCING**

SPAN NO. 2 - 5 CONSTRUCTION JOINT SIMILAR  
N.T.S.

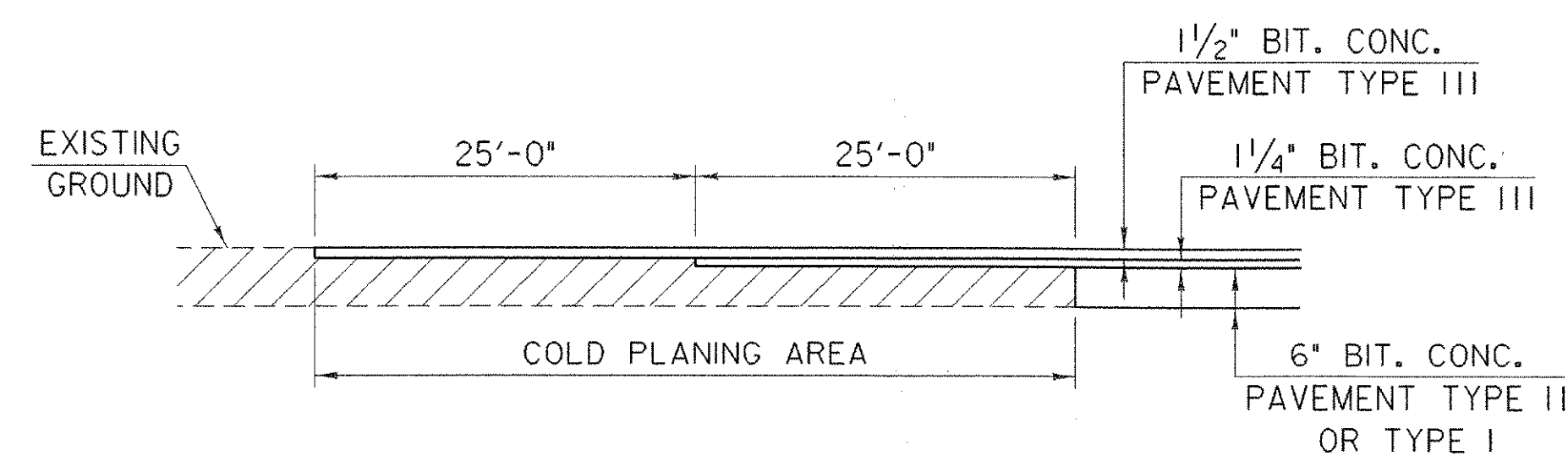

**COLD PLANING DETAIL**

N.T.S.

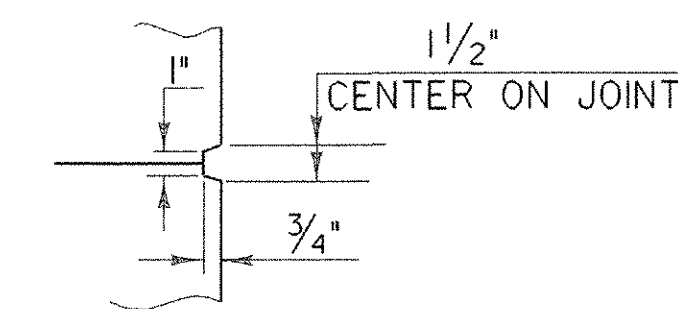

**SCORE MARK DETAIL**

N.T.S.

**STATE OF VERMONT AGENCY OF TRANSPORTATION**

Town Of	CAMBRIDGE	Bridge No.	20
Highway No.	VT 15	Log Sta.	
		Surv. Sta.	
<b>VT 15 OVER LAMOILLE RIVER</b>			
<b>MISCELLANEOUS PROJECT DETAILS</b>			
Designed By	E.A. HARTWELL	Drawn By	R.A. ROSS
Checked By	R. SACCHI	Bridge Design Supervisor	R. R. WHITCOMB
		Date	11/3/2006
PROJECT	CAMBRIDGE	PROJECT NO.	BHF 030-2(19)S
I.G.C. Info.			zb308ap3.dgn
Bridge Sheet No.		Sheet	44 of 68