

FINISH PRODUCTS DRAWN ON ALTERNATE CHANNEL SECTIONS ARE DRAWN ACCORDING TO REVISED GRADES (SEE WO #2 DATED 6-8-09) FOR USE IN DETERMINING STRUCTURE EXCAVATION AND GRANULAR BACKFILL QUANTITIES
CJJ 12-3-09

RIGHT
GRAN. BKFL. FOR STR. (SM) = 5.211
STRUCTURE EXC. (SM) = 5.158
CJJ 12-3-09
CJJ 12-3-09

FAR RIGHT
GRAN. BKFL. FOR STR. (SM) = 4.827
STRUCTURE EXC. (SM) = 0.724
CJJ 12-3-09
CJJ 12-3-09

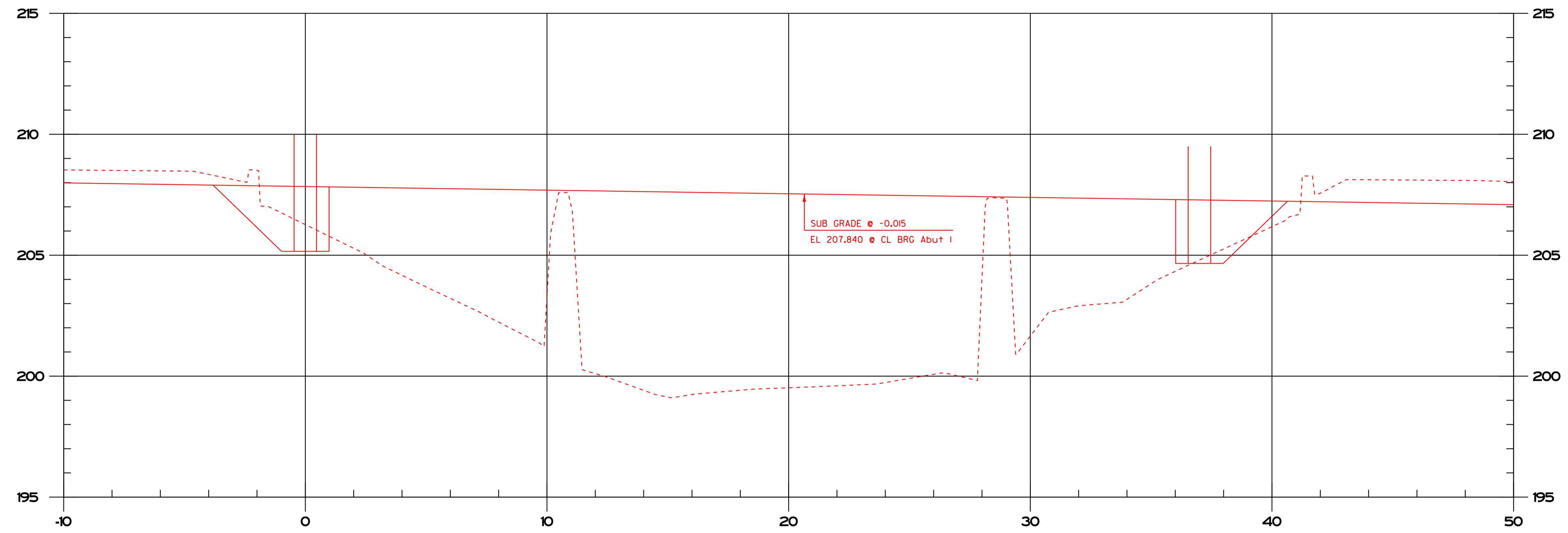

7+034 @ 15 deg skew

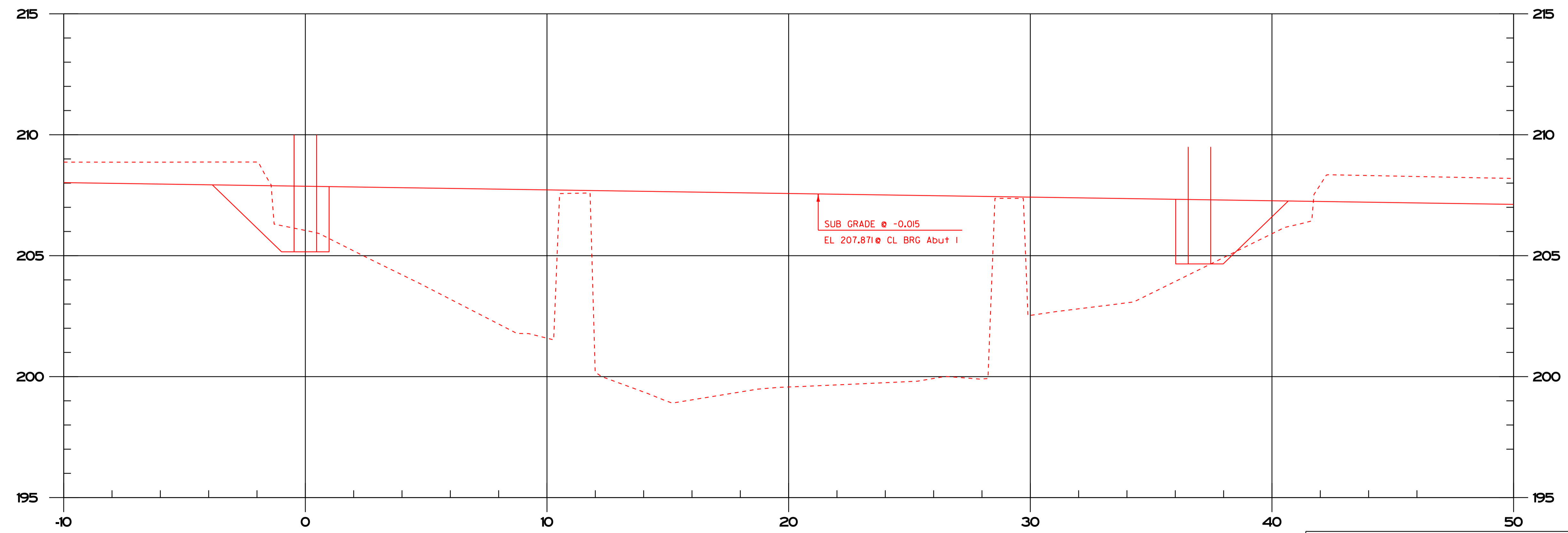

7+032 @ 15 deg skew

RIGHT
GRAN. BKFL. FOR STR. (SM) = 5.316
STRUCTURE EXC. (SM) = 5.016
CJJ 12-3-09
CJJ 12-3-09

FAR RIGHT
GRAN. BKFL. FOR STR. (SM) = 4.926
STRUCTURE EXC. (SM) = 0.133
CJJ 12-3-09
CJJ 12-3-09



PROJECT:	EAST MONPELIER	PROJECT NO.:	BRE 028-3(36)
DESIGN FILE NAME:	Z98b254/stc/sb254xs.dgn	PLOT DATE:	21-MAY-2012 16:04
IPARM FILE NAME:	sb254x15.i	DRAWN BY:	B.PELLEII
DESIGNED BY:	J.LACROIX	CHECKED BY:	J.LACROIX
SQUAD LEADER:	K.HIGGINS	SHEET: \$S*\$ OF \$T*\$	
CHANNEL CROSS SECTIONS #4	7-31-09 jts		