

FINISH PRODUCTS DRAWN ON ALTERNATE CHANNEL SECTIONS ARE DRAWN ACCORDING TO REVISED GRADES (SEE WO #2 DATED 6-8-09) FOR USE IN DETERMINING STRUCTURE EXCAVATION AND GRANULAR BACKFILL QUANTITIES  
CJJ 12-3-09

RIGHT  
GRAN. BKFL. FOR STR. (SM) = 5.108      CJJ 12-3-09  
STRUCTURE EXC. (SM) = 8.021              CJJ 12-3-09

FAR RIGHT  
GRAN. BKFL. FOR STR. (SM) = 4.729      CJJ 12-3-09  
STRUCTURE EXC. (SM) = 0                      CJJ 12-3-09

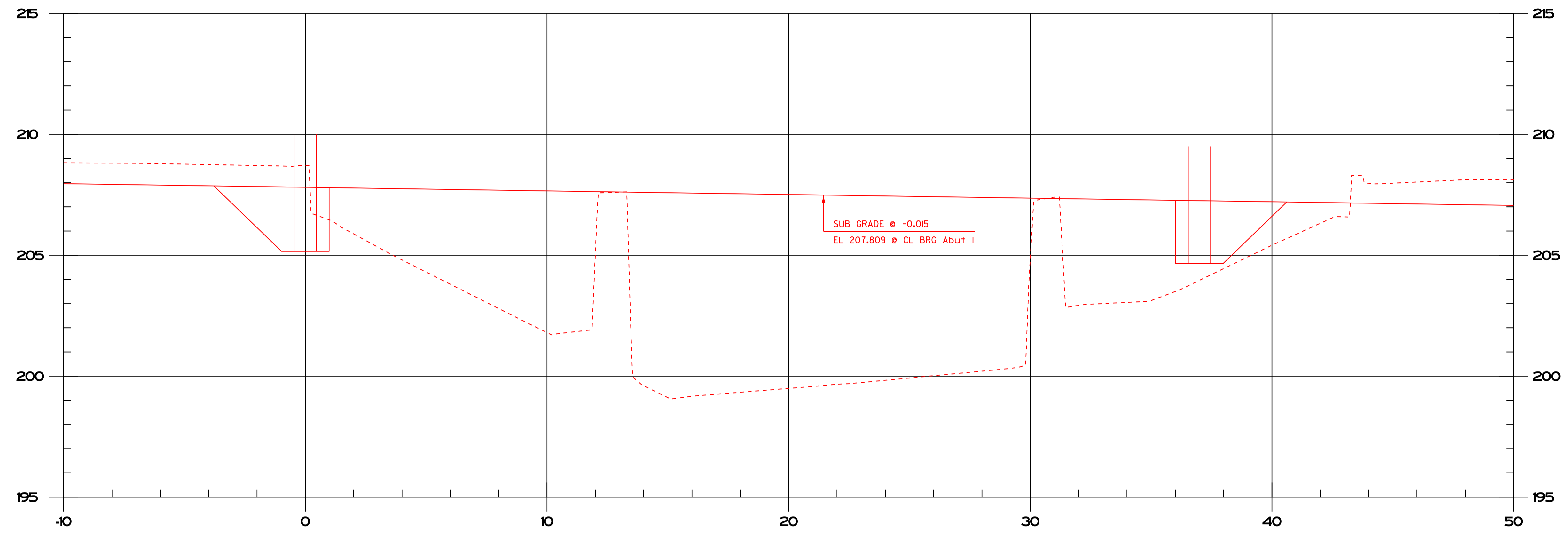

7+026 @ 15 deg skew

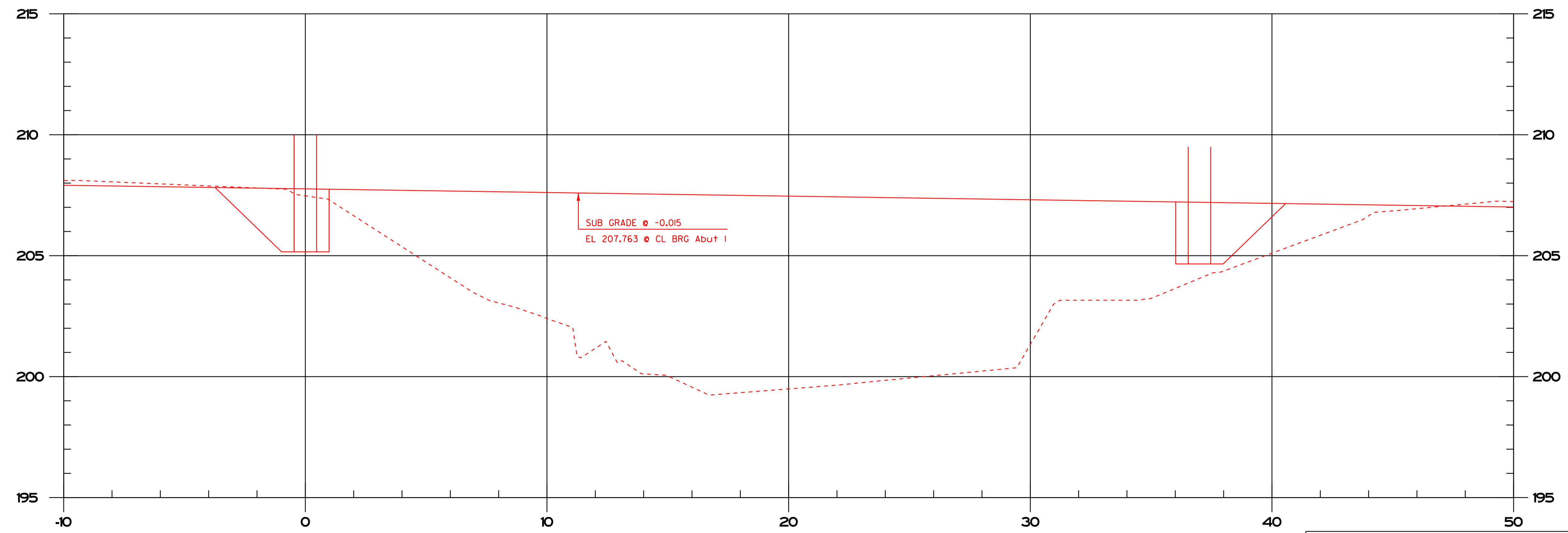

7+024 @ 15 deg skew

RIGHT  
GRAN. BKFL. FOR STR. (SM) = 4.956      CJJ 12-3-09  
STRUCTURE EXC. (SM) = 8.206              CJJ 12-3-09

FAR RIGHT  
GRAN. BKFL. FOR STR. (SM) = 4.585      CJJ 12-3-09  
STRUCTURE EXC. (SM) = 0                      CJJ 12-3-09

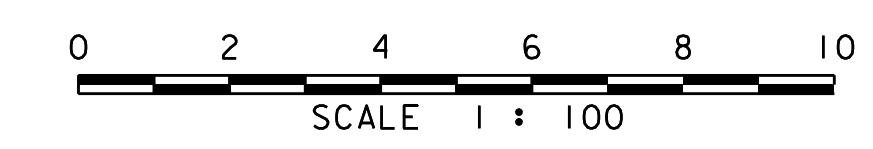

PROJECT: <b>EAST MONPELIER</b>	PROJECT NO. : <b>BRE_028-3(36)</b>
DESIGN FILE NAME: z98b254/stc/sb254xs.dgn	PLOT DATE: 21-MAY-2012 16:44
IPARM FILE NAME: sb254x15.i	DRAWN BY: B.PELLEII
DESIGNED BY: J.LACROIX	CHECKED BY: J.LACROIX
SQUAD LEADER: K.HIGGINS	SHEET: \$S*\$ OF \$T*\$
CHANNEL CROSS SECTIONS #4	