

FINISH PRODUCTS DRAWN ON ALTERNATE CHANNEL SECTIONS ARE DRAWN
 ACCORDING TO REVISED GRADES (SEE WO #2 DATED 6-8-09) FOR USE IN
 DETERMINING STRUCTURE EXCAVATION AND GRANULAR BACKFILL QUANTITIES
 CJJ 12-3-09

RIGHT
 GRAN. BKFL. FOR STR. (SM) = 4,804 CJJ 12-3-09
 STRUCTURE EXC. (SM) = 3,364 CJJ 12-3-09

FAR RIGHT
 GRAN. BKFL. FOR STR. = 4,440 CJJ 12-3-09
 STRUCTURE EXC. (SM) = 0 CJJ 12-3-09

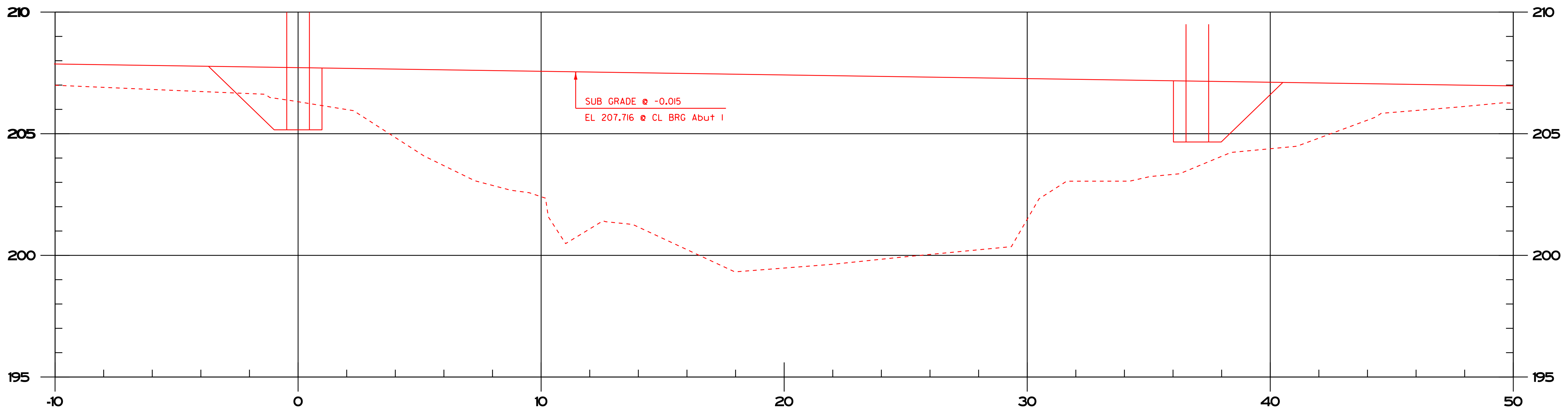

7+022 @ 15 deg skew

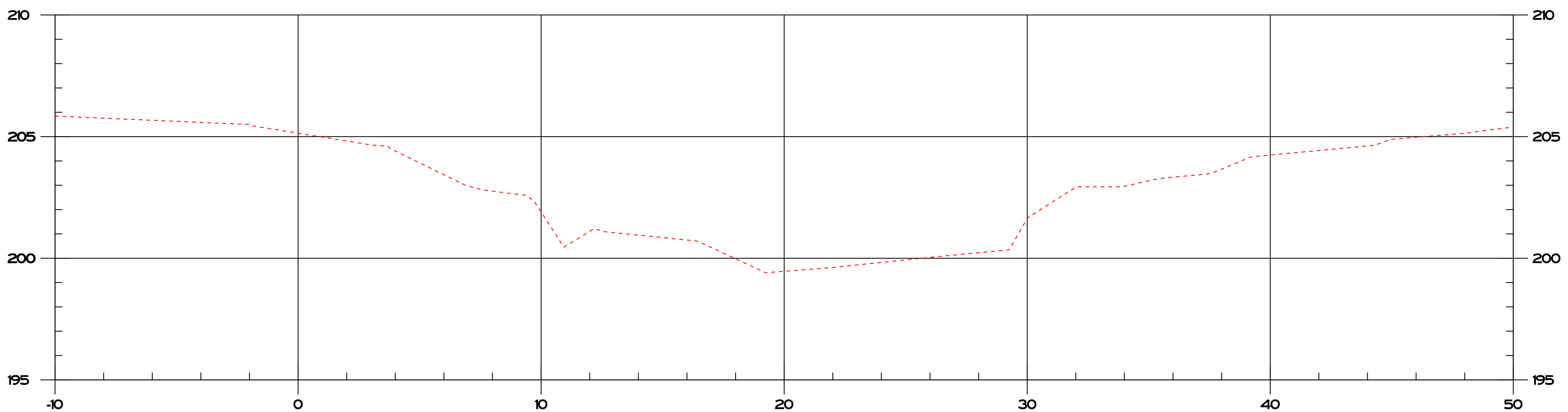

7+020 @ 15 deg skew



PROJECT: EAST MONPELIER	PROJECT NO. : BRE_Q28-3(36)
DESIGN FILE NAME: z98b254\stc\sb254xs.dgn	PLOT DATE: 21-MAY-2012 16:...
IPARM FILE NAME: sb254x15.i	DRAWN BY: B.PELLEII
DESIGNED BY: C.JOLLY	CHECKED BY: J.LACROIX
SQUAD LEADER: C.JOLLY	SHEET:\$S*\$ OF \$T*\$
CHANNEL CROSS SECTIONS *4	