

CONSTRUCT DRIVE

STATION	TYPE	WIDTH @ ROW
123+39 RT	GRAV. W/ 5' PAVED APRON	16'
124+50 RT	GRAV. W/ 5' PAVED APRON	15'
124+58 LT	GRAV. W/ 5' PAVED APRON	16'
125+62 LT	GRAV. W/ 5' PAVED APRON	12'
126+48 RT	PAVED	28'

616.28 - CAST-IN-PLACE CONCRETE CURB, TYPE B
 STA 124+64.5 - 125+51.8 LT
 STA 125+69.6 - 126+75 LT

617.10 - RELOCATE MAILBOX, SINGLE SUPPORT
 STA 126+59 RT

620.50 - REMOVING AND RESETTING FENCE
 STA 126+67 - 126+75 LT

VT 14 CURVE #1 DATA
 Delta = 14°24'00.00"
 D = 4°30'00.00"
 R = 1273.24'
 T = 160.85'
 L = 320.00'
 E = 10.12'
 BANKING = -0.021

BEGIN R.O.W. PROJECT
EAST MONTPELIER BR# 037-1(7)
STA. VT RT14 122+65.00, 24.75' LT

VT ROUTE 14 STA 124+50
 END APPROACH
 BEGIN PROJECT

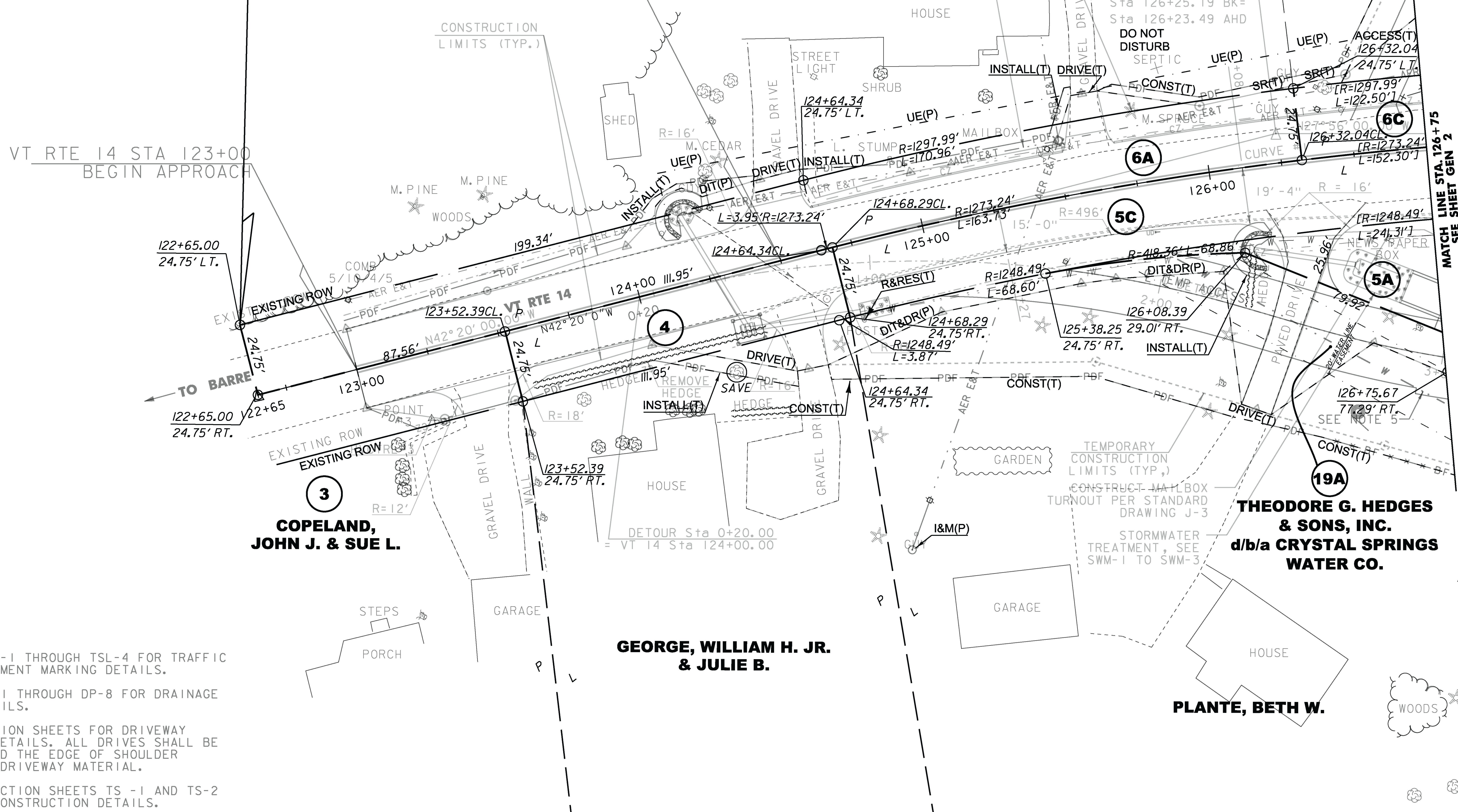

NOTES:

- SEE SHEETS TSL-1 THROUGH TSL-4 FOR TRAFFIC SIGNS AND PAVEMENT MARKING DETAILS.
- SEE SHEETS DP-1 THROUGH DP-8 FOR DRAINAGE PLANS AND DETAILS.
- SEE CROSS-SECTION SHEETS FOR DRIVEWAY CONSTRUCTION DETAILS. ALL DRIVES SHALL BE PAVED 5' BEYOND THE EDGE OF SHOULDER REGARDLESS OF DRIVEWAY MATERIAL.
- SEE TYPICAL SECTION SHEETS TS -1 AND TS-2 FOR APPROACH CONSTRUCTION DETAILS.
- APPROXIMATE LOCATION OF RELOCATED WATER LINE. WATER LINE SHOWN FOR REFERENCE ONLY AND IS NOT PART OF THIS CONTRACT.

LINES SHOWN ON THIS PLAN AS EXISTING PROPERTY LINES P/L ARE BELIEVED TO BE ACCURATE BUT SHOULD NOT BE RELIED UPON FOR PURPOSES UNRELATED TO THE STATE OF VERMONT'S ACQUISITION OF LAND AND RIGHTS FOR THIS PROJECT.

THIS PROJECT SUBJECT TO STORMWATER PERMIT #4251-INDS.R

FOR R.O.W. USE ONLY

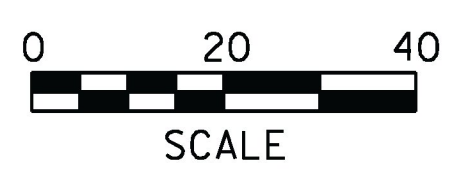

PROJECT NAME:	EAST MONTPELIER
PROJECT NUMBER:	BR# 037-1(7)
FILE NAME:	r98b252_lay1.dgn
PROJECT LEADER:	M. SARGENT
DESIGNED BY:	STANTEC
ROW LAYOUT SHEET	10F 4
PLOT DATE:	15-MAY-2015
DRAWN BY:	T. POLK
CHECKED BY:	R. CLOUTIER
SHEET	144 OF 158