

**PRECAST CONCRETE DECK PANEL LAYOUT**  
SCALE: 1/8" = 1'-0"

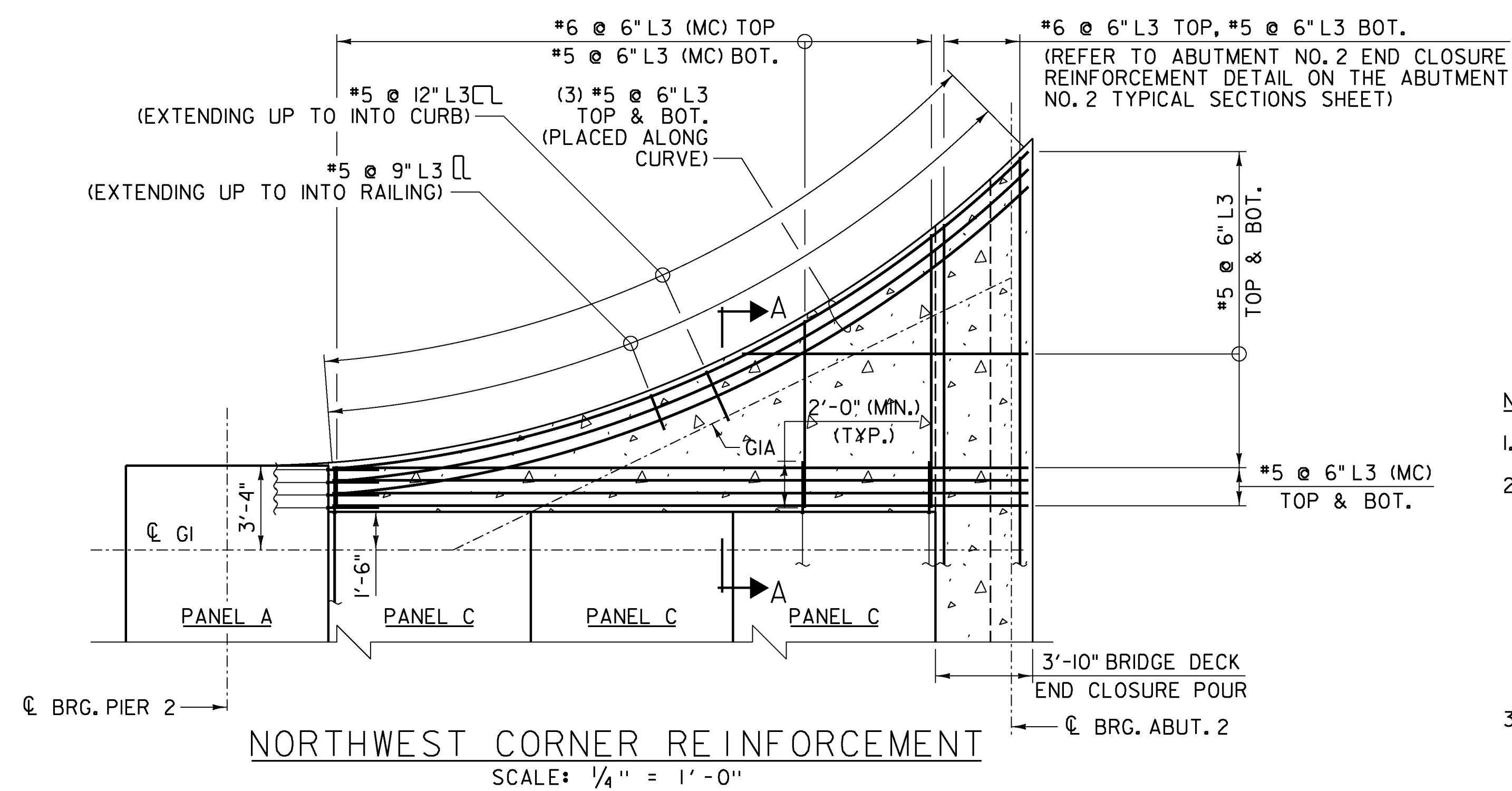

**NORTHWEST CORNER REINFORCEMENT**  
SCALE: 1/4" = 1'-0"

**NOTES:**

1. SHEAR CONNECTOR BLOCKOUTS NOT SHOWN FOR CLARITY.
2. THE CONTRACTOR SHALL DEVELOP A DETAILED REINFORCING STEEL BAR LIST, BENDING SCHEDULE AND PLACEMENT DRAWING FOR THE CAST-IN-PLACE PORTIONS OF THE BRIDGE DECK, BRIDGE CURB AND BRIDGE SIDEWALK. THESE DETAILS SHALL BE SUBMITTED FOR REVIEW AND APPROVAL IN CONJUNCTION WITH THE PRECAST DECK PANEL FABRICATION DRAWINGS. THE COST OF DETAILING, FURNISHING AND PLACING THIS REINFORCING STEEL SHALL BE CONSIDERED INCIDENTAL TO ITEM 900.670 SPECIAL PROVISION (PRECAST CONCRETE DECK PANEL) (8/2IN.).
3. FABRICATOR MAY SUBMIT ALTERNATE REINFORCEMENT DETAILS FOR APPROVAL.

**LEGEND:**

- (MC) = MECHANICAL CONNECTOR
- ▲ = CUT TO FIT IN FIELD
- CAST-IN-PLACE BRIDGE DECK CLOSURE POUR AND FLARED NORTHWEST CORNER OF BRIDGE DECK, ITEM 501.33 CONCRETE HIGH PERFORMANCE, CLASS A

|                 |                 |
|-----------------|-----------------|
| PROJECT NAME:   | EAST MONTPELIER |
| PROJECT NUMBER: | BRF 037-(17)    |
| FILE NAME:      | z98b252deck.dgn |
| PROJECT LEADER: | T. KNIGHT       |
| DESIGNED BY:    | T. KNIGHT       |
| DECK PLAN       |                 |
| PLOT DATE:      | 2/17/2017       |
| DRAWN BY:       | J. SOTER        |
| CHECKED BY:     | P. GREENBERG    |
| SHEET           | 75 OF 158       |

