

646.406 - DURABLE 4 INCH WHITE LINE,
RECESSED POLYUREA
STA 145+75 - 150+00 LT (EDGE LINE)
STA 145+75 - 147+00 LT (LANE LINE)
STA 145+75 - 150+00 RT (EDGE LINE)

646.416 - DURABLE 4 INCH YELLOW LINE,
RECESSED POLYUREA
STA 145+75 - 150+00 (DOUBLE CENTERLINE)
STA 147+00 - 149+85 (ISLAND MARKINGS)

646.494 - DURABLE LETTER OR SYMBOL,
POLYUREA
STA 146+02 LT - "S"
STA 146+49 LT - "M"
STA 146+96 LT - "S"
STA 150+38 LT - "SIGNAL"
STA 150+88 LT - "AHEAD"

675.20 - TRAFFIC SIGNS,
TYPE A
STA 147+00 LT
STA 150+63 LT

675.50 - REMOVING SIGNS
9 - AS SHOWN
675.60 - ERECTING
SALVAGED SIGNS
STA 147+88 LT

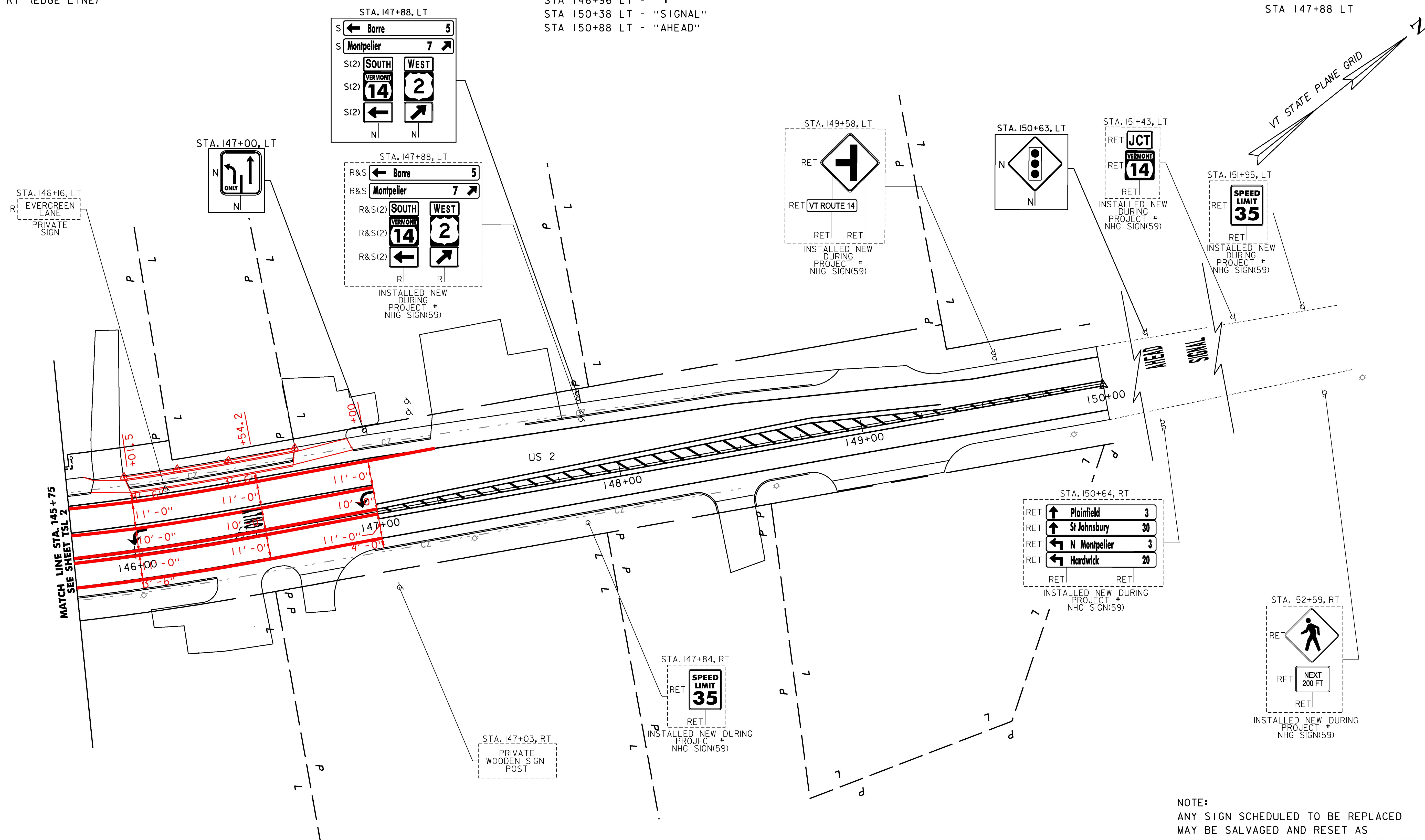

LEGEND	
N	- NEW
R	- REMOVE
R&S	- REMOVE & SALVAGE
RET	- RETAIN
S	- SALVAGE

NOTE:
ANY SIGN SCHEDULED TO BE REPLACED
MAY BE SALVAGED AND RESET AS
DETERMINED BY THE RESIDENT ENGINEER

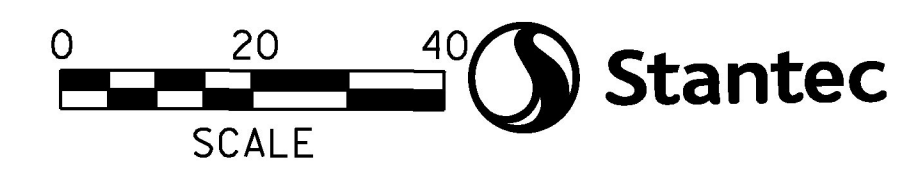

PROJECT NAME:	EAST MONTPELIER
PROJECT NUMBER:	BRF 037-(17)
FILE NAME: ... \21-Traffic Signs Lines.dgn	PLOT DATE: 7/28/2017
PROJECT LEADER: T. KNIGHT	DRAWN BY: G. BARRETT
DESIGNED BY: D. DRAPER	CHECKED BY: K. RICHARDSON
TRAFFIC SIGNS & LINES PLANS - TSL 4	SHEET 3 OF 6