

646.40 DURABLE 100 mm WHITE LINE
(ALL LINES WILL INCLUDE EDGE LINE BREAKS AND RADIUS FOR TOWN HIGHWAYS)

HANCOCK:
STA. I+180.0 - STA. I+720.0 LT & RT

646.60 TEMPORARY 100 mm WHITE LINE
(ALL LINES WILL INCLUDE EDGE LINE BREAKS AND RADIUS FOR TOWN HIGHWAYS)

HANCOCK:
STA. I+180.0 - STA. I+720.0 LT & RT

646.41 DURABLE 100 mm YELLOW LINE
(ALL LINES WILL INCLUDE C/L BREAKS FOR TOWN HIGHWAYS) S=SOLID, D=DASHED

HANCOCK:
STA. I+180.0 - STA. I+720.0 LT S C RT S
STA. I+512 DOUBLE SOLID RT, TH 23

646.61 TEMPORARY 100 mm YELLOW LINE
(ALL LINES WILL INCLUDE C/L BREAKS FOR TOWN HIGHWAYS) S=SOLID, D=DASHED

HANCOCK:
STA. I+180.0 - STA. I+720.0 LT S C RT S
STA. I+512 DOUBLE SOLID RT, TH 23

646.50 DURABLE LETTER OR SYMBOL

HANCOCK:
STA. I+452 RT, "S,C,H,O,O,L" (6 EA)
STA. I+512 RT, TH 23 "S,T,O,P" (4 EA)

646.70 TEMPORARY LETTER OR SYMBOL

HANCOCK:
STA. I+452 RT, "S,C,H,O,O,L" (6 EA)
STA. I+512 RT, TH 23 "S,T,O,P" (4 EA)

646.51 DURABLE CROSSWALK MARKINGS WITH DIAGONAL LINES (MOD.)

HANCOCK:
STA. I+674.0 (SEE SHEET 48 FOR DETAILS)

646.71 TEMPORARY CROSSWALK MARKINGS WITH DIAGONAL LINES

HANCOCK:
STA. I+674.0

646.46 DURABLE 600 mm STOP BAR

HANCOCK:
STA. I+512 RT, TH 23

646.66 TEMPORARY 600 mm STOP BAR

HANCOCK:
STA. I+512 RT, TH 23

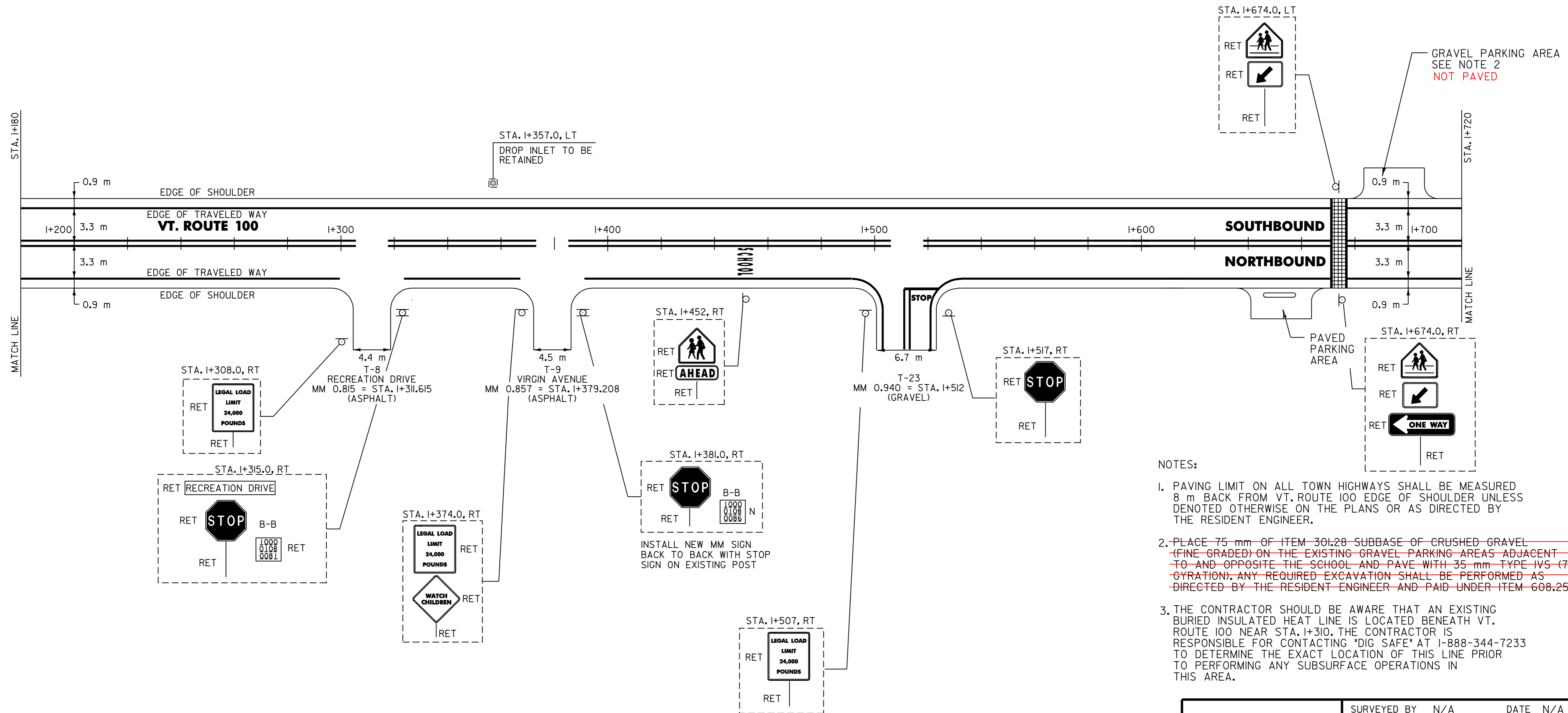

NOTES:

- PAVING LIMIT ON ALL TOWN HIGHWAYS SHALL BE MEASURED 8 m BACK FROM VT. ROUTE 100 EDGE OF SHOULDER UNLESS DENOTED OTHERWISE ON THE PLANS OR AS DIRECTED BY THE RESIDENT ENGINEER.
- ~~PLACE 75 mm OF ITEM 301.28 SUBBASE OF CRUSHED GRAVEL (FINE GRADED) ON THE EXISTING GRAVEL PARKING AREAS ADJACENT TO AND OPPOSITE THE SCHOOL AND PAVE WITH 35 mm TYPE IVS (75 GYRATION). ANY REQUIRED EXCAVATION SHALL BE PERFORMED AS DIRECTED BY THE RESIDENT ENGINEER AND PAID UNDER ITEM 608.25.~~
- THE CONTRACTOR SHOULD BE AWARE THAT AN EXISTING BURIED INSULATED HEAT LINE IS LOCATED BENEATH VT. ROUTE 100 NEAR STA. I+310. THE CONTRACTOR IS RESPONSIBLE FOR CONTACTING "DIG SAFE" AT 1-888-344-7233 TO DETERMINE THE EXACT LOCATION OF THIS LINE PRIOR TO PERFORMING ANY SUBSURFACE OPERATIONS IN THIS AREA.

SIGN LEGEND

- R= REMOVE
- S= SALVAGE
- N= NEW
- RET= RETAIN
- B-B= BACK TO BACK
- EXISTING=
- NEW=

PAVING PROJECT LAYOUT

SURVEYED BY	N/A	DATE	N/A
DRAWN BY	C.A.K.	DATE	11/00
SQUAD LEADER	T.P.K.		
DESIGN FILE NO.	/pave/98bl80/pbl80.dgn		
IPARM FILE	pbl80p10.i	DATE PLOTTED	21-DEC-2006 15
PROJ. NAME	ROCHESTER-GRANVILLE		
PROJ. NO.	AC_SIP_212411		
SHEET	18	OF	49
SHEETS			

DATUM	
VERTICAL	N/A
HORIZONTAL	N/A