

TEMPORARY AND DURABLE 100mm YELLOW LINE  
 STA. 8+580.0 TO STA. 9+092.8 SOLID LT. AND RT.  
 STA. 9+092.8 TO STA. 9+270.0 SOLID LT. AND DASHED RT.

TEMPORARY AND DURABLE 100mm WHITE LINE  
 STA. 8+580.0 TO STA. 9+270.0 SOLID LT. AND RT. (EDGE LINE)

TEMPORARY AND DURABLE LETTER OR SYMBOL  
 STA. 8+600.0 LT. - "SCHOOL"

REMOVING SIGNS  
 2 -- AS SHOWN

DURABLE 100mm WHITE LINE (POLYUREA)  
 STA. 8+550 TO STA. 9+270 +/- (EDGE LINE)

DURABLE 100mm WHITE LINE (THERMO-PLASTIC)  
 STA. 8+550 TO STA. 9+270 +/- (LT. & RT.)

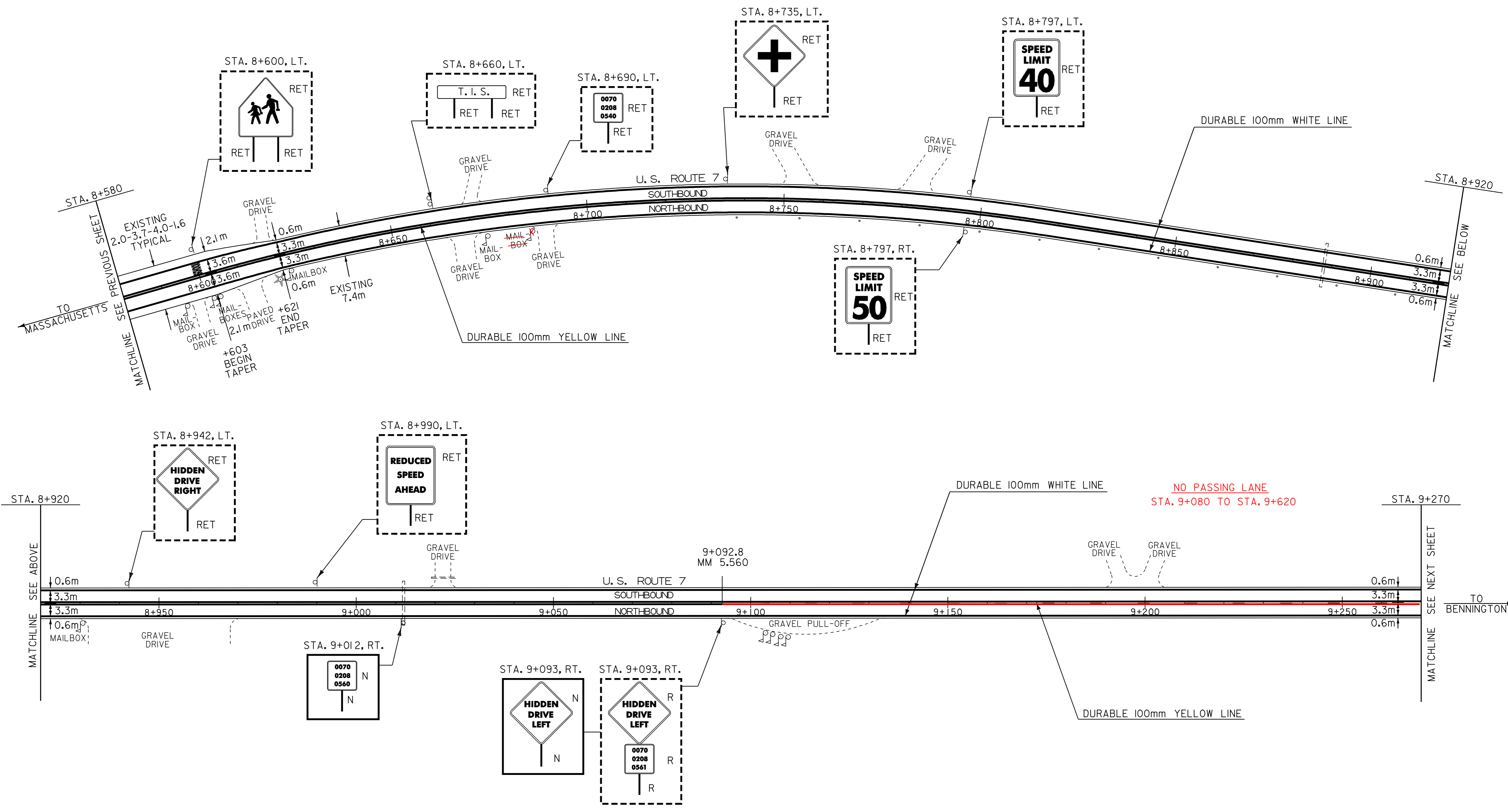

- LEGEND
- N = NEW
  - R = REMOVE
  - R & S = REMOVE AND SALVAGE
  - S = SALVAGE SIGN
  - RET = RETAIN
  - B - B = BACK TO BACK

<b>PAVING PROJECT LAYOUT #20</b>	PROJECT: POWNAL-BENNINGTON	PROJECT NO.: NH 2118(I)S
	DESIGN FILE NAME: /pave/98bl68/pbl68.dgn	PLOT DATE: 17-JAN-2006 14
	IPARM FILE NAME: pbl68l20.1	SURVEY DATE:
	SURVEYED BY: ACT, SJL, RAL	DRAWN BY: ACT
	SQUAD LEADER: JAV	SHEET: 28 OF 65

DATUM	
VERTICAL	N/A
HORIZONTAL	N/A