

TEMPORARY AND DURABLE 100mm YELLOW LINE

STA. 5+860.0 TO STA. 6+560.0 SOLID LT. AND RT.

TEMPORARY AND DURABLE 100mm WHITE LINE

STA. 5+860.0 TO STA. 6+560.0 SOLID LT. AND RT. (EDGE LINE)
STA. 6+413.2 TO STA. 6+560.0 DASHED RT. (PASSING LANE)

DURABLE 100mm YELLOW LINE (THERMOPLASTIC)

STA. 5+860 TO STA. 6+560+/- (LT. & RT.)

DURABLE 100mm WHITE LINE (POLUREA)

STA. 5+860 TO STA. 6+560+/- I

REMOVAL AND DISPOSAL OF GUARD RAIL

STA. 6+185.8 LT. TO STA. 6+197.0 LT.
STA. 6+386.0 LT. TO STA. 6+397.4 LT.
STA. 6+523.0 RT. TO STA. 6+534.4 RT.

REMOVAL AND DISPOSAL OF DELINEATORS

STA. 6+210 LT. TO STA. 6+378 LT.

REMOVAL OF EXISTING CURB

STA. 6+534 RT. TO STA. 6+560 RT.

SHOULDER BERM REMOVAL

STA. 5+860 LT. TO STA. 6+186 LT.
STA. 6+399 LT. TO STA. 6+560 LT.
STA. 6+534 RT. TO STA. 6+560 RT.

ANCHOR STEEL BEAM RAIL

STA. 6+506 RT.

BITUMINOUS CONCRETE CURB, TYPE B

STA. 6+534 RT. TO STA. 6+560 RT.

STEEL BEAM GUARD RAIL

STA. 6+185.8 LT. TO STA. 6+398.6 LT.
STA. 6+504.0 RT. TO STA. 6+534.4 RT.

300 mm CSP 1.7mm (67mm x 13mm)
STA. 6+500.0 RT. TO STA. 6+510.0 RT.

300 mm CSPES 1.7mm (67mm x 13mm)
STA. 6+500.0 RT.
STA. 6+510.0 RT.

REMOVING SIGNS

2 -- AS SHOWN

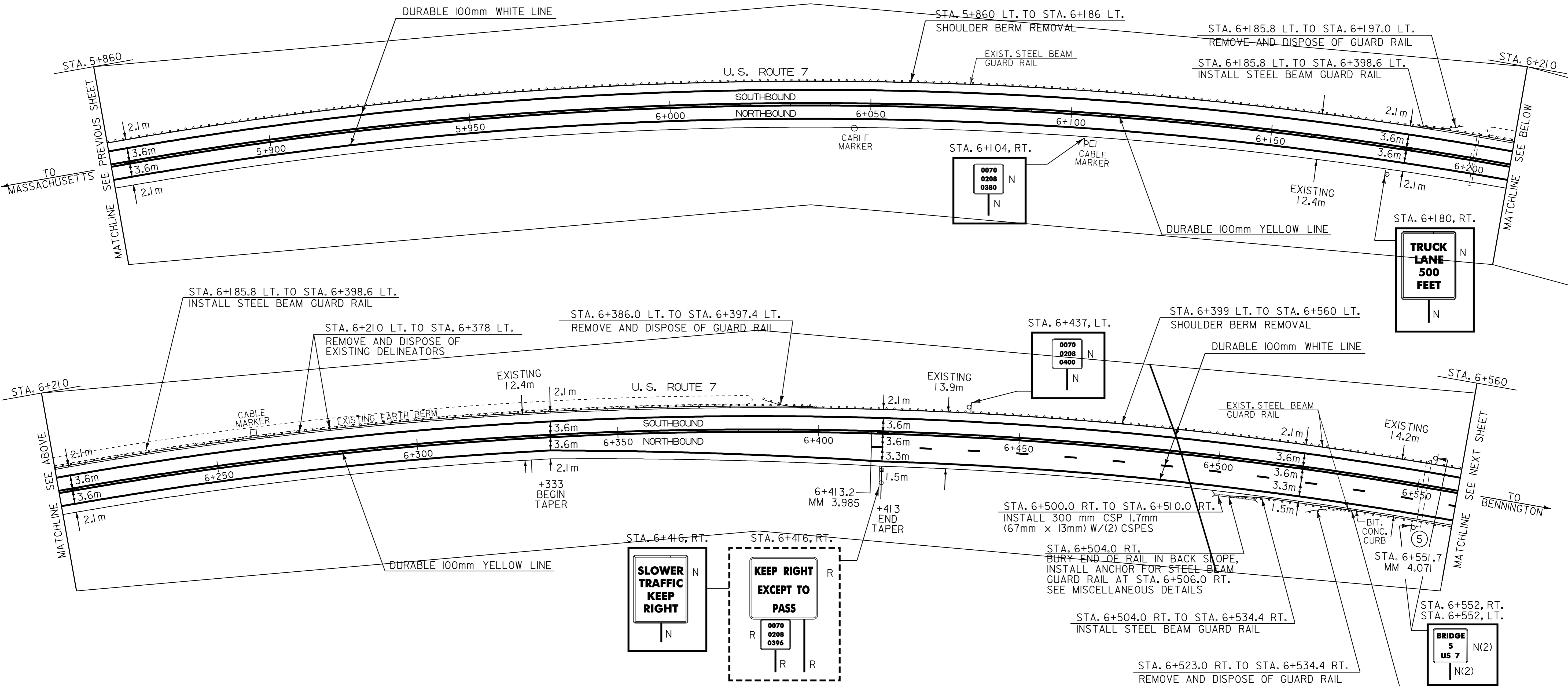

LEGEND
 N = NEW
 R = REMOVE
 R & S = REMOVE AND SALVAGE
 S = SALVAGE SIGN
 RET = RETAIN
 B - B = BACK TO BACK

DATUM	
VERTICAL	N/A
HORIZONTAL	N/A

PAVING PROJECT LAYOUT #14	PROJECT: POWNAL-BENNINGTON	PROJECT NO.: NH 2118(I)S
	DESIGN FILE NAME: /pave/98bl68/pbl68.dgn	PLOT DATE: 17-JAN-2006 14
	IPARM FILE NAME: pbl68i4.1	SURVEY DATE:
	SURVEYED BY: ACT, SJL, RAL	DRAWN BY: ACT
	SQUAD LEADER: JAV	SHEET: 22 OF 65