

TEMPORARY AND DURABLE 100 mm YELLOW LINE  
 STA 5+200 TO 5+900 SOLID LT & RT

TEMPORARY AND DURABLE 100 mm WHITE LINE  
 STA 5+200 TO 5+900 SOLID LT & RT

STEEL BEAM GUARDRAIL (2.4m POST)(MOD.)  
 STA ~~5+851.0 ~ 5+878.0~~ LT  
 5+862.43 ~ 5+877.67

~~ANCHOR FOR STEEL BEAM RAIL~~  
~~STA 5+851.0~~

300mm CSP 1.63mm (68mm x 12mm)  
 STA ~~5+882 TO 5+897~~ LT

MANUFACTURED TERMINAL SECTION (FLARED)  
 STA 5+877.67 ~ 5+889.10 LT  
 STA 5+851 ~ 5+862.43 LT

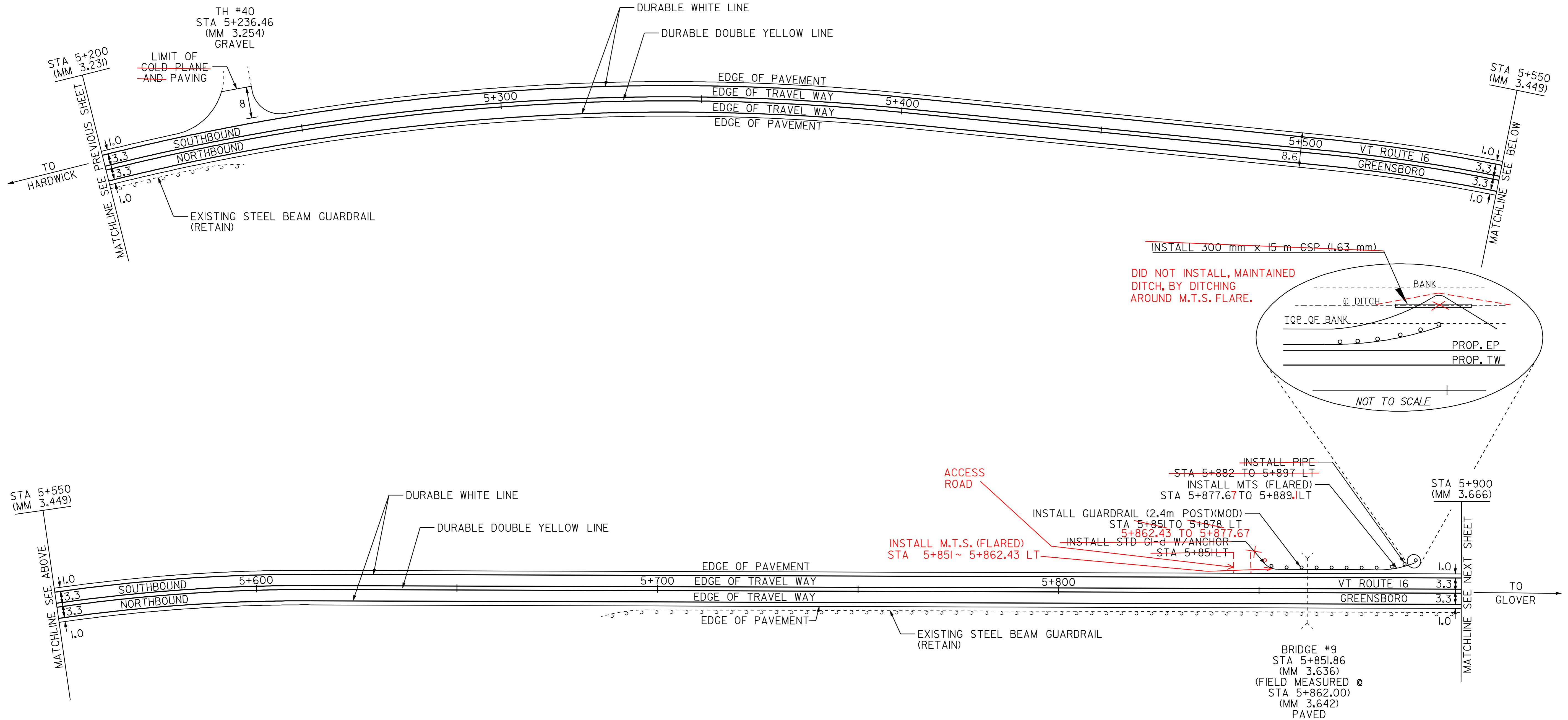

~~INSTALL 300 mm x 15 m CSP (1.63 mm)~~  
 DID NOT INSTALL, MAINTAINED  
 DITCH, BY DITCHING  
 AROUND M.T.S. FLARE.

ACCESS ROAD  
 INSTALL PIPE  
~~STA 5+882 TO 5+897 LT~~  
 INSTALL MTS (FLARED)  
 STA 5+877.67 TO 5+889.10 LT  
 INSTALL GUARDRAIL (2.4m POST)(MOD.)  
 STA 5+851 TO 5+878 LT  
 5+862.43 TO 5+877.67  
 INSTALL STD C-I-B W/ANCHOR  
 STA 5+851 LT  
 INSTALL M.T.S. (FLARED)  
 STA 5+851 ~ 5+862.43 LT

BRIDGE #9  
 STA 5+851.86  
 (MM 3.636)  
 (FIELD MEASURED @  
 STA 5+862.00)  
 (MM 3.642)  
 PAVED

STA	TOTAL DEPTH (MM)	PCC
13 STA 5+575 RT	140	NO

DATUM	
VERTICAL	N/A
HORIZONTAL	N/A

- LEGEND
- R = REMOVE EXISTING
  - S = SALVAGE
  - R&S = REMOVE AND SALVAGE
  - N = NEW
  - RET = RETAIN
  - B-B = BACK TO BACK
  - = NEW RAIL
  - - - = EXISTING RAIL
  - ⊗ = BORING LOCATION

NOTE: ALL DIMENSIONS IN METERS EXCEPT AS INDICATED

<b>PAVING PROJECT LAYOUT #22</b>	PROJECT: HARDWICK-GREENSBORO	PROJECT NO.: STP 2112(1)S
	DESIGN FILE NAME: pave/98b106/pbl06.dgn	PLOT DATE: 10-JUL-2006 13:50
	IPARM FILE NAME: pbl061a22.i	SURVEY DATE: 6/99
	SURVEYED BY: CLD_ENGINEERS, INC.	DRAWN BY: JPC
SQUAD LEADER: WRH	SHEET: 31 OF 43	

NOT TO SCALE