

TEMPORARY AND DURABLE 100 mm YELLOW LINE

STA 1+600 TO 2+044 SOLID LT & RT
 STA 2+050 DOUBLE SOLID RT (S.A. 4)
 STA 2+056 TO 2+250 SOLID LT & RT

TEMPORARY AND DURABLE 100 mm WHITE LINE

STA 1+600 TO 2+250 SOLID LT
 STA 1+600 TO 2+238 SOLID RT
 STA 2+062 TO 2+250 SOLID RT

~~TEMPORARY AND DURABLE 600 mm STOP BAR~~

STA 2+050 RT (S.A. 4)

~~TEMPORARY AND DURABLE LETTER OR SYMBOL~~

STA 2+050 RT - "STOP" (S.A. 4)

~~CHANGING ELEV. OF DI, CB OR MH-
 REHABILITATION OF DI, CB OR MH, CLASS I~~

STA 1+789 LT
 STA 2+056 LT
 STA 2+125 LT **NO WORK REQUIRED**
 STA 2+234 LT

REMOVING SIGNS
 AS SHOWN - 2

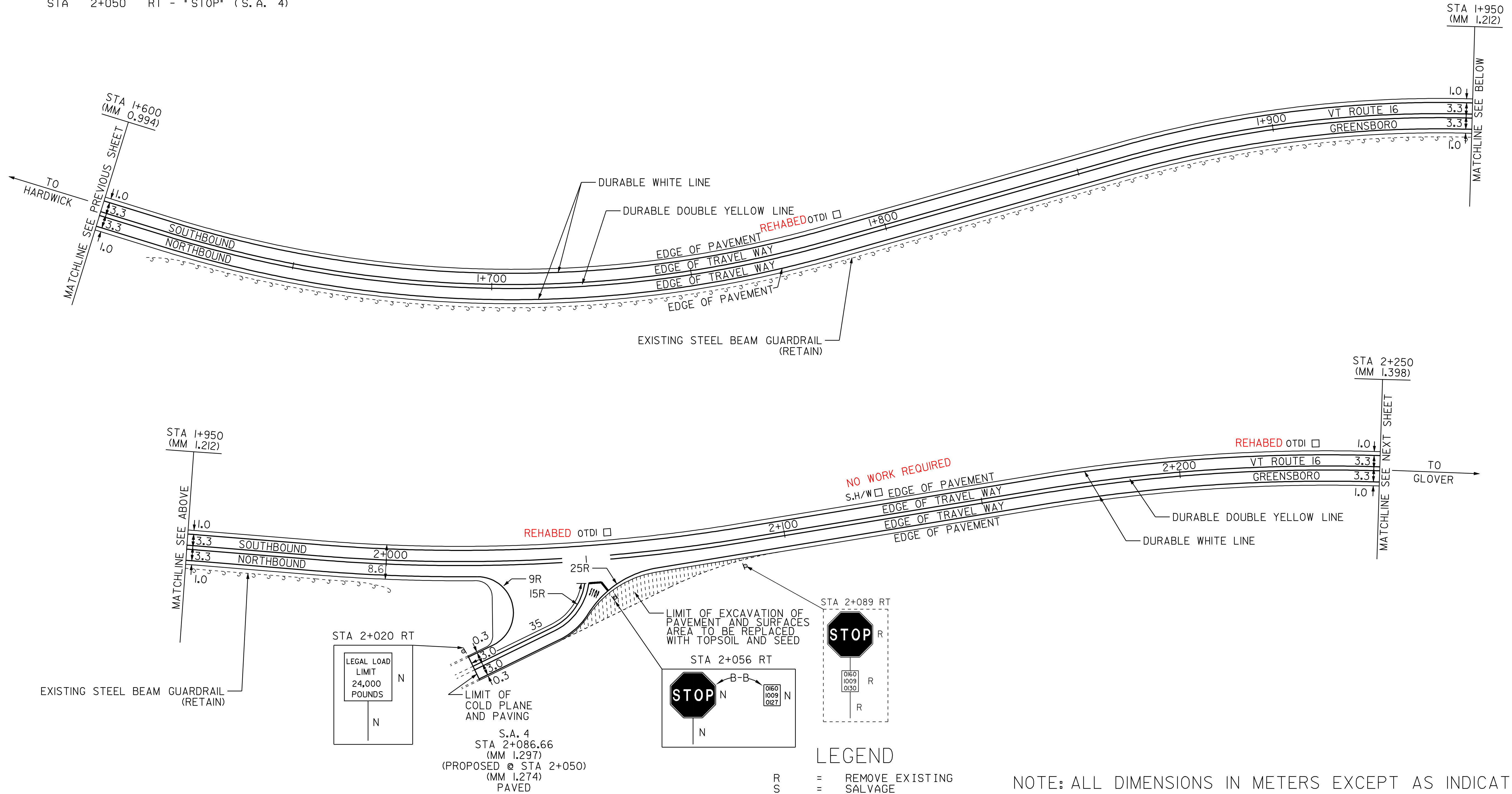

- LEGEND**
- R = REMOVE EXISTING
 - S = SALVAGE
 - R&S = REMOVE AND SALVAGE
 - N = NEW
 - RET = RETAIN
 - B-B = BACK TO BACK
 - - - = NEW RAIL
 - · - · = EXISTING RAIL
 - ⊗ = BORING LOCATION

NOTE: ALL DIMENSIONS IN METERS EXCEPT AS INDICATED

DATUM	
VERTICAL	N/A
HORIZONTAL	N/A

NOT TO SCALE

PAVING PROJECT LAYOUT #15	PROJECT: HARDWICK-GREENSBORO	PROJECT NO.: STP 2112(1)S
	DESIGN FILE NAME: pave/98b106/pb106.dgn	PLOT DATE: 10-JUL-2006 13:50
	IPARM FILE NAME: pb1061a15.1	SURVEY DATE: 6/99
	SURVEYED BY: CLD ENGINEERS, INC.	DRAWN BY: JPC
	SQUAD LEADER: WRH	SHEET: 24 OF 43