

646.40 DURABLE 100 mm WHITE LINE (THERMOPLASTIC)  
 (ALL LINES WILL INCLUDE EDGE LINE BREAKS AND RADIUS FOR TOWN HIGHWAYS)  
 WALLINGFORD:  
 STA. 8+560.0 - STA. 8+730.0 LT & RT

646.60 TEMPORARY 100 mm WHITE LINE (PAINT)  
 (ALL LINES WILL INCLUDE EDGE LINE BREAKS AND RADIUS FOR TOWN HIGHWAYS)  
 WALLINGFORD:  
 STA. 8+560.0 - STA. 8+730.0 LT & RT

646.42 DURABLE 200 mm WHITE LINE (THERMOPLASTIC)  
 WALLINGFORD:  
 STA. 8+627.2 - STA. 8+630.8 RT, SHOULDER HATCHING (11.1 m)

646.50 DURABLE LETTER OR SYMBOL (THERMOPLASTIC)  
 WALLINGFORD:  
 STA. 8+581.022 LT, T-56 "S,T,O,P" (4 EA)

675.50 REMOVING SIGNS  
 AS SHOWN - 24 35  
 675.60 ERECTING SALVAGED SIGNS  
 AS SHOWN - 2 13

**CURVE 1**  
 P.C.=STA. 8+535.404  
 P.T.=STA. 8+634.894  
 $\Delta=9^{\circ}30'02''$   
 R=600.000 m  
 T=49.859 m  
 L=99.490 m  
 E=2.068 m  
 $e_{max}=N/A$

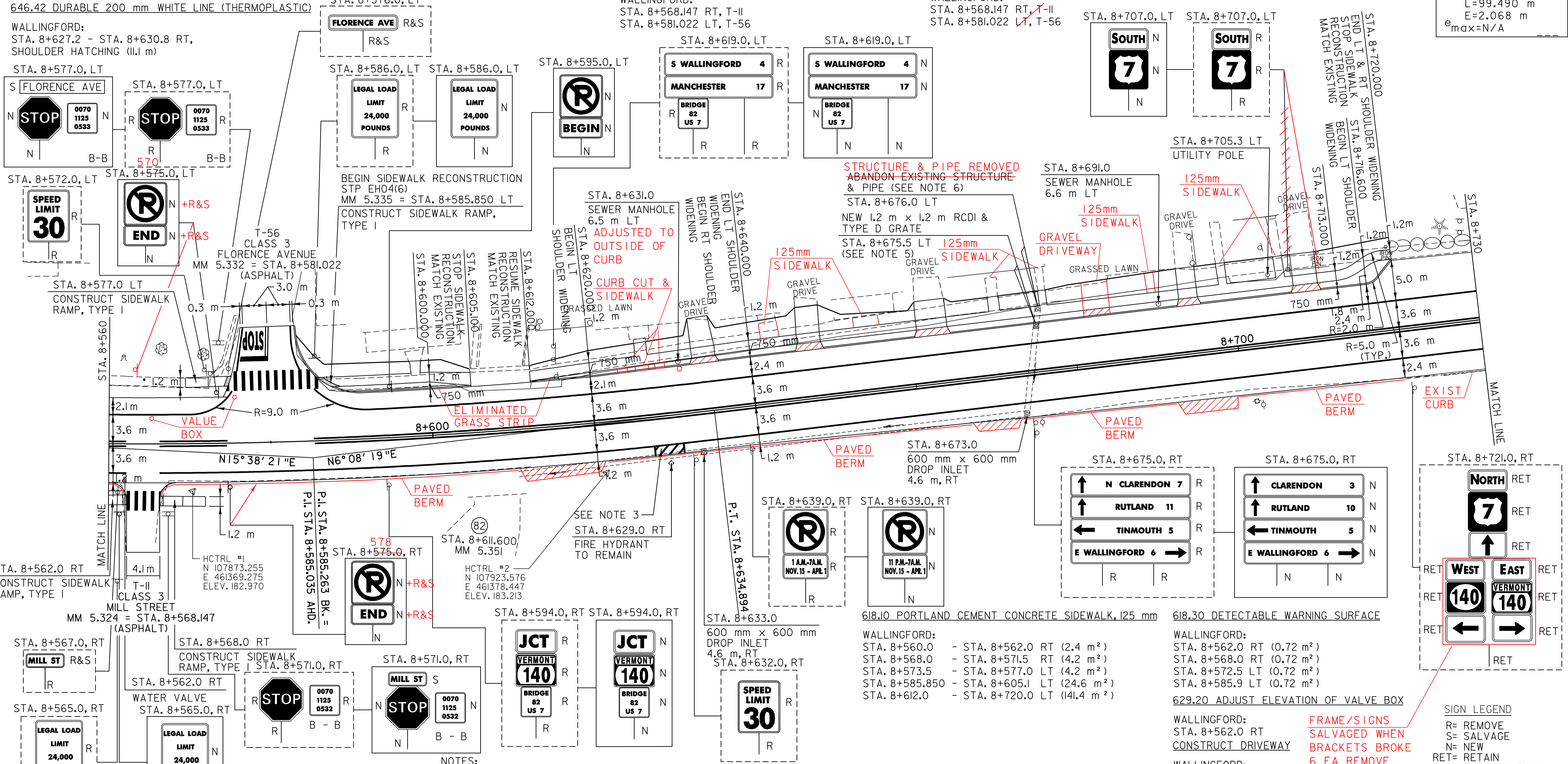

604.43 REHABILITATION OF SEWER MANHOLE  
 WALLINGFORD:  
 STA. 8+631.0 LT  
 STA. 8+691.0 LT

- NOTES:
- PAVING LIMIT ON ALL TOWN HIGHWAYS SHALL BE MEASURED 8 m BACK FROM U.S. ROUTE 7 EDGE OF SHOULDER UNLESS DENOTED OTHERWISE ON THE PLANS OR AS DIRECTED BY THE RESIDENT ENGINEER.
  - THE CONTRACTOR SHOULD BE AWARE THAT EXISTING BURIED UTILITIES (SUCH AS PHONE CABLE, FIBER OPTIC CABLE, SEWER LINES, ETC.) ARE LOCATED ADJACENT TO U.S. ROUTE 7 WITHIN THE PROJECT LIMITS THE CONTRACTOR IS RESPONSIBLE FOR CONTACTING "DIG SAFE" AT 1-888-344-7233 TO DETERMINE THE EXACT LOCATIONS OF THESE UTILITIES PRIOR TO INSTALLING GUARDRAIL, CLEANING DITCHES OR PERFORMING ANY OTHER OPERATIONS THAT MAY DISTURB THE EXISTING SUBSURFACE CONDITIONS.
  - SEE SHEET 86 OF 110 FOR HYDRANT PAVEMENT MARKING DETAIL.
  - THE CONTRACTOR SHALL PROTECT AND MAINTAIN ALL EXISTING LANDSCAPING AND FENCING LOCATED WITHIN THE PROJECT LIMITS AS DIRECTED BY THE RESIDENT ENGINEER. THE CONTRACTOR SHALL REPAIR OR REPLACE ANY DAMAGED ITEMS LOCATED BEYOND THE EARTHWORK LIMITS DEPICTED IN THE PLANS AT HIS/HER OWN COST AS DIRECTED BY THE RESIDENT ENGINEER.
  - THE PROPOSED DRAINAGE STRUCTURE SHALL BE INSTALLED IN LINE WITH THE EXISTING PIPE AS DIRECTED BY THE RESIDENT ENGINEER. THE CONTRACTOR SHALL FIELD VERIFY THE EXISTING PIPE DEPTH PRIOR TO ORDERING THE NEW DRAINAGE STRUCTURE.
  - THE EXISTING STRUCTURE AND REMAINING PIPE STUB SHALL BE **REMOVED** AS DIRECTED BY THE RESIDENT ENGINEER. SEE SHEET 85 OF 110 FOR ABANDONING DRAINAGE STRUCTURES DETAIL.

629.20 ADJUST ELEVATION OF VALVE BOX  
 WALLINGFORD:  
 STA. 8+562.0 RT  
 CONSTRUCT DRIVEWAY

604.42 REHABING DI, CB OR MH, CLASS 1  
 WALLINGFORD:  
 STA. 8+633.0 RT  
 STA. 8+673.0 RT

DATUM  
 VERTICAL NAVD\_88  
 HORIZONTAL NAD\_83\_(1996)

616.28 CAST-IN-PLACE CONCRETE CURB, TYPE B  
 WALLINGFORD:  
 STA. 8+583.3 - STA. 8+586.0 LT (6.0 m)  
 STA. 8+587.8 - STA. 8+605.1 LT (17.0 m)  
 STA. 8+612.0 - STA. 8+632.5 LT (20.5 m)  
 STA. 8+636.6 - STA. 8+645.6 LT (9.0 m)  
 STA. 8+649.1 - STA. 8+660.5 LT (11.4 m)  
 STA. 8+664.9 - STA. 8+693.1 LT (28.2 m)  
 STA. 8+696.0 - STA. 8+707.3 LT (11.3 m)  
 STA. 8+710.9 - STA. 8+720.0 LT (9.1 m)

618.10 PORTLAND CEMENT CONCRETE SIDEWALK, 125 mm  
 WALLINGFORD:  
 STA. 8+560.0 - STA. 8+562.0 RT (2.4 m<sup>2</sup>)  
 STA. 8+568.0 - STA. 8+571.5 RT (4.2 m<sup>2</sup>)  
 STA. 8+573.5 - STA. 8+577.0 LT (4.2 m<sup>2</sup>)  
 STA. 8+585.850 - STA. 8+605.1 LT (24.6 m<sup>2</sup>)  
 STA. 8+612.0 - STA. 8+720.0 LT (141.4 m<sup>2</sup>)

618.30 DETECTABLE WARNING SURFACE  
 WALLINGFORD:  
 STA. 8+562.0 RT (0.72 m<sup>2</sup>)  
 STA. 8+568.0 RT (0.72 m<sup>2</sup>)  
 STA. 8+572.5 LT (0.72 m<sup>2</sup>)  
 STA. 8+585.9 LT (0.72 m<sup>2</sup>)

**PAVING PROJECT LAYOUT # 26**

SURVEYED BY L.R.S.C. DATE 10/04  
 DRAWN BY C.A.K. DATE 8/05  
 SQUAD LEADER D.E.G.  
 DESIGN FILE NO. pave\98b098\pb098.dgn  
 IPARM FILE pb098\26.1 DATE PLOTTED 08-JUL-2007 15  
 PROJ. NAME WALLINGFORD  
 PROJ. NO. NH\_2108(1)S\_&\_SIP\_EH04(6)  
 SHEET 46 OF 110 SHEETS



**SIGN LEGEND**  
 R= REMOVE  
 S= SALVAGE  
 N= NEW  
 RET= RETAIN  
 B-B= BACK TO BACK  
 EXISTING= ---  
 NEW= ---  
 ⊕ = SIGN TO BE RETURNED TO THE TOWN OF WALLINGFORD