

646.40 DURABLE 100 mm WHITE LINE (THERMOPLASTIC)
(ALL LINES WILL INCLUDE EDGE LINE BREAKS AND RADIUS FOR TOWN HIGHWAYS)
WALLINGFORD:
STA. 5+200.0 - STA. 5+560.0 LT & RT

646.60 TEMPORARY 100 mm WHITE LINE (PAINT)
(ALL LINES WILL INCLUDE EDGE LINE BREAKS AND RADIUS FOR TOWN HIGHWAYS)
WALLINGFORD:
STA. 5+200.0 - STA. 5+560.0 LT & RT

646.41 DURABLE 100 mm YELLOW LINE (THERMOPLASTIC)
(ALL LINES WILL INCLUDE C/L BREAKS FOR TOWN HIGHWAYS) S=SOLID, D=DASHED
WALLINGFORD:
STA. 5+200.0 - STA. 5+560.0 LT S C RT S

646.61 TEMPORARY 100 mm YELLOW LINE (PAINT)
(ALL LINES WILL INCLUDE C/L BREAKS FOR TOWN HIGHWAYS) S=SOLID, D=DASHED
WALLINGFORD:
STA. 5+200.0 - STA. 5+560.0 LT S C RT S

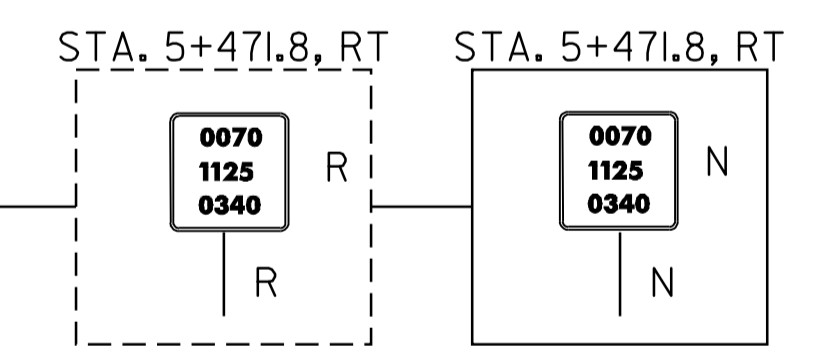
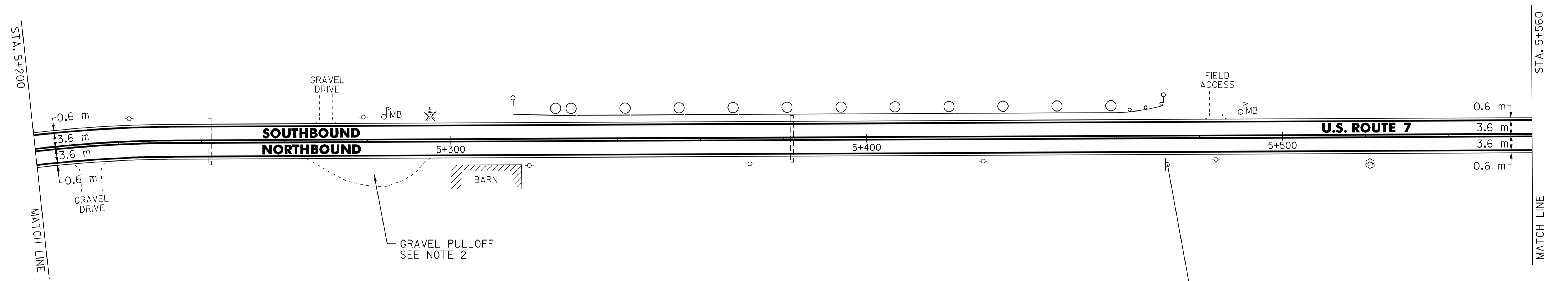

- NOTES:
1. THE CONTRACTOR SHOULD BE AWARE THAT EXISTING BURIED UTILITIES (SUCH AS PHONE CABLE, FIBER OPTIC CABLE, SEWER LINES, ETC.) ARE LOCATED ADJACENT TO U.S. ROUTE 7 WITHIN THE PROJECT LIMITS. THE CONTRACTOR IS RESPONSIBLE FOR CONTACTING "DIG SAFE" AT 1-888-344-7233 TO DETERMINE THE EXACT LOCATIONS OF THESE UTILITIES PRIOR TO INSTALLING GUARDRAIL, CLEANING DITCHES OR PERFORMING ANY OTHER OPERATIONS THAT MAY DISTURB THE EXISTING SUBSURFACE CONDITIONS.
 2. PLACE 100 mm OF COMPACTED COLD PLANE GRINDINGS ON THE EXISTING GRAVEL PULLOFF AND PROVIDE A 45 mm TYPE IIIIS 1.5 m WIDE APRON. ANY REQUIRED EXCAVATION SHALL BE PERFORMED AS DIRECTED BY THE RESIDENT ENGINEER AND PAID UNDER ITEM 608.25.

621.20 STEEL BEAM GUARDRAIL w/2.4m POSTS (MOD.) (GALVANIZED)
STA. 5+328.2 - STA. 5+423.5 (95.25m)

621.20 STEEL BEAM GUARDRAIL (GALVANIZED)

WALLINGFORD:
STA. 5+328.2 - STA. 5+461.2 LT (133.0 m)

621.505 MANUFACTURED TERMINAL SECTION (FLARED)

WALLINGFORD:
STA. 5+316.8 - STA. 5+328.2, LT
STA. 5+461.2 - STA. 5+472.6, LT
STA. 5+423.5 - STA. 5+434.9 LT

621.80 REMOVAL AND DISPOSAL OF GUARDRAIL

WALLINGFORD:
STA. 5+318.0 - STA. 5+432.0 LT (114.0 m)
676.10 DELINEATORS WITH STEEL POSTS

WALLINGFORD:
TYPE I WHITE
STA. 5+316.8 RT
STA. 5+472.6 RT

DATUM	
VERTICAL	N/A
HORIZONTAL	N/A

- SIGN LEGEND
- R= REMOVE
 - S= SALVAGE
 - N= NEW
 - RET= RETAIN
 - B-B= BACK TO BACK
 - EXISTING= -----
 - NEW= _____
 - ⊙ = SIGN TO BE RETURNED TO THE TOWN OF WALLINGFORD

PAVING PROJECT LAYOUT # 15

SURVEYED BY	N/A	DATE	N/A
DRAWN BY	C.A.K.	DATE	8/05
SQUAD LEADER	D.E.G.		
DESIGN FILE NO.	/pave/98b098/pb098.dgn		
IPARM FILE	pb098i15.i	DATE PLOTTED	02-JUL-2007 15
PROJ. NAME	WALLINGFORD		
PROJ. NO.	NH_2108(1)S_&_SIP_EH04(6)		
SHEET	35	OF	110 SHEETS