

MARSHFIELD - BRIDGE #77
STA 3+178.1 = MM 1.975

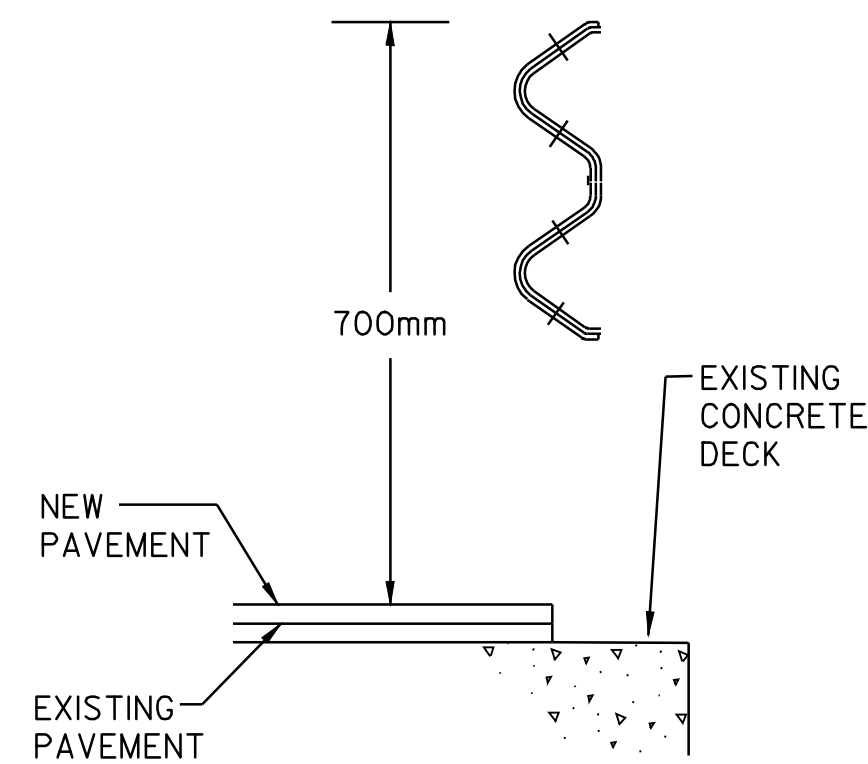

SECTION @ EXISTING POST

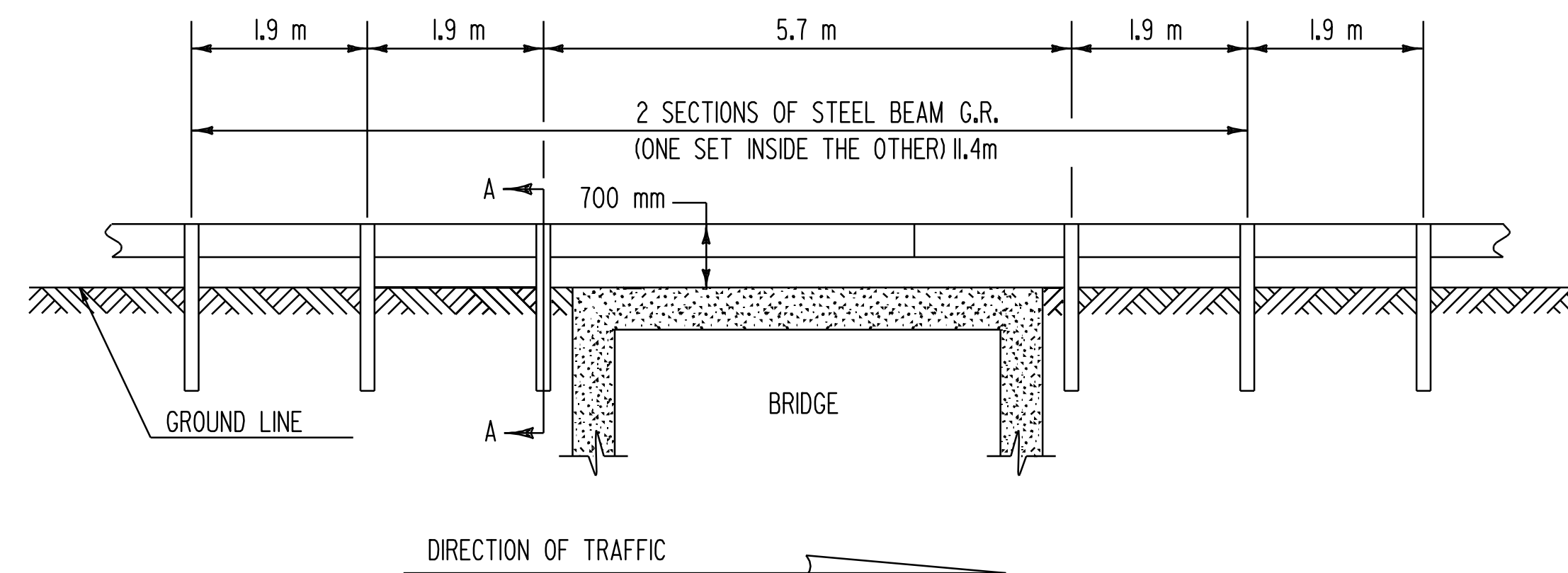

DETAIL OF STEEL BEAM GUARD RAIL AT LARGE CULVERTS/BRIDGES

NOTES

1. SEE STANDARD G-1M & G-1DM FOR STEEL BEAM GUARD RAIL DETAILS.
2. THIS WORK SHALL BE PAID UNDER ITEM 621.20, STEEL BEAM GUARD RAIL, OR 621.21 HEAVY DUTY STEEL BEAM GUARD RAIL AT A PAY FACTOR OF 1.0.

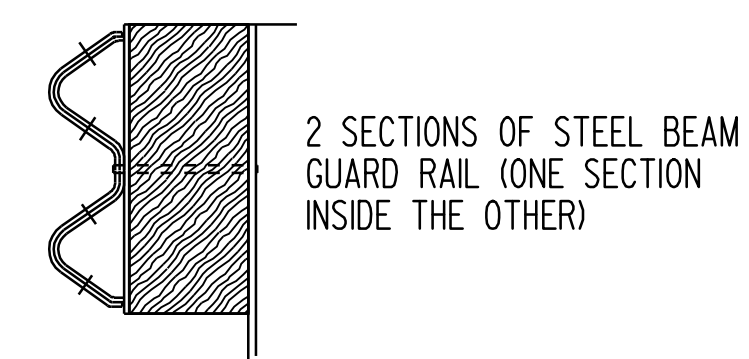

DETAIL A

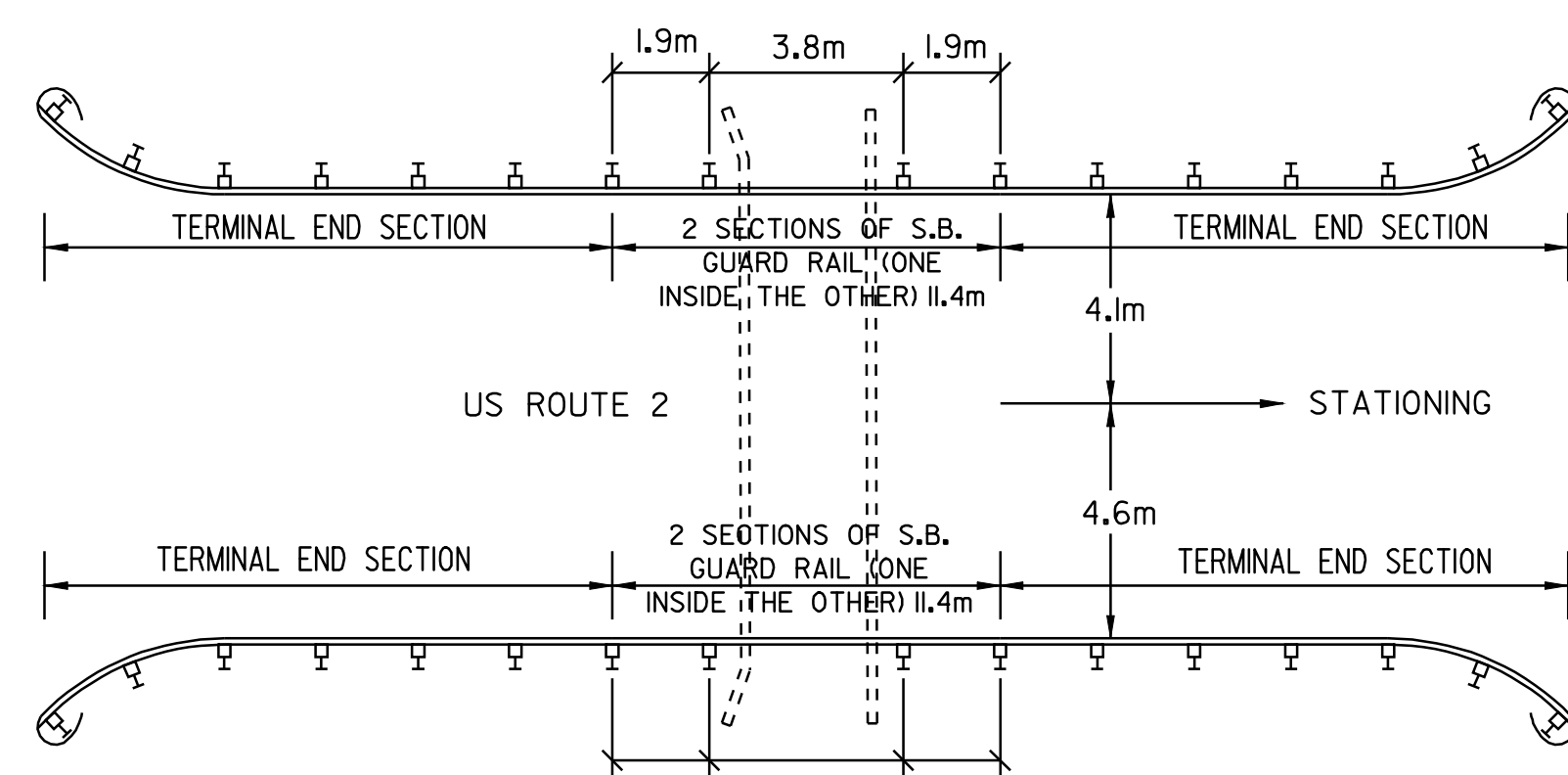
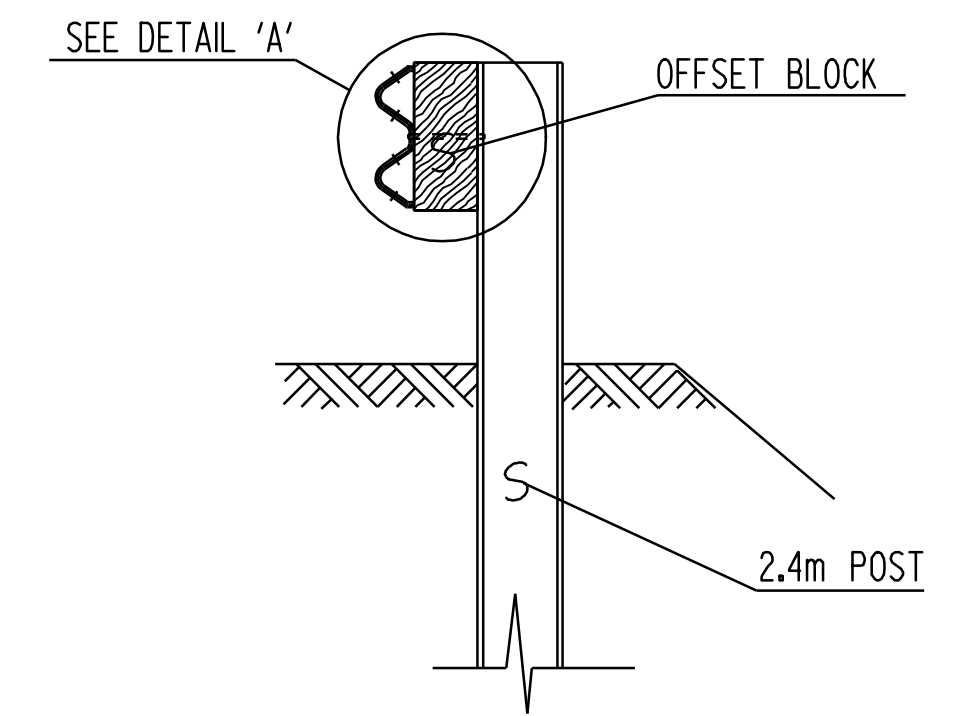

MARSHFIELD - BRIDGE #78
STA 7+365.8 = MM 4.577

NOTES

1. SEE STANDARD G-1M & G-1DM FOR STEEL BEAM GUARD RAIL DETAILS.
2. THIS WORK SHALL BE PAID UNDER ITEM 621.20, STEEL BEAM GUARD RAIL, OR 621.21 HEAVY DUTY STEEL BEAM GUARD RAIL AT A PAY FACTOR OF 1.0.

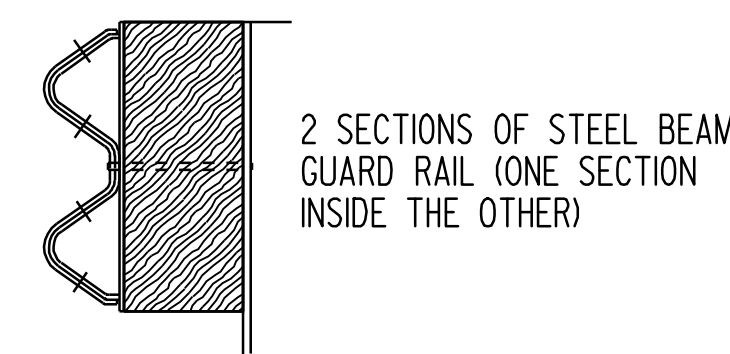
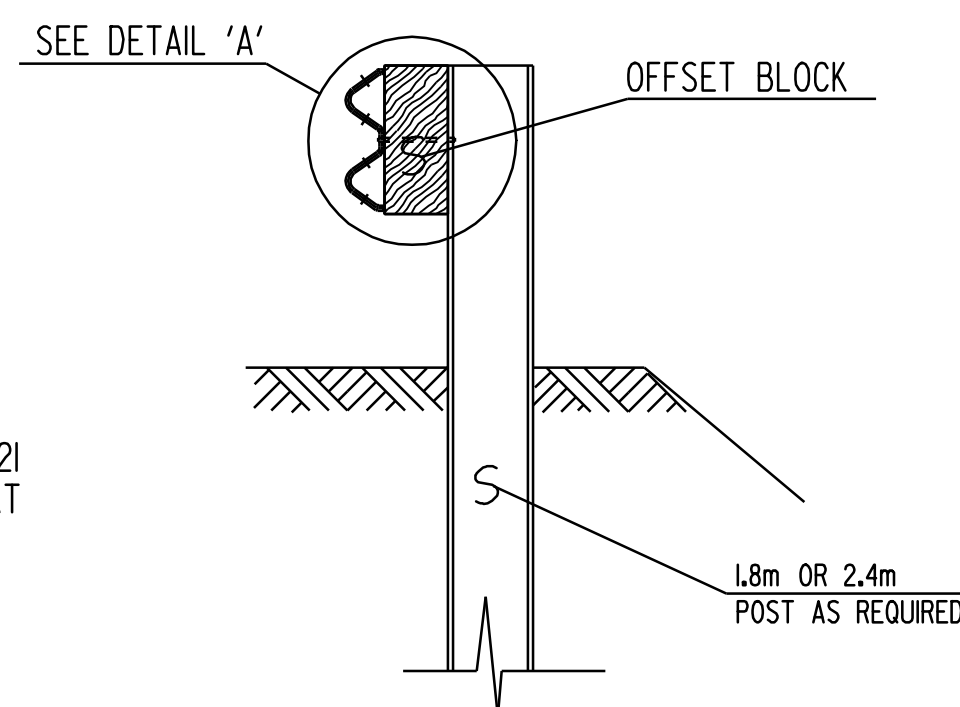

DETAIL A

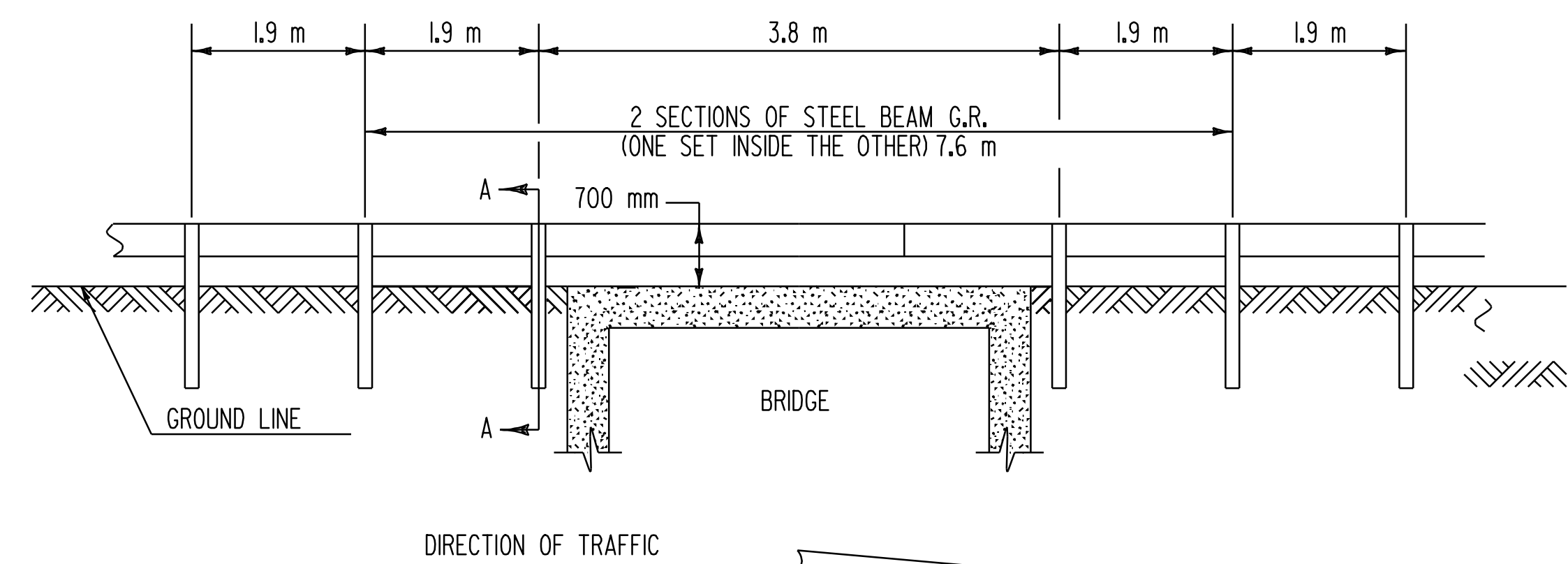

DETAIL OF STEEL BEAM GUARD RAIL AT LARGE CULVERTS/BRIDGES



**BRIDGE
 DETAIL
 SHEET
 #3**

DESIGNED BY BCE/PJM DATE 7-02
 DRAWN BY C.E.A., INC. DATE 7-02
 DESIGN FILE NO. /pave/98b090/pb090.dgn
 PRF FILE pb090b03.1 DATE 09-MAY-2008
 PLOTTED
 PROJ. NAME: **MARSHFIELD - CABOT**
 PROJ. NO.: **NH 2104(1)S**
 SHEET **54** OF **60** SHEETS