

TEMPORARY AND DURABLE 100m YELLOW LINE
 MARSHFIELD
 STA 13+000 TO 13+204.5 SOLID LT&RT
 CABOT
 STA 0+000 TO 0+122 SOLID LT&RT

TEMPORARY AND DURABLE 100m WHITE LINE
 MARSHFIELD
 STA 13+000 TO 13+196 SOLID LT&RT
 CABOT
 STA 0+000 TO 0+122 SOLID LT&RT

REHABILITATION OF D.I.'S, C.B.'S OR M.H.'S
 MARSHFIELD
 STA 13+002 LT
 CABOT
 STA 0+106 LT

YIELDING MARKER POST
 MARSHFIELD
 STA 13+002 LT
 CABOT
 STA 0+106 LT

REMOVING SIGNS
 5

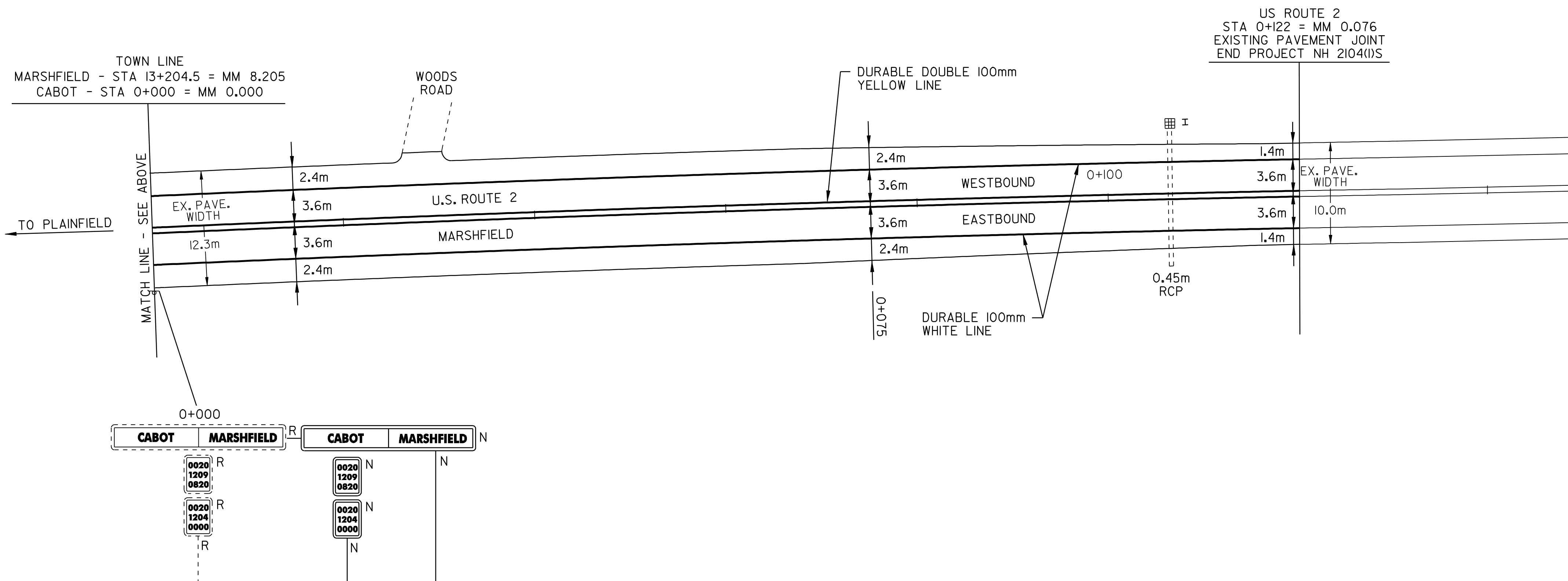
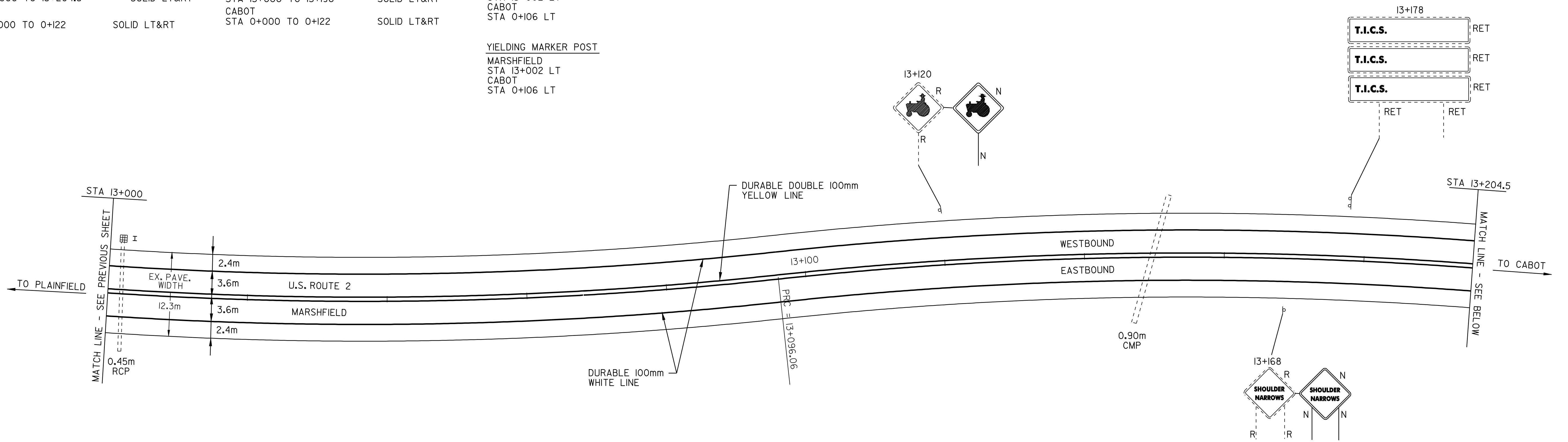

| | | | | |
|------------------------------------|-----------------|------------------------|--------------|----------------|
| <h2>PAVING PROJECT LAYOUT #16</h2> | DESIGNED BY | BCE/PJM | DATE | 7-02 |
| | DRAWN BY | C.E.A., INC. | DATE | 7-02 |
| | DESIGN FILE NO. | /pave/98b090/pb090.dgn | | |
| | PRF FILE | pb090pl6.1 | DATE PLOTTED | 09-MAY-2008 10 |
| | PROJ. NAME | MARSHFIELD - CABOT | | |
| PROJ. NO. | NH 2104(1)S | | | |
| SHEET | 26 | OF | 60 | SHEETS |