

TEMPORARY AND DURABLE 100m YELLOW LINE
 STA I2+200 TO I2+600
 SOLID LT&RT

TEMPORARY AND DURABLE 100m WHITE LINE
 STA I2+200 TO I2+600
 SOLID LT&RT
 STA I2+200 TO I2+403
 DASHED RT
 STA I2+546 TO I2+600
 DOTTED RT

REMOVING SIGNS
 15

REHABILITATION OF D.I.'S, C.B.'S OR M.H.'S
 STA I2+222 RT

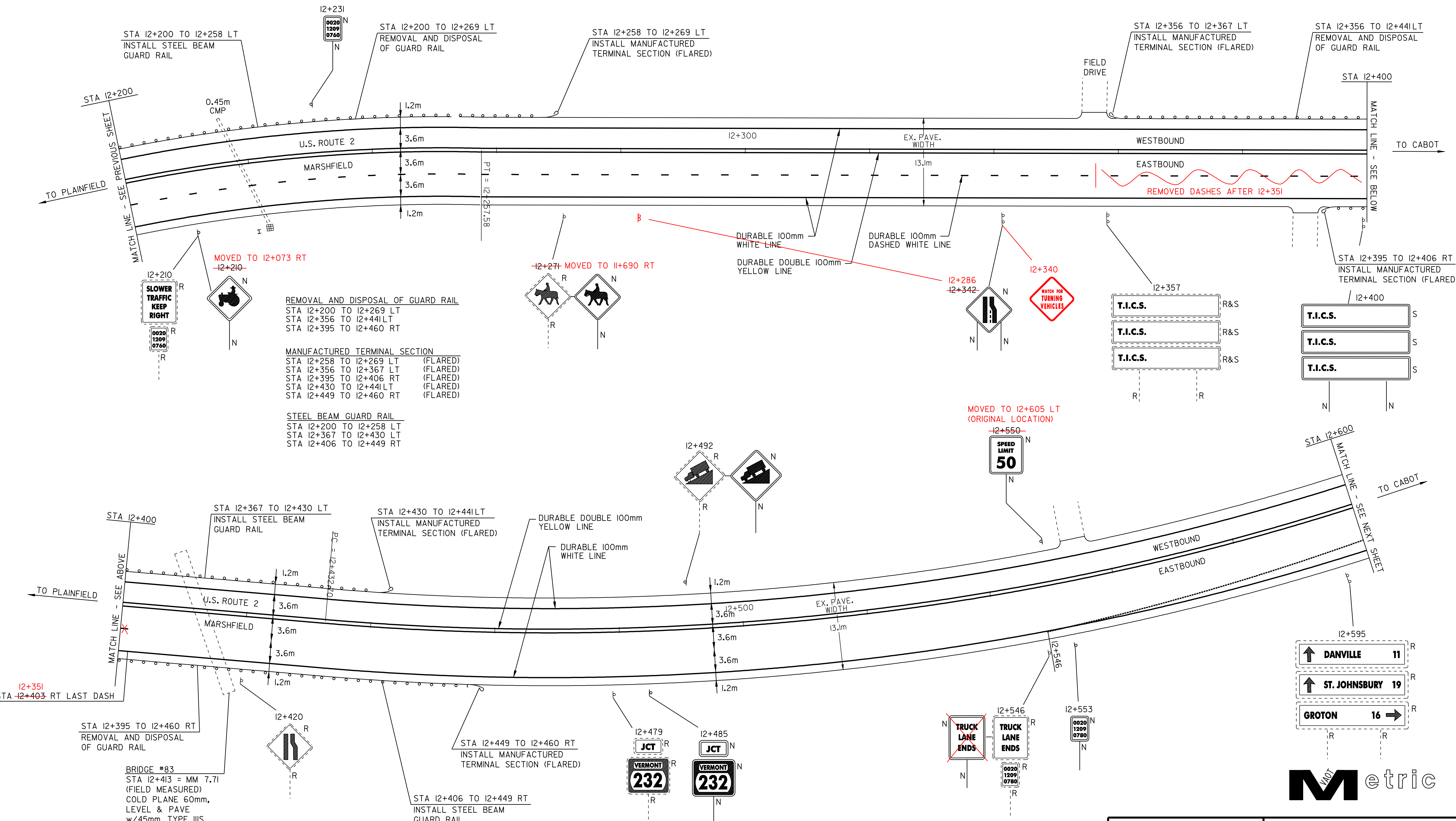

REMOVAL AND DISPOSAL OF GUARD RAIL
 STA I2+200 TO I2+269 LT
 STA I2+356 TO I2+441 LT
 STA I2+395 TO I2+460 RT

MANUFACTURED TERMINAL SECTION
 STA I2+258 TO I2+269 LT (FLARED)
 STA I2+356 TO I2+367 LT (FLARED)
 STA I2+395 TO I2+406 RT (FLARED)
 STA I2+430 TO I2+441 LT (FLARED)
 STA I2+449 TO I2+460 RT (FLARED)

STEEL BEAM GUARD RAIL
 STA I2+200 TO I2+258 LT
 STA I2+367 TO I2+430 LT
 STA I2+406 TO I2+449 RT

BRIDGE #83
 STA I2+413 = MM 7.71
 (FIELD MEASURED)
 COLD PLANE 60mm,
 LEVEL & PAVE
 w/45mm TYPE III S

↑ DANVILLE 11
 ↑ ST. JOHNSBURY 19
 GROTON 16 →

PAVING PROJECT LAYOUT #14

DESIGNED BY BCE/PJM DATE 7-02
 DRAWN BY C.E.A., INC. DATE 7-02
 DESIGN FILE NO. /pave/98b090/pb090.dgn
 PRF FILE pb090pl4.1 DATE PLOTTED 09-MAY-2008 10
 PROJ. NAME **MARSHFIELD - CABOT**
 PROJ. NO. **NH 2104(1)S**
 SHEET **24** OF **60** SHEETS

