

TEMPORARY AND DURABLE 100m YELLOW LINE  
 STA 6+600 TO 7+850 SOLID LT&RT  
 STA 7+303 DOUBLE SOLID LT  
 (WITH CENTERLINE BREAKS FOR TOWN HIGHWAYS)

TEMPORARY AND DURABLE 600m STOP BAR  
 STA 7+303 LT BEAVER MEADOW RD

REMOVING SIGNS  
 I3

YIELDING MARKER POST  
 STA 6+692 LT  
 STA 7+159 RT  
 STA 7+455 LT  
 STA 7+732 LT

TEMPORARY AND DURABLE 100m WHITE LINE  
 STA 6+600 TO 7+850 SOLID LT&RT  
 (WITH EDGELINE BREAKS FOR TOWN HIGHWAYS)

TEMPORARY AND DURABLE LETTER OR SYMBOL  
 STA 7+303 LT "STOP"

RELOCATED MAILBOX, SINGLE SUPPORT  
 STA 6+639 LT

RELOCATED MAILBOX, MULTIPLE SUPPORT  
 STA 7+692 LT (DOUBLE)

REHABILITATION OF D.I.'S, C.B.'S OR M.H.'S  
 STA 7+294 LT  
 STA 7+319 LT

PC = 6+910  
 PT = 7+220  
 R = 450m  
 SEE SHEET 29 FOR SUPERELEVATION DIAGRAM

PC = 7+690  
 PT = 7+840  
 R = 475m  
 SEE SHEET 29 FOR SUPERELEVATION DIAGRAM

PC = 7+420  
 PT = 7+570  
 R = 350m  
 SEE SHEET 29 FOR SUPERELEVATION DIAGRAM

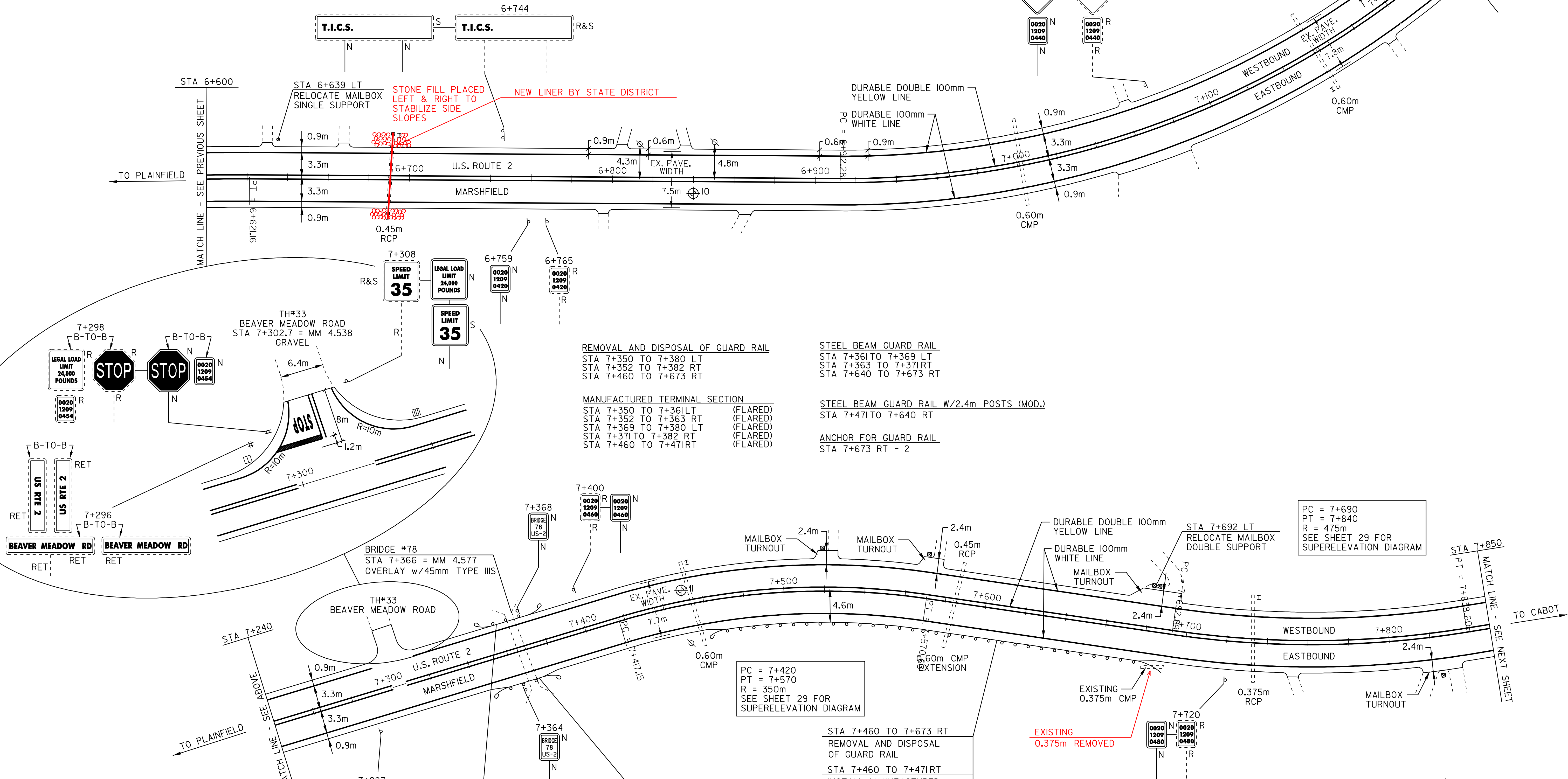

PAVEMENT CORES -

#	TOTAL DEPTH (mm)	SOLID CORE	COMMENTS
10	240	NO	CORE BROKE UP OVER CULVERT
11	180	YES	

NOTE:  
 - NO PCC UNDER ANY CORES  
 - NO CORES OVER ASPHALTED (UNLESS NOTED)  
 - NO SHOULDER CORES

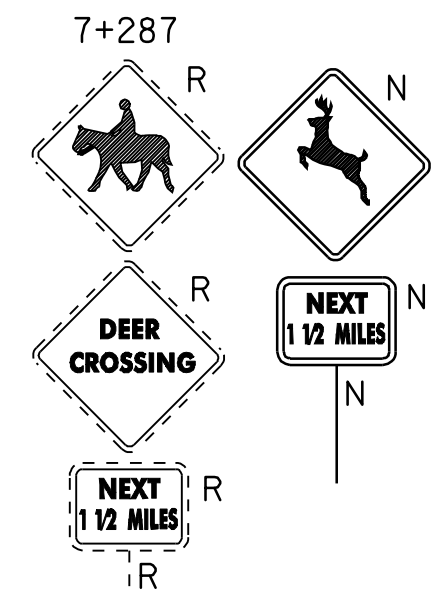

STA 7+350 TO 7+380 LT  
 REMOVAL AND DISPOSAL OF GUARD RAIL

STA 7+350 TO 7+361LT  
 INSTALL MANUFACTURED TERMINAL SECTION (FLARED)

STA 7+361 TO 7+369 LT  
 INSTALL STEEL BEAM GUARD RAIL

STA 7+369 TO 7+380 LT  
 INSTALL MANUFACTURED TERMINAL SECTION (FLARED)

STA 7+352 TO 7+382 RT  
 REMOVAL AND DISPOSAL OF GUARD RAIL

STA 7+352 TO 7+363 RT  
 INSTALL MANUFACTURED TERMINAL SECTION (FLARED)

STA 7+363 TO 7+371RT  
 INSTALL STEEL BEAM GUARD RAIL

STA 7+371 TO 7+382 RT  
 INSTALL MANUFACTURED TERMINAL SECTION (FLARED)

STA 7+460 TO 7+673 RT  
 REMOVAL AND DISPOSAL OF GUARD RAIL

STA 7+460 TO 7+471RT  
 INSTALL MANUFACTURED TERMINAL SECTION (FLARED)

STA 7+471 TO 7+640 RT  
 INSTALL STEEL BEAM GUARD RAIL W/2.4m POSTS (MOD.)

STA 7+640 TO 7+673 RT  
 INSTALL STEEL BEAM GUARD RAIL

STA 7+673 RT  
 INSTALL BURIED END TERMINAL  
 SEE SHEET 59 FOR DETAILS (MAINTAIN EXISTING CULVERT)

**INSTALL ANCHOR (2)**



# PAVING PROJECT LAYOUT #6

DESIGNED BY BCE/PJM DATE 7-02  
 DRAWN BY C.E.A., INC. DATE 7-02  
 DESIGN FILE NO. /pave/98b090/pb090.dgn  
 PRF FILE pb090p06.1 DATE PLOTTED 09-MAY-2008 10  
 PROJ. NAME **MARSHFIELD - CABOT**  
 PROJ. NO. **NH 2104(1)S**  
 SHEET **16** OF **60** SHEETS