

- NOTES:
1. TRAFFIC CONTROL PHASE III SHALL CONSIST OF TEMPORARY ROAD CLOSURE WITH DIVERSION ON US ROUTE 2 AND VT ROUTE 14. REFER TO MUTCD FIGURE 6H-7, ROAD CLOSURE WITH DIVERSION (TYPICAL APPLICATION 7).
 2. TEMPORARY LANE OR SHOULDER CLOSURES SHALL BE ALLOWED DURING WORKING HOURS. US ROUTE 2 AND VT 14 SHALL BE RESTORED TO FULL CAPACITY AT THE CLOSE OF DAILY CONSTRUCTION ACTIVITIES.
 3. ALL TEMPORARY PAVEMENT MARKINGS SHALL BE INSTALLED AS DENOTED ON TRAFFIC CONTROL LAYOUT SHEETS, AND SHALL BE PAID UNDER CONTRACT ITEM 900.645 (TEMPORARY ROADWAY)
 4. ADDITIONAL TRAFFIC CONTROL WARNING SIGNS MAY BE REQUIRED AND SHALL BE INSTALLED AS REQUESTED BY THE RESIDENT ENGINEER PER THE MUTCD. PAYMENT FOR THESE SIGNS, THE REFLECTORIZED PLASTIC DRUMS, ETC., SHALL BE PAID UNDER CONTRACT ITEM 641.10.
 5. ACCESS TO RESIDENTIAL DRIVES, COMMERCIAL DRIVES, AND TOWN HIGHWAYS SHALL BE MAINTAINED THROUGHOUT THE PROJECT'S DURATION.
 6. NON CRASHWORTHY FEATURES RESULTING FROM CONSTRUCTION ACTIVITIES THAT ARE LOCATED WITHIN THE CLEAR ZONE SHALL BE PROPERLY PROTECTED. ALL TEMPORARY DEVICES SHALL BE NCHRP COMPLIANT AND SHALL BE FURNISHED IN ACCORDANCE WITH SECTION 621. PAYMENT FOR TEMPORARY TRAFFIC BARRIER WILL BE MADE UNDER ITEM NO. 621.90 AND ENERGY ABSORPTION ATTENUATORS WILL BE MADE UNDER ITEM NO. 621.56.
 7. IF TEMPORARY BARRIER IS USED, BARRIER ENDS FACING ONCOMING TRAFFIC SHALL BE TAPERED BEYOND THE CLEAR ZONE, OR PROTECTED WITH AN APPROVED END TREATMENT. IF TEMPORARY BARRIER IS TO BE RELOCATED, PAYMENT WILL BE MADE UNDER ITEM NO. 621.95 REMOVE AND RESET TEMPORARY TRAFFIC BARRIER. IF AN ENERGY ABSORPTION ATTENUATOR IS TO BE RELOCATED, IT WILL BE CONSIDERED INCIDENTAL TO ITEM NO. 621.56.
 8. AS PER THE DISPLAYED TRAFFIC CONTROL PLAN, THE REMOVAL AND RESETTING OF TEMPORARY TRAFFIC BARRIER IS ONLY ANTICIPATED BETWEEN TRAFFIC CONTROL PHASES.

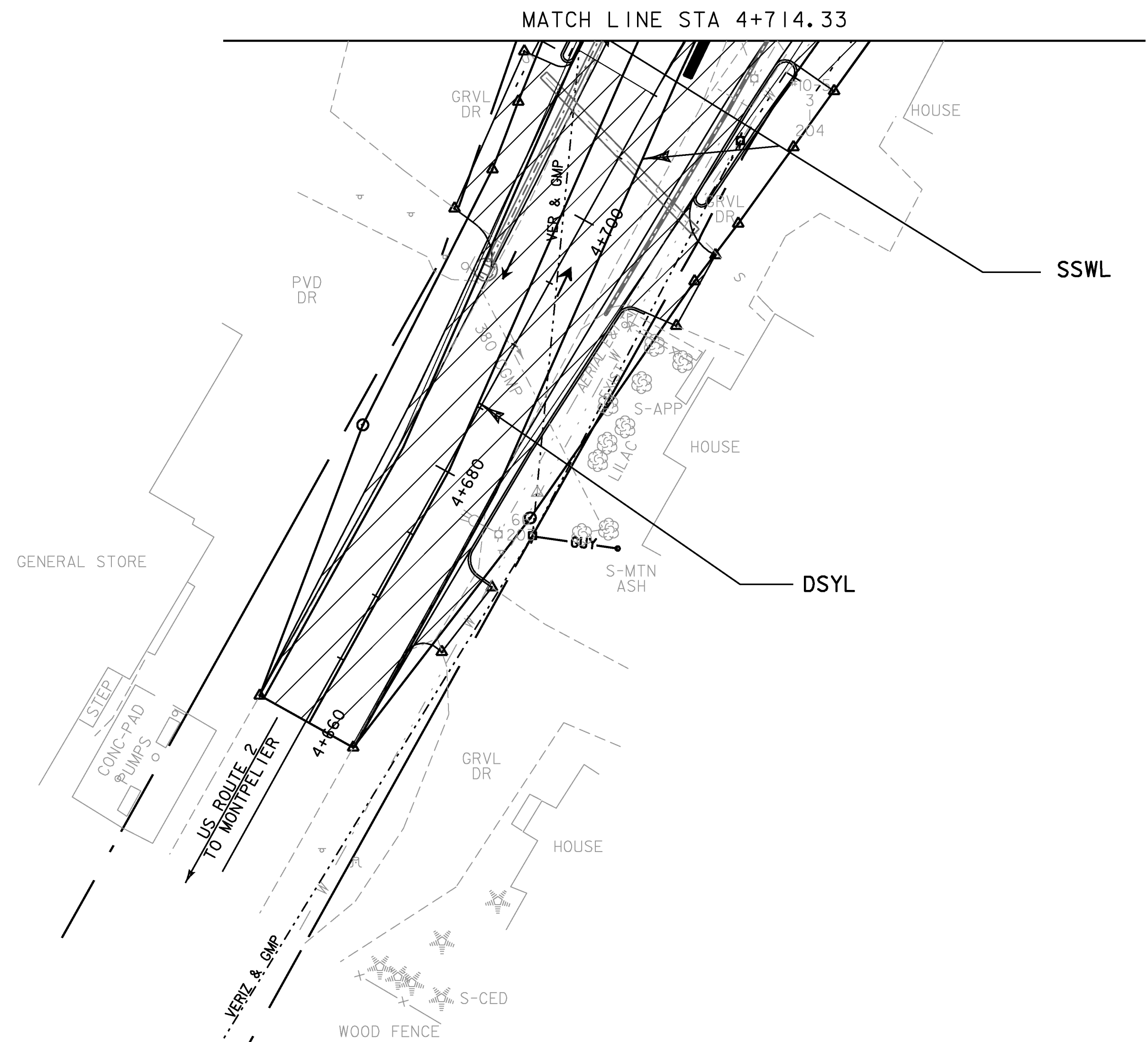

LEGEND	
	PHASE III CONSTRUCTION
	PHASE III TRAFFIC
	SSWL SINGLE SOLID WHITE LINE 100 mm WIDE (PAINT)
	DSYL DOUBLE SOLID YELLOW LINE 100mm WIDE (PAINT)



PROJECT NAME: EAST MONTPELIER
 PROJECT NUMBER: STPG 028 - 3(35)S
 FILE NAME: +98b028+cp3bdr.dgn
 PROJECT LEADER: J. SCHULTZ
 DESIGNED BY: J. GRUCHACZ
 TC PHASE 3 LAYOUT SHEET 1
 PLOT DATE: 29-MAR-2010
 DRAWN BY: I. DEGUTIS
 CHECKED BY: J. DEVLIN
 SHEET 95 OF 142