

SOIL CLASSIFICATION
 DUMMERSTON FINE SANDY LOAM
 15-25% SLOPES
 HYDROGROUP B
 "K FACTOR" 0.32
 MODERATE ERODIABILITY

SOIL CLASSIFICATION
 ADAMS LOAMY FINE SAND
 3-8% SLOPES
 HYDROGROUP A
 "K FACTOR" 0.17
 LOW ERODIABILITY

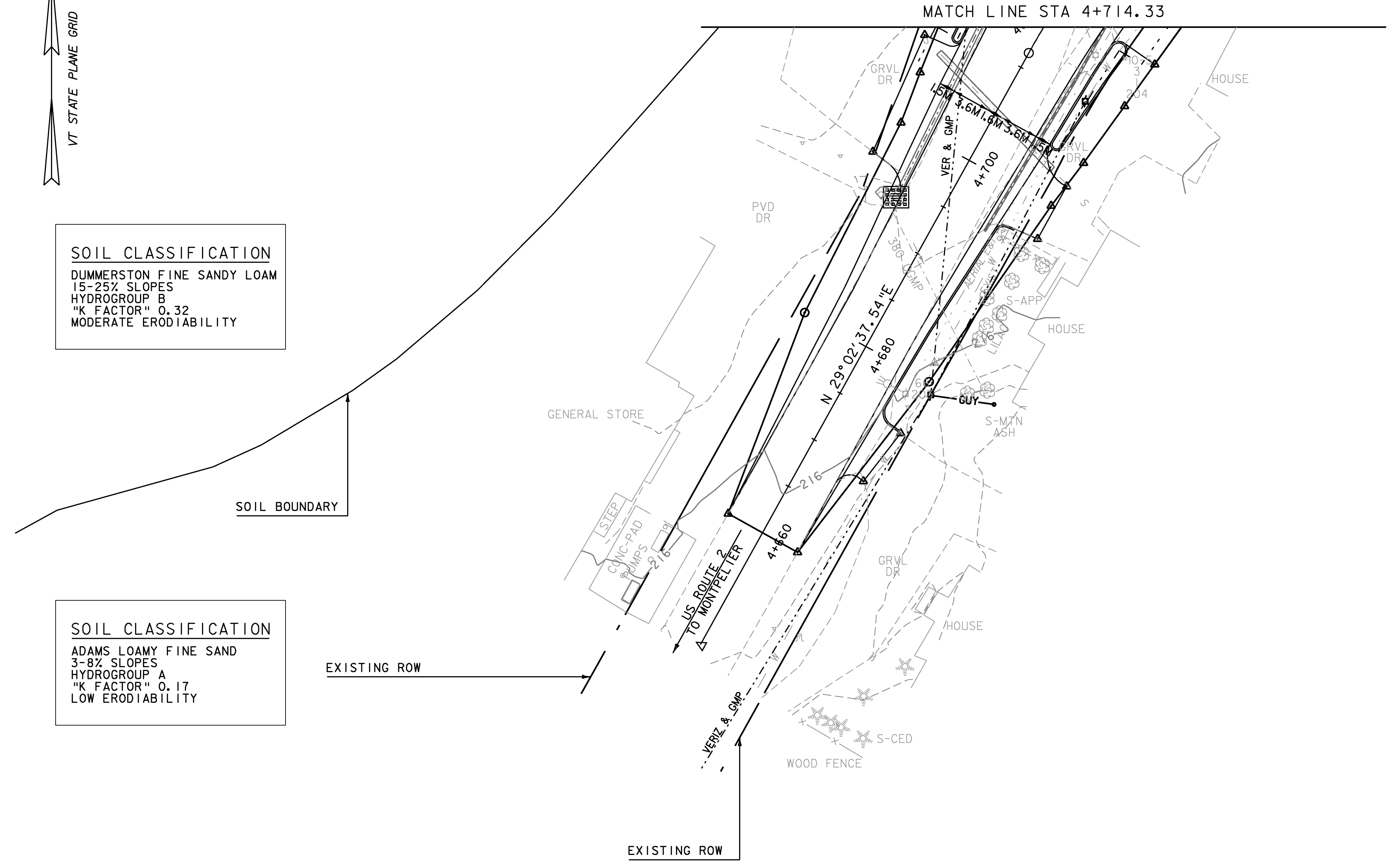

EXISTING ROW

EXISTING ROW

LEGEND

○ ———— △ LIMITS OF SOIL DISTURBANCE

STONE DROP INLET PROTECTION

NOTES:

1. THESE PLANS SHOW A CONCEPTUAL EROSION CONTROL PLAN. THE CONTRACTOR MUST SUBMIT A TEMPORARY EROSION CONTROL PLAN FOR APPROVAL.
2. TEMPORARY EROSION CONTROL MEASURES ARE CONCEPTUALLY SHOWN. THE CONTRACTOR MAY RELOCATE TEMPORARY MEASURES TO IMPROVE EROSION CONTROL WITH APPROVAL OF THE RESIDENT ENGINEER AND ON SITE COORDINATOR. SILT FENCE SHALL NOT BE INSTALLED ACROSS CONTOURS.
3. THE CONTRACTOR SHALL USE OTHER TEMPORARY EROSION CONTROL MEASURES AS NECESSITATED BY THE SEQUENCE OF CONSTRUCTION OR AS DIRECTED BY THE RESIDENT ENGINEER AND ON SITE COORDINATOR.
4. REFER TO TEMPORARY EROSION CONTROL DETAIL SHEETS FOR ADDITIONAL DETAILS.

653.40 - INLET PROTECTION DEVICE, TYPE I
 STA 4+693.66 LT



PROJECT NAME: EAST MONTEPELIER
 PROJECT NUMBER: STPG 028 - 3(35)S
 FILE NAME: +98b028econstructonbdr.dgn PLOT DATE: 22-MAR-2010
 PROJECT LEADER: J. SCHULTZ DRAWN BY: J. DEVLIN
 DESIGNED BY: J. GRUCHACZ CHECKED BY: J. SCHULTZ
 EPSC CONSTRUCTION SHEET 1 SHEET 53 OF 142