

INDEX OF SHEETS
SEE SHEET 2

STATE OF VERMONT AGENCY OF TRANSPORTATION

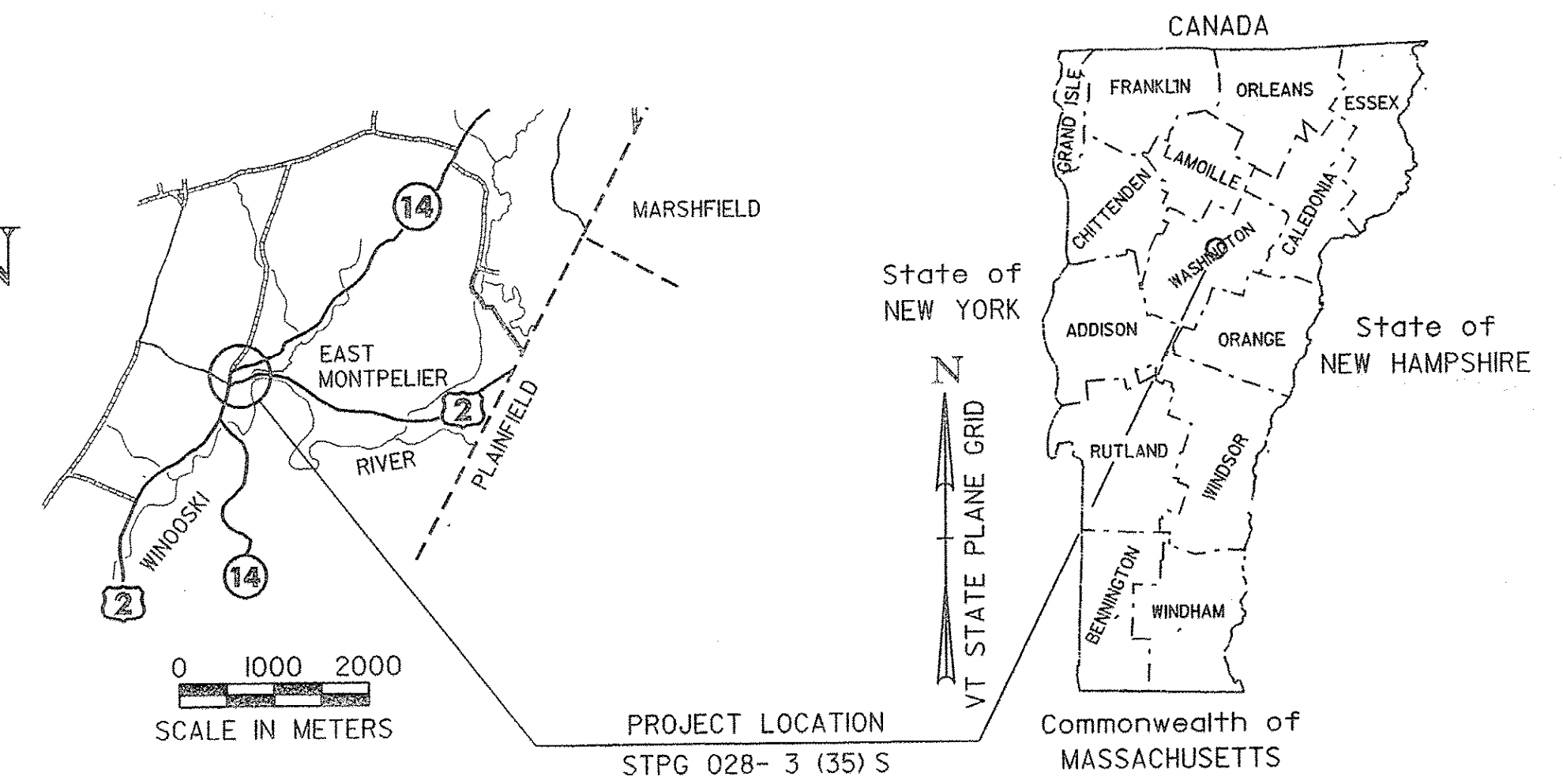

RECORD PLANS	
CONTRACTOR:	J. HUTCHINS, INC. - RICHMOND, VT
RESIDENT ENGINEER:	PETE HODGSON
CONSTRUCTION BEGAN:	AUGUST 10, 2010
CONSTRUCTION COMPLETE:	JULY 3, 2011
RECORD PLANS BY:	PETE HODGSON & JENNA HYDE
I HEREBY CERTIFY THAT ALL THE CONSTRUCTION REQUIRED BY THIS SET OF DRAWINGS HAS BEEN ACCOMPLISHED AS INDICATED HEREIN.	
BY:	<i>Pete Hodgson</i> RESIDENT ENGINEER
DATE:	12/23/10
NOTE: Any further information concerning final quantities, amounts or other details relative to this project may be found at Central Files in the electronic archives.	

PROPOSED IMPROVEMENT TOWN OF EAST MONTPELIER COUNTY OF WASHINGTON US ROUTE 2 - PRINCIPLE ARTERIAL & VT ROUTE 14 - MINOR ARTERIAL

BEGINNING AT A POINT ON US ROUTE 2, APPROXIMATELY 4.720 KILOMETERS EAST OF THE BARRE/EAST MONTPELIER TOWN LINE AND EXTENDING EASTERLY 0.180 KILOMETERS. WORK SHALL ALSO INCLUDE THE RELOCATION OF VT ROUTE 14, BEGINNING AT STATION 4+800.00 ON US ROUTE 2 AND EXTENDING NORTHERLY 0.184 KILOMETERS.

LENGTH OF ROADWAY, US ROUTE 2 = 0.180 KILOMETERS
 LENGTH OF ROADWAY, VT ROUTE 14 = 0.184 KILOMETERS
 LENGTH OF ROADWAY, QUAKER HILL ROAD = 0.060 KILOMETERS
 LENGTH OF ROADWAY, KELTON ROAD = 0.070 KILOMETERS
 TOTAL LENGTH OF ROADWAY = 0.494 KILOMETERS
 TOTAL LENGTH OF PROJECT = 0.364 KILOMETERS

WORK TO BE PERFORMED UNDER THIS PROJECT INCLUDES THE REALIGNMENT AND RECONSTRUCTION OF THE US ROUTE 2 AND VT ROUTE 14 INTERSECTION. ADDITIONAL WORK SHALL INCLUDE NEW DRAINAGE, SUBBASE, PAVEMENT, TRAFFIC CONTROL SIGNAL SYSTEM, PARKING AREA, PAVEMENT MARKINGS, AND MISCELLANEOUS ROADWAY ITEMS.

TRAFFIC DATA

LOCATION	ADT		DHV	ADTT	%T	%D	ESALS	ESALS	V
	2010	2030	2030	2030	2030	2030	(2010-2030)	(2010-2050)	
US ROUTE 2 EAST	6,800	8,300	930	830	7.5	62	3,508,000	8,177,000	60 KPH
US ROUTE 2 WEST	11,000	13,400	1,500	1,500	11.3	69	7,693,000	19,354,000	60 KPH
VT ROUTE 14	4,500	5,500	610	640	4.1	71	3,151,000	8,193,000	60 KPH

BITUMINOUS CONCRETE PAVEMENT SUPERPAVE MIXTURE DESIGN CRITERIA	
DESIGN LANE / DESIGN LIFE ESAL	7,693,000
DESIGN NUMBER OF GYRATIONS	65
PERFORMANCE GRADE ASPHALT BINDER	SEE SECTION 490 GENERAL SPECIAL PROVISIONS

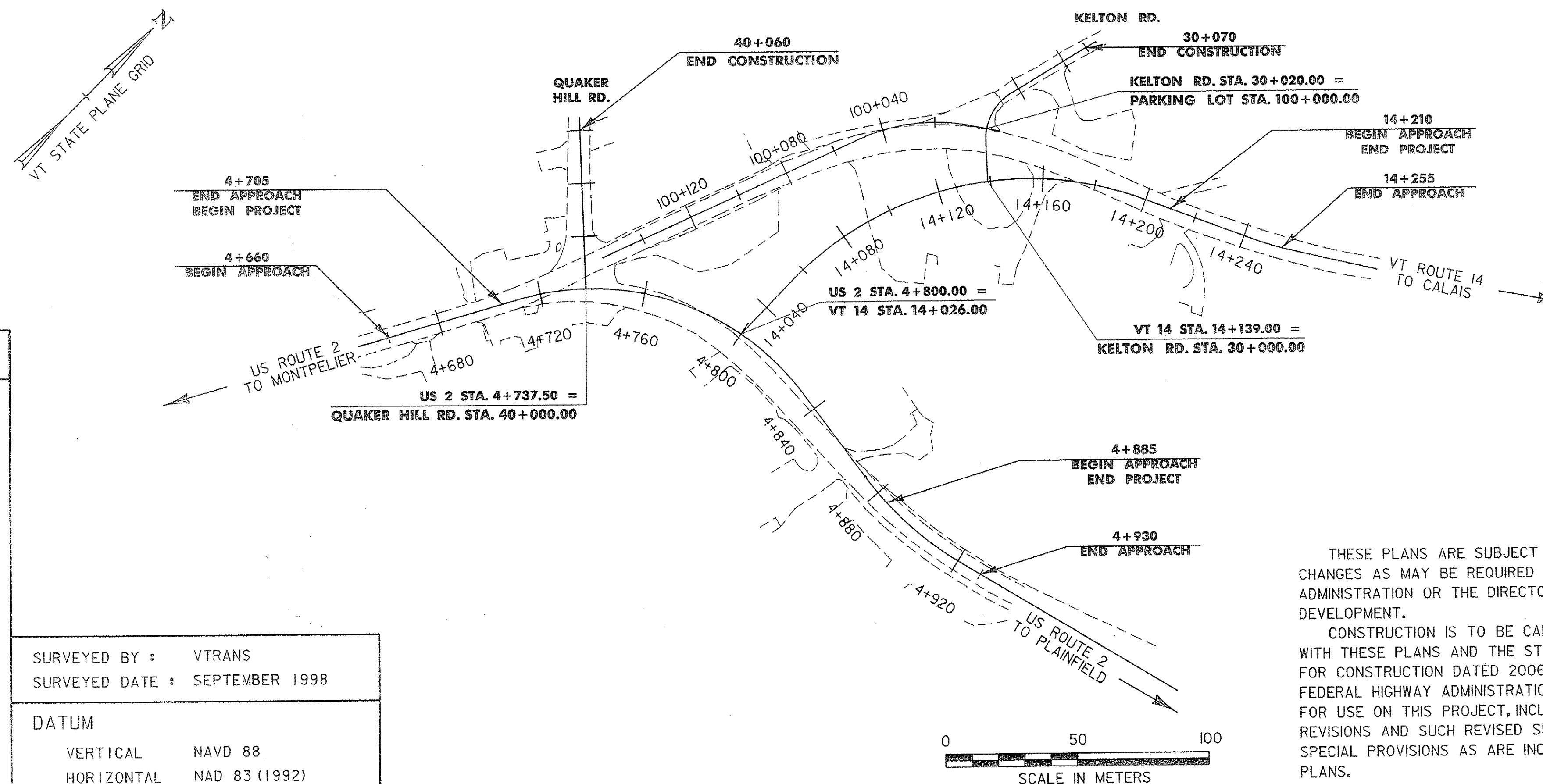

CONVENTIONAL SYMBOLS	
COUNTY LINE	
TOWN LINE	
LIMITS OF ACCESS	
POINT OF ACCESS	
FENCE LINE	
STONE WALL	
TRAVELED WAY	
GUARD RAIL	
RAILROAD	
SURVEY LINE	
CULVERT	
POWER POLE	
TELEPHONE POLE	
TREES	
CONTROL OF ACCESS	
PROPERTY LINE	
R.O.W. TAKING LINE	
SLOPE RIGHTS	
TOP OF CUT	
TOE OF SLOPE	

SURVEYED BY : VTRANS
 SURVEYED DATE : SEPTEMBER 1998
 DATUM
 VERTICAL NAVD 88
 HORIZONTAL NAD 83 (1992)

THESE PLANS ARE SUBJECT TO SUCH ENGINEERING CHANGES AS MAY BE REQUIRED BY THE FEDERAL HIGHWAY ADMINISTRATION OR THE DIRECTOR OF PROJECT DEVELOPMENT.

CONSTRUCTION IS TO BE CARRIED ON IN ACCORDANCE WITH THESE PLANS AND THE STANDARD SPECIFICATIONS FOR CONSTRUCTION DATED 2006, AS APPROVED BY THE FEDERAL HIGHWAY ADMINISTRATION ON JUNE 15, 2006 FOR USE ON THIS PROJECT, INCLUDING ALL SUBSEQUENT REVISIONS AND SUCH REVISED SPECIFICATIONS AND SPECIAL PROVISIONS AS ARE INCORPORATED IN THESE PLANS.



UNLESS NOTED OTHERWISE
 STATIONS ARE IN KILOMETERS
 ELEVATIONS ARE IN METERS
 DIMENSIONS ARE IN MILLIMETERS

DIRECTOR OF PROJECT DEVELOPMENT	
APPROVED <i>Richard Stewart</i>	DATE 3/23/10
PROJECT MANAGER : JOSHUA SCHULTZ	
PROJECT NAME :	EAST MONTPELIER
PROJECT NUMBER :	STPG 028-3 (35) S
SHEET 1 OF 142 SHEETS	