

TEMPORARY AND DURABLE 100 mm YELLOW LINE  
 STA. 2+340.0 TO 2+397.9, SOLID LT. & RT.  
 (WITH CENTERLINE BREAKS FOR HOSPITAL)  
 STA. 2+355.2, LT. DOUBLE SOLID (HOSPITAL)

TEMPORARY AND DURABLE 600 mm STOP BAR (TYPE ITAPE)  
 STA. 2+355.2, LT. (PVT TO HOSPITAL)

TEMPORARY AND DURABLE LETTER OR SYMBOL (TYPE ITAPE)  
 STA. 2+355.2, LT. - 'STOP'

TEMPORARY AND DURABLE CROSSWALK MARKING W/DIAGONAL LINES (MOD.)  
 STA. 2+355.2, LT.

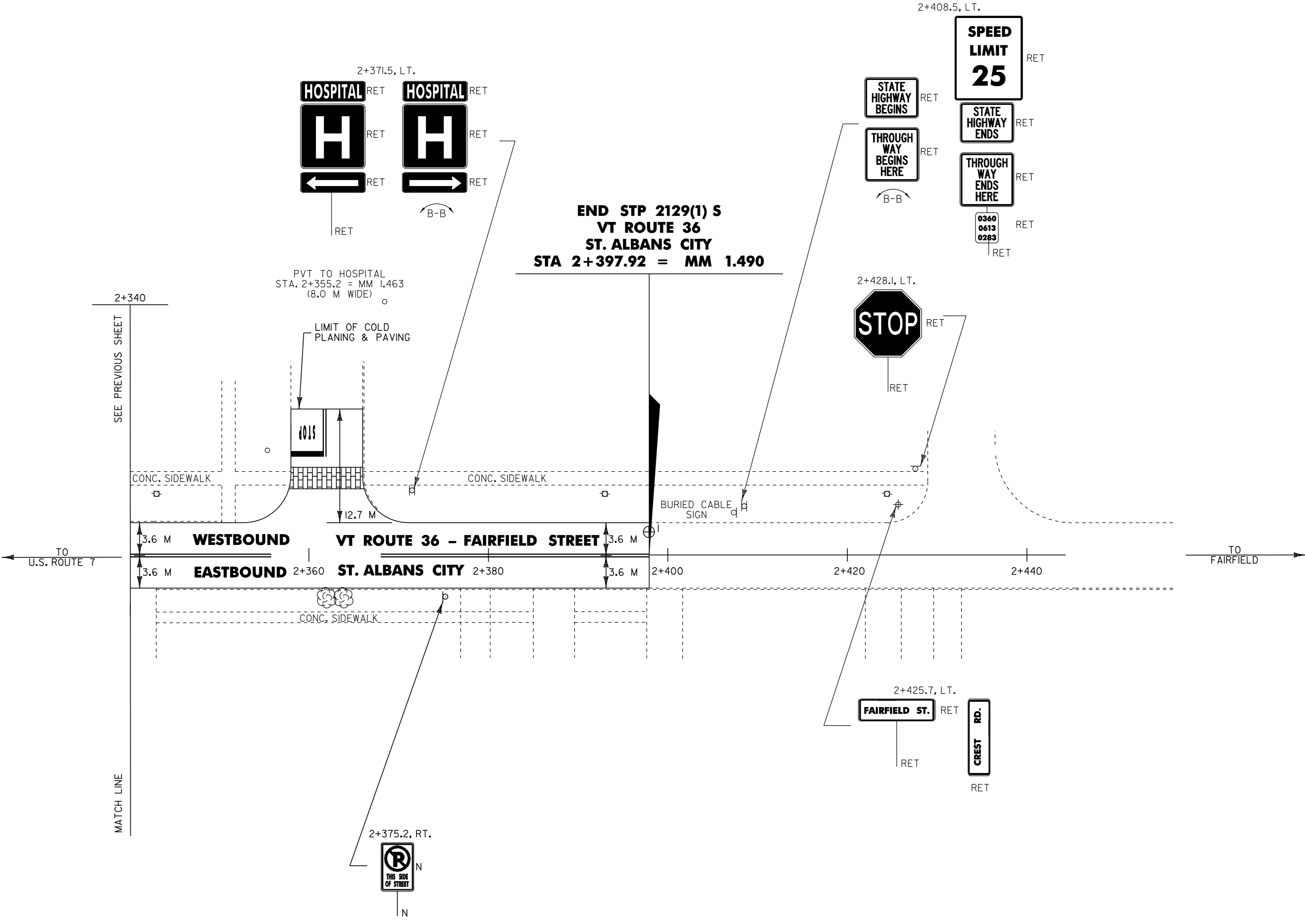

⊕ CORE LOCATION

PAVEMENT CORE DATA			
CORE #	LOCATION	DEPTH (mm)	PCC
1	2+397.9, LT.	171	YES

NOTES: 1) ALL DIMENSIONS IN MILLIMETERS EXCEPT WHERE OTHERWISE INDICATED.  
 2) ALL EXISTING SIGNS NOT SHOWN SHALL BE RETAINED AS DIRECTED BY THE RESIDENT ENGINEER.  
 3) FOR ANY TOWN HIGHWAY OR STREET DETAILS, SEE VTTRANS STANDARD E-193M.

**PROJECT LAYOUT #8**

PROJECT NAME: ST. ALBANS CITY  
 PROJECT NUMBER: STP\_2129(1)S  
 FILE NAME: ZpqveZ99d070Zpd070.dgn  
 PROJECT LEADER: JLL  
 DESIGNED BY: D-H  
 IPARM FILE NAME: pd070p08.i  
 PLOT DATE: 01-FEB-2006 07:5  
 DRAWN BY: D-H  
 CHECKED BY:  
 SHEET 82 OF 105

