

TEMPORARY & DURABLE 100 mm WHITE LINE
 STA. I+940.0 TO I+944.0, SOLID RT. (LANE LINE)
 STA. I+945.0 TO I+969.0, DOTTED RT.
 STA. I+973.0 TO I+990.0, SOLID LT. (LANE LINE)
 STA. I+973.0 TO 2+002.0, SOLID RT. (LANE LINE)
 STA. I+990.0 TO 2+014.6, DOTTED LT.
 STA. 2+003.8, SOLID LT. (LAKE ST. EDGELINES, LANE LINES & DIAGONALS)
 STA. 2+014.6 TO 2+034.0, SOLID LT. (LANE LINES)
 STA. 2+034.0 TO 2+064.0, DOTTED LT.

TEMPORARY & DURABLE 100 mm YELLOW LINE
 STA. I+973.0 TO I+990.0, SOLID LT. & RT.
 STA. 2+018.6 TO 2+065.0, SOLID LT. & RT.
 STA. 2+003.8, DOUBLE SOLID LT. (LAKE ST.)

TEMPORARY & DURABLE CROSSWALK WITH DIAGONAL LINES (MOD.)
 STA. I+946.0
 STA. I+970.0
 STA. 2+003.8, LT. (LAKE ST.)
 STA. 2+012.0

DURABLE LETTER OR SYMBOL (TYPE ITAPE)
 STA. I+975.7, LT. - " " " 980.0
 STA. I+976.0, LT. - " " " 980.0
 STA. I+979.3, LT. - "ONLY" 985.0
 STA. I+983.7, RT. - "ONLY" 989.0
 STA. I+987.3, RT. - " " " 993.0
 STA. 2+003.8, LT. - "ONLY" (2)
 (LAKE ST.)
 STA. 2+003.8, LT. - " " " (2)
 (LAKE ST.)
 STA. 2+029.0, LT. - " " " 034.0
 STA. 2+029.2, LT. - " " " (2) 034.0
 STA. 2+032.8, LT. - "ONLY" (2) 034.0

TEMPORARY LETTER OR SYMBOL
 STA. I+975.7, LT. - " " " 983.0
 STA. I+976.0, LT. - " " " 983.0
 STA. I+987.3, RT. - " " " 983.0
 STA. 2+003.8, LT. - " " " (2)
 (LAKE ST.)
 STA. 2+029.0, LT. - " " " 034.0
 STA. 2+029.2, LT. - " " " (2) 034.0

NOTE: FOR EXISTING SIGNS, SEE PREVIOUS SHEET.

CHANGING ELEVATION OF VALVE BOX
 STA. I+943.5, LT. - WSO
 STA. I+945.5, LT. - WSO
 STA. I+991.0, RT. - WSO
 STA. 2+000.0, LT. - WSO
 STA. 2+028.0, LT. - WSO
 STA. 2+057.0, LT. - TEST CP

CHANGING ELEVATION OF DI'S, CB'S OR MH'S
 STA. I+945.5, RT. - MH
 STA. I+968.0, RT. - MH
 STA. I+973.0, RT. - MH
 STA. I+991.0, LT. - DI
 STA. I+993.0, RT. - MH
 STA. I+995.0, RT. - MH
 STA. I+999.0, LT. - MH
 STA. 2+020.0, RT. - MH
 STA. 2+023.5, RT. - MH

REHABILITATION OF DI'S, CB'S OR MH'S - CLASS I
 STA. I+943.0, RT. - DI
 STA. I+950.0, LT. - DI
 STA. I+974.0, RT. - DI LT.
 STA. I+991.0, RT. - DI RT.<.
 STA. 2+009.0, LT. - DI
 STA. 2+023.5, RT. - DI
 STA. 2+024.5, LT. - DI

CHANGING ELEVATION OF SMH'S
 STA. I+940.5, LT.
 STA. I+946.5, LT.
 STA. I+996.0, RT.
 PAINTED CURB
 IN NO-PARKING AREAS AS
 DIRECTED BY RESIDENT ENGINEER

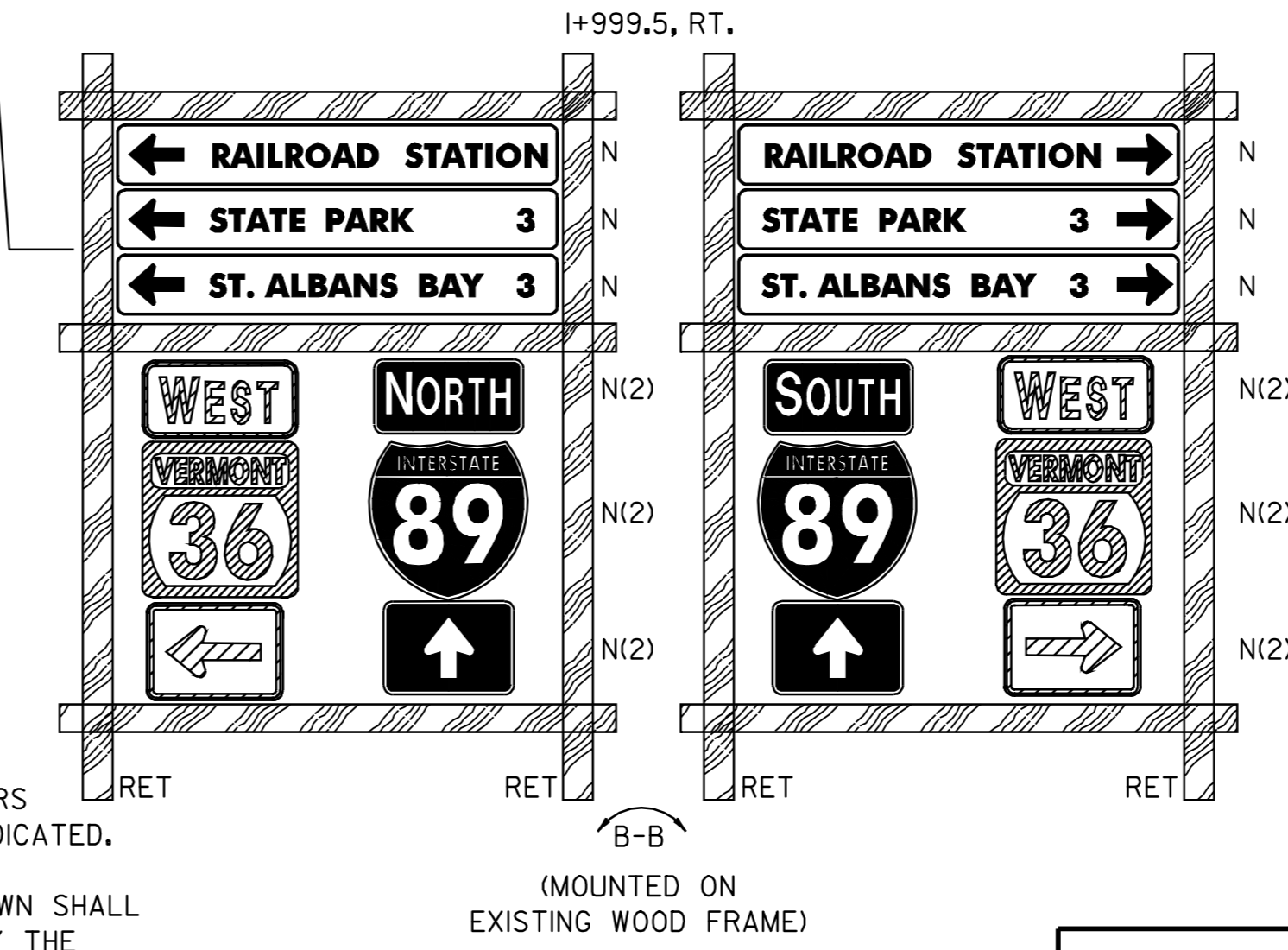
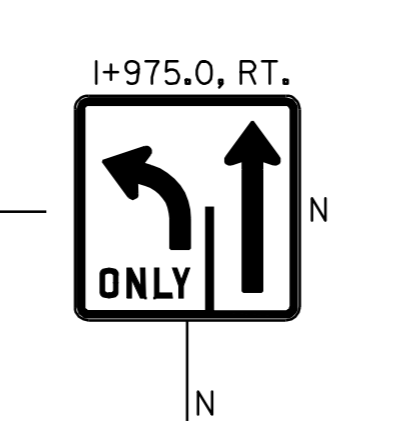
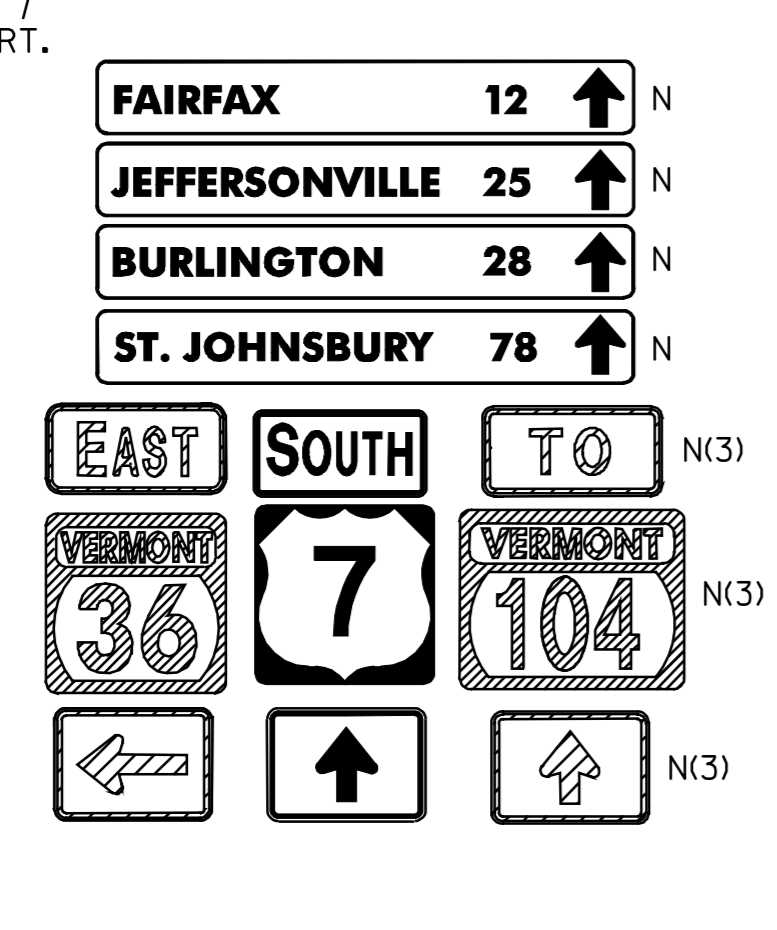
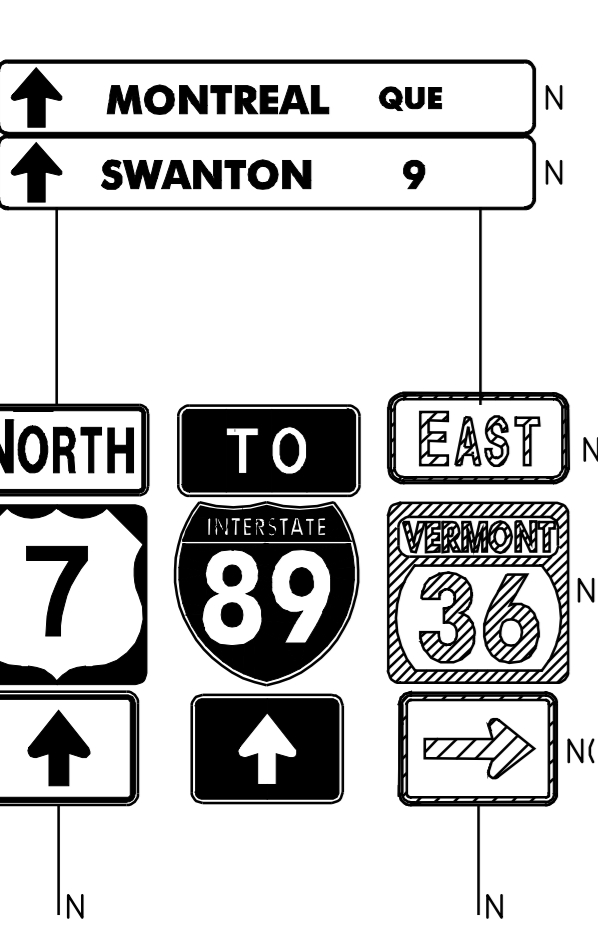
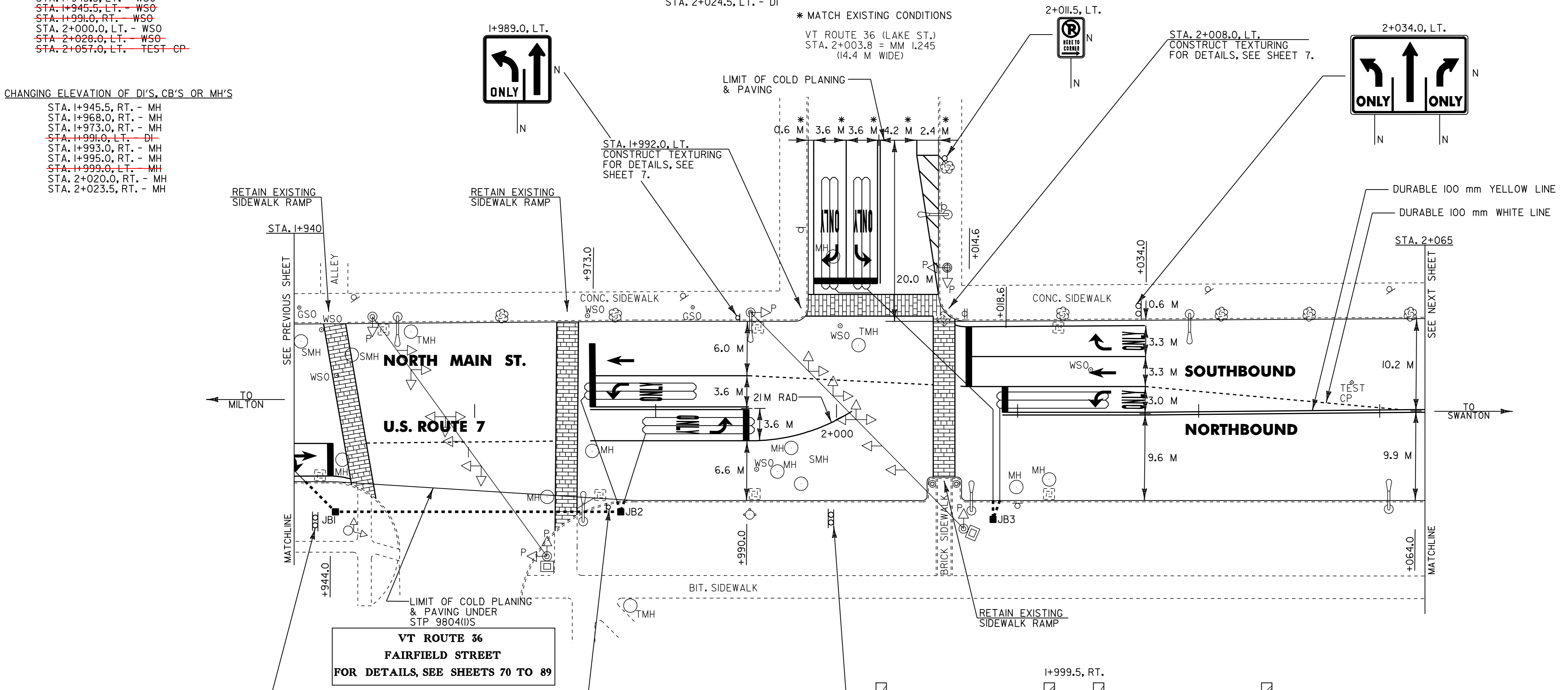

- NOTES: 1) ALL DIMENSIONS IN MILLIMETERS EXCEPT WHERE OTHERWISE INDICATED.
 2) ALL EXISTING SIGNS NOT SHOWN SHALL BE RETAINED AS DIRECTED BY THE RESIDENT ENGINEER.
 3) FOR ANY TOWN HIGHWAY OR STREET DETAILS, SEE VTrans STANDARD E-193M.
 4) FOR VEHICLE DETECTOR LOOP DETAILS SEE SHEET 10.

PROJECT LAYOUT #14B PROPOSED SIGNS

PROJECT NAME: ST. ALBANS CITY	PLOT DATE: 01-FEB-2006 07:4
PROJECT NUMBER: STP_9804(I)S	DRAWN BY: D-H
FILE NAME: Zpqve297d150Zpd150.dgn	CHECKED BY:
DESIGNED BY: D-H	SHEET 34 OF 105
IPARM FILE NAME: pd150pd14b.i	

