

~~TEMPORARY & DURABLE 100 mm WHITE LINE~~  
 STA. 0+640.0 TO 0+805.0, SOLID LT. & RT.  
 STA. 0+720.0 TO 0+766.5, DOTTED RT.  
 STA. 0+766.5 TO 0+805.0, SOLID RT. (LANE LINE)

~~TEMPORARY & DURABLE 100 mm YELLOW LINE~~  
 STA. 0+640.0 TO 0+805.0, SOLID LT. & RT.

~~DURABLE LETTER OR SYMBOL (TYPE ITAPE)~~  
 702 STA. 0+687.0, RT. - "SCHOOL"  
 768 STA. 0+767.7, RT. - "ONLY"  
 772 STA. 0+771.3, RT. - " "

~~TEMPORARY LETTER OR SYMBOL~~  
 STA. 0+687.0, RT. - "SCHOOL"  
 STA. 0+771.3, RT. - " "

~~REHABILITATION OF DI'S, CB'S OR MH'S - CLASS I~~  
 STA. 0+686.0, LT. & RT. - DI'S

~~CHANGING ELEVATION OF SMH'S~~  
 STA. 0+701.8, LT.  
 STA. 0+754.0, LT.  
 STA. 0+757.0, RT.

TEMPORARY & DURABLE 200 mm WHITE LINE  
 STA. 0+690.0 TO 0+740.0, SOLID RT. (DIAGONALS)  
 REMOVING SIGNS  
 AS SHOWN - 4

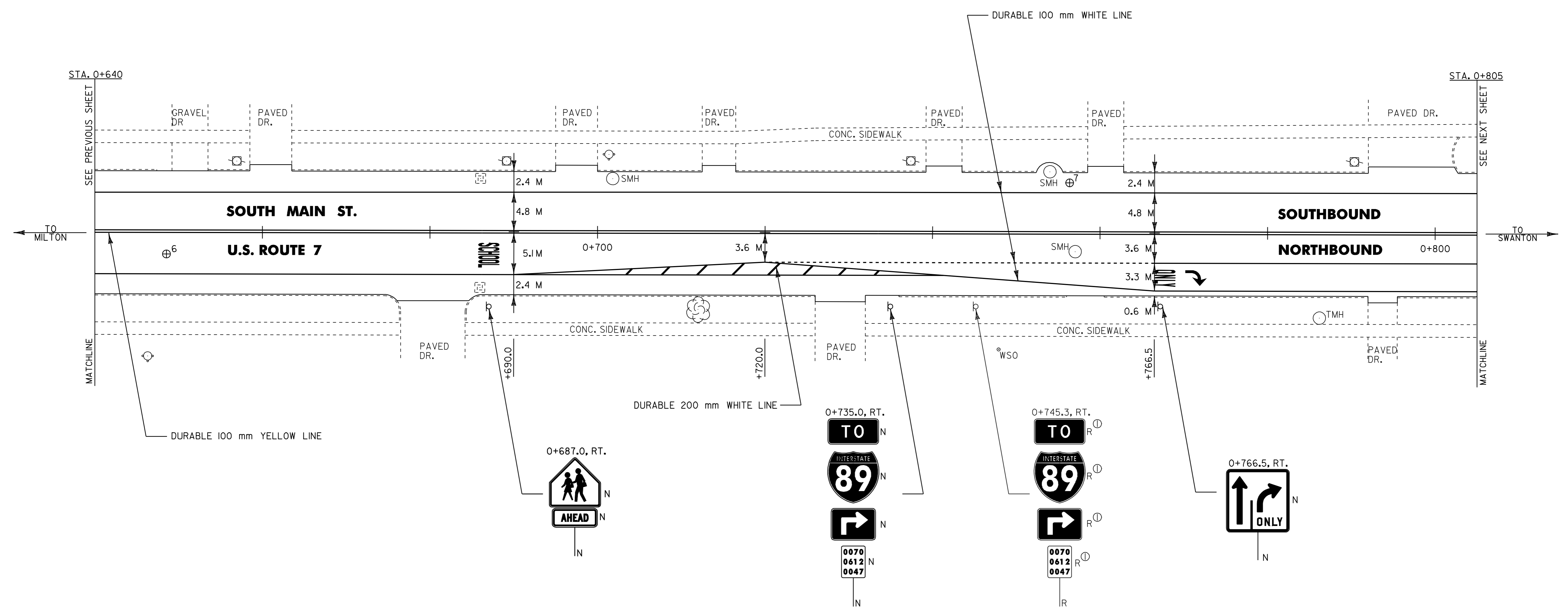

⊕ CORE LOCATION

PAVEMENT CORE DATA			
CORE #	LOCATION	DEPTH (mm)	PCC
6	0+648.6, RT.	178	NO
7	0+756.4, LT.	152	NO

NOTES: 1) ALL DIMENSIONS IN MILLIMETERS EXCEPT WHERE OTHERWISE INDICATED.  
 2) ALL EXISTING SIGNS NOT SHOWN SHALL BE RETAINED AS DIRECTED BY THE RESIDENT ENGINEER.  
 3) FOR ANY TOWN HIGHWAY OR STREET DETAILS, SEE VTrans STANDARD E-193M.

**LAYOUT SHEET #5**

PROJECT NAME: ST. ALBANS CITY  
 PROJECT NUMBER: STP\_9804(I)S  
 FILE NAME: 2pave297d1502pd150.dgn PLOT DATE: 01-FEB-2006 07:  
 PROJECT LEADER: JLL DRAWN BY: D-H  
 DESIGNED BY: D-H CHECKED BY:  
 IPARM FILE NAME: pd150p05.i SHEET 23 OF 105

