

~~TEMPORARY & DURABLE 100 mm WHITE LINE~~ STA. 0+165.0 TO 0+325.0, SOLID LT. & RT. (WITH EDGELINE BREAKS FOR INDUSTRIAL PARK RD. & FAIRFAX ST.) STA. 0+242.0, LT. (INDUSTRIAL PARK RD. EDGELINES) STA. 0+306.3, RT. (FAIRFAX ST. EDGELINES)

~~TEMPORARY & DURABLE 100 mm YELLOW LINE~~ STA. 0+165.0 TO 0+325.0, SOLID LT. & RT. (WITH CENTERLINE BREAKS FOR INDUSTRIAL PARK RD. & FAIRFAX ST.) STA. 0+242.0, LT. (INDUSTRIAL PARK RD. EDGELINES AROUND ISLAND)

~~TEMPORARY & DURABLE CROSSWALK WITH DIAGONAL LINES (MOD.)~~ STA. 0+242.0, LT. (INDUSTRIAL PARK RD.) STA. 0+306.3, RT. (FAIRFAX ST.)

~~TEMPORARY & DURABLE 600 mm STOP BAR (TYPE ITAPE)~~ STA. 0+242.0, LT. (INDUSTRIAL PARK RD.) STA. 0+306.3, RT. (FAIRFAX ST.)

~~TEMPORARY & DURABLE LETTER OR SYMBOL (TYPE ITAPE)~~ STA. 0+242.0, LT. - "STOP" STA. 0+306.3, RT. - "STOP"

REMOVING SIGNS
AS SHOWN - 2

ADJUST ELEVATION OF VALVE BOX
- STA. 0+242.0, LT. - WSO'S (2)
STA. 0+244.0, LT. - WSO
STA. 0+307.0, Q - WSO

REHABILITATION OF DI'S, CB'S OR MH'S - CLASS I
STA. 0+201.5, LT. & RT. - DI'S
STA. 0+292.0, LT. & RT. - DI'S
STA. 0+321.5, RT. - DI

CHANGING ELEVATION OF SMH'S
STA. 0+304.5, LT.
STA. 0+310.5, LT.

CHANGING ELEVATION OF DI'S, CB'S OR MH'S
STA. 0+304.5, RT. - MH

STEEL BEAM GUARD RAIL
STA. 0+226.0 TO 0+236.0, LT.
STA. 0+242.0, LT. (BOTH SIDES OF ISLAND)
STA. 0+250.0 TO 0+255.0, LT.

~~ANCHOR FOR STEEL BEAM RAIL~~
- STA. 0+226.0, LT.
- STA. 0+242.0, LT. (ALL 4 ENDS)
- STA. 0+255.0, LT.

REMOVAL AND DISPOSAL OF GUARD RAIL
STA. 0+226.0 TO 0+236.0, LT.
STA. 0+242.0, LT. (BOTH SIDES OF ISLAND)
STA. 0+250.0 TO 0+255.0, LT.

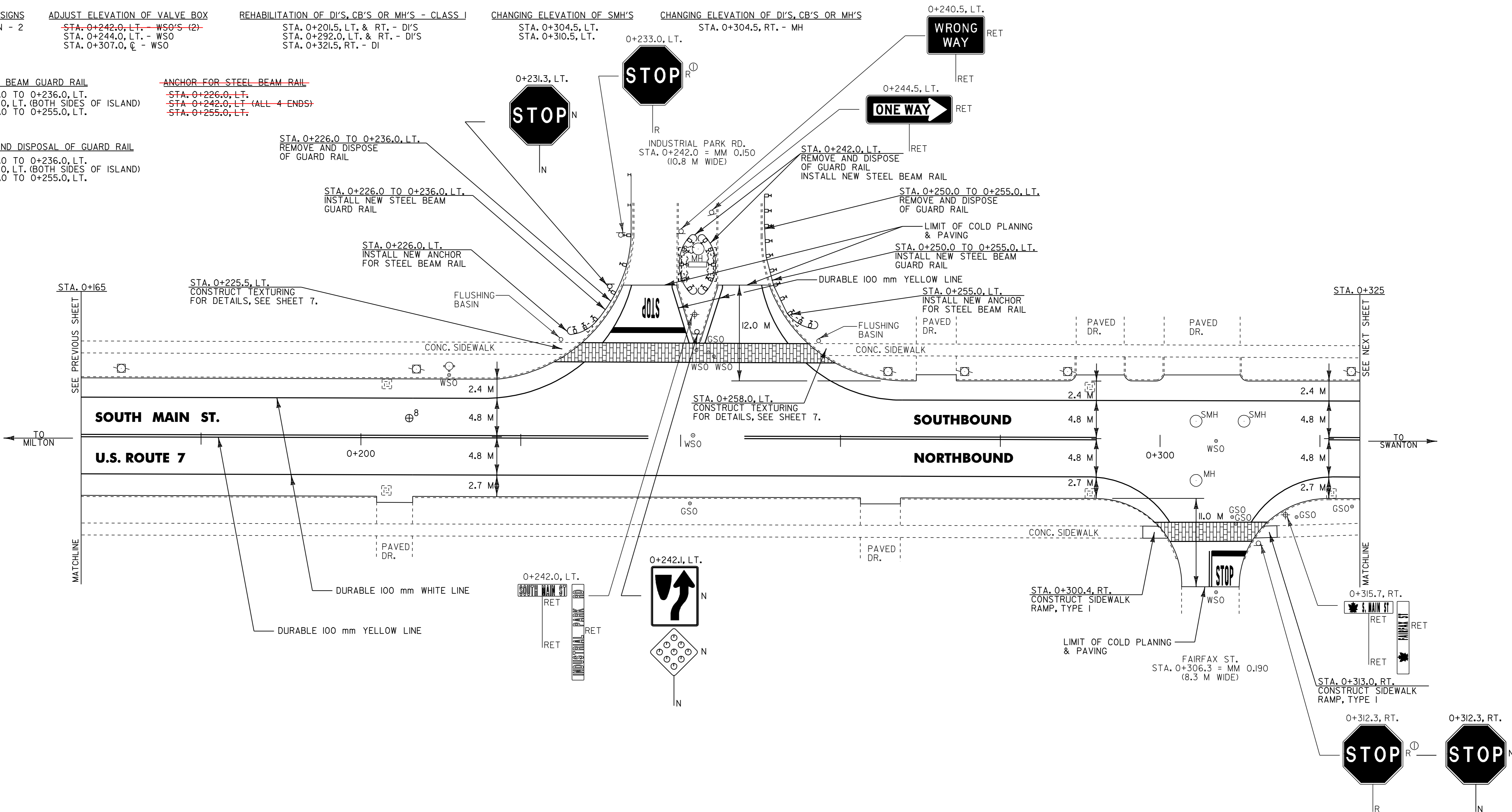

⊕ CORE LOCATION

PAVEMENT CORE DATA			
CORE #	LOCATION	DEPTH (mm)	PCC
8	0+206.0, LT.	127	NO

NOTES: 1) ALL DIMENSIONS IN MILLIMETERS EXCEPT WHERE OTHERWISE INDICATED.
2) ALL EXISTING SIGNS NOT SHOWN SHALL BE RETAINED AS DIRECTED BY THE RESIDENT ENGINEER.
3) FOR ANY TOWN HIGHWAY OR STREET DETAILS, SEE VTrans STANDARD E-193M.

LAYOUT SHEET #2

PROJECT NAME: ST. ALBANS CITY
PROJECT NUMBER: STP_9804(I)S
FILE NAME: Z:\pave\97\d150\pd150.dgn
PROJECT LEADER: JLL
DESIGNED BY: D-H
IPARM FILE NAME: pd150p02.i
PLOT DATE: 01-FEB-2006 07:4
DRAWN BY: D-H
CHECKED BY:
SHEET 20 OF 105