

210.10 COLD PLANING, BITUMINOUS CONCRETE PAVEMENT  
 STA 166+75.00 - 171+50.00

CONSTRUCT DRIVES  
 STA 167+03.00 LT (13.8' - PAVED)  
 STA 167+96.00 LT (10.9' - PAVED)  
 STA 167+98.00 RT (19.2' - PAVED)  
 STA 168+98.00 LT (21.8' - PAVED)  
 STA 169+80.00 RT (10.0' - PAVED)  
 STA 170+05.00 LT (22.3' - PAVED)  
 STA 170+56.00 RT (12.2' - PAVED)

401.10 AGGREGATE SURFACE COURSE  
 STA 167+06.00 RT (22.0' - GRAVEL DRIVE)  
 STA 169+04.00 RT (10.4' - GRAVEL DRIVE)  
 STA 171+12.00 LT (28.2' - GRAVEL DRIVE)

900.675 SPECIAL PROVISION  
 (HAND PLACED BITUMINOUS CONCRETE MATERIAL, DRIVES)  
 STA 167+06.00 RT (PAVED DRIVE APRON)  
 STA 169+04.00 RT (PAVED DRIVE APRON)  
 STA 171+12.00 LT (PAVED DRIVE APRON)

617.10 RELOCATE MAILBOX, SINGLE SUPPORT  
 STA 168+78.37 RT 170+75 RT  
 STA 168+79.95 RT  
~~STA 168+82.50 RT~~

617.12 RELOCATE MAILBOX, MULTIPLE SUPPORT  
 STA 167+73.83 RT STA 168+78 RT  
 STA 170+17.16 RT STA 171+13 RT  
~~STA 170+76.00 RT~~

NEW DRAINAGE  
 ① STA 167+15.00 LT - 166+90.00 LT  
 NEW 15" X 25' PCCSP/GPEP  
 ② STA 168+18.00 LT - 167+75.00 LT  
 NEW 15" X 43' PCCSP/GPEP  
 ③ STA 169+20.00 LT - 168+75.00 LT  
 NEW 15" X 45' PCCSP/GPEP  
 ④ STA 170+25.00 LT - 169+85.00 LT  
 NEW 15" X 40' PCCSP/GPEP

EXISTING DRAINAGE  
 ① STA 166+94.09 LT - 167+13.93 LT  
 EXISTING 18" X 20' CGMP = REMOVE  
 ② STA 167+86.59 LT - 168+06.53 LT  
 EXISTING 15" X 20' CGMP = REMOVE  
 ③ STA 168+82.53 LT - 169+12.57 LT  
 EXISTING 15" X 30' CGMP = REMOVE  
 ④ STA 169+88.96 LT - 170+18.86 LT  
 EXISTING 15" X 30' CGMP = REMOVE  
 ⑤ STA 170+91.89 LT - 171+29.67 LT  
 EXISTING 15" X 38' CPEP = REMOVE

⑥ STA 166+13 - 166+43 LT  
 NEW 15" X 30' CPEP  
 ⑦ STA 165+47 - 165+67 LT  
 NEW 15" X 20' CPEP

NEW STORMWATER TREATMENT PRACTICE  
 GRASS CHANNEL I-A  
 DISCHARGE PERMIT #6300-INDS  
 STA 167+15.00 LT - 167+75.00 LT  
 STA 168+20.00 LT - 168+75.00 LT  
 STA 169+20.00 LT - 169+85.00 LT  
 STA 170+25.00 LT - 170+80.00 LT

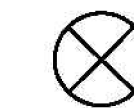

DENOTES TREE OR STUMP  
 REMOVAL PAID UNDER ITEM  
 NUMBER 201.10 CLEARING  
 AND GRUBBING, INCLUDING  
 INDIVIDUAL TREES AND  
 STUMPS

604.42 CHANGING ELEVATION OF SEWER MANHOLES  
 STA 170+94.60 RT

629.20 ADJUST ELEVATION OF VALVE BOX  
 STA 170+52.67 LT  
 170+35 LT  
 171+19 RT

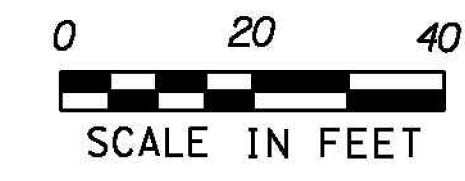
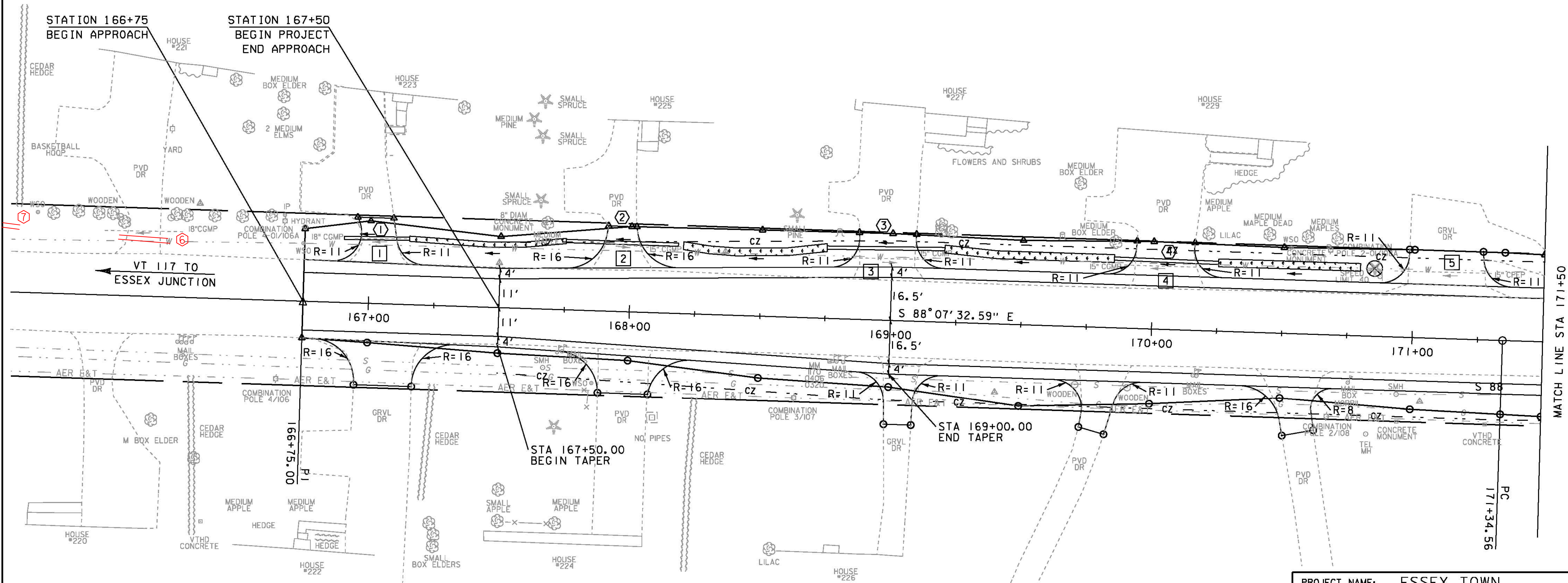
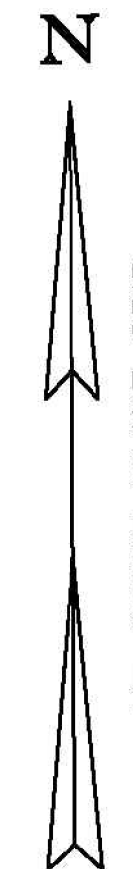

PROJECT NAME:	ESSEX TOWN	FILE NAME:	t97d002bdr.dgn	PLOT DATE:	24-AUG-2012
PROJECT NUMBER:	STP 5400 (5)	PROJECT LEADER:	J. SCHULTZ	DRAWN BY:	D. LYMAN
		DESIGNED BY:	D. LYMAN	CHECKED BY:	J. DEVLIN
		LAYOUT SHEET 1		SHEET 20	OF 64