

DURABLE 4 INCH WHITE LINE

PNR 72+15~72+45 RT, 54 LF (EL)
 PNR 72+43~72+54 RT, 35 LF (LL)
 90 DEG. PARKING SPACES - 18X35=630 LF
 75 DEG. PARKING SPACES - 19.50X95=1,853 LF
 60 DEG. PARKING SPACES - 20.80X12=250 LF
 45 DEG. PARKING SPACES - 23.50X21=494 LF
 GORE - 240 LF
 DOTTED CL - 200 LF

DURABLE 4 INCH YELLOW LINE

PNR 72+45~72+64 RT, 2X35=70 LF (DYCL)

DURABLE 8 INCH YELLOW LINE

PNR 72+56 ~ 72+97 LT & RT,
 INNER ROUNDABOUT CIRCLE, 126 LF (EL)

DURABLE 24 INCH STOP BAR

PNR 72+26 ~ 72+52 RT, 28 LF

DURABLE LETTER OR SYMBOL

PNR 71+57 ~ 72+21 RT, 6 HANDICAPPED PAVEMENT MARKING
 PNR 72+40 ~ 73+10 LT & RT, INNER ROUNDABOUT,
 3 DRIVE COUNTERCLOCKWISE ARROWS
 PNR 72+36 ~ 72+48 RT, 2 RIGHT ARROW
 PNR 72+47 ~ 72+58 RT, 2 LEFT ARROW
 PNR 73+32 ~ 74+67 RT, 2 WRONG WAY ARROW
 PNR 74+40 ~ 74+67 LT, 1 WRONG WAY ARROW

REMOVING SIGNS

16 EACH
ERECTING SALVAGED SIGNS
 13 EACH

TEMPORARY 4 INCH WHITE LINE

PNR 72+15~72+45 RT, 54 LF (EL) MARKER
 PNR 72+43~72+54 RT, 35 LF (LL)
 90 DEG. PARKING SPACES - 18X35=630 LF
 75 DEG. PARKING SPACES - 19.50X95=1,853 LF
 60 DEG. PARKING SPACES - 20.80X12=250 LF
 45 DEG. PARKING SPACES - 23.50X21=494 LF
 GORE - 240 LF
 DOTTED CL - 200 LF

TEMPORARY 4 INCH YELLOW LINE

PNR 72+45~72+64 RT, 2X35=70 LF (DYCL)

TEMPORARY 8 INCH YELLOW LINE

PNR 72+56 ~ 72+97 LT & RT,
 INNER ROUNDABOUT CIRCLE, 126 LF (EL)

TEMPORARY 24 INCH STOP BAR

PNR 72+26 ~ 72+52 RT, 28 LF

LEGEND

- [Symbol] = EXISTING SIGN
- [Symbol] = NEW SIGN
- B-B = BACK TO BACK
- CL = CHANNELIZING LINE
- DYCL = DOUBLE YELLOW CENTER LINE
- EL = EDGE LINE
- GORE = GORING
- LL = LANE LINE
- N = NEW
- R = REMOVE EXISTING SIGN AND POST
- R&N = REMOVE EXISTING POST AND PROVIDE NEW POST
- R&S = REMOVE AND SALVAGE
- RET = RETAIN AT EXISTING LOCATION
- S = SALVAGE
- TL = TURN LANE
- DNBBL = DO NOT BLOCK BOX LINE
- CH = CROSSHATCH LINE

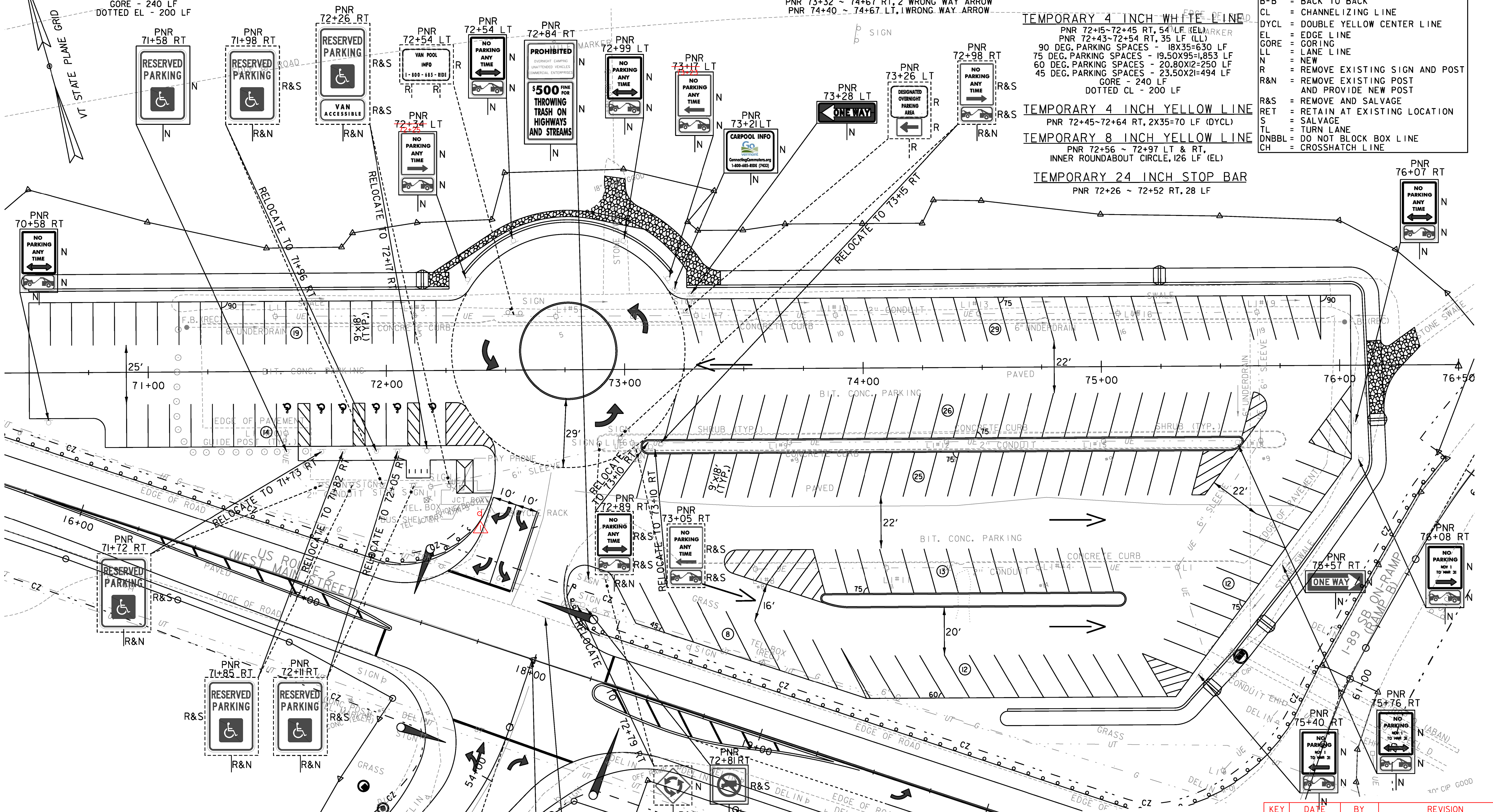

TEMPORARY LETTER OR SYMBOL

PNR 71+57 ~ 72+21 RT, 6 HANDICAPPED PAVEMENT MARKING
 PNR 72+40 ~ 73+10 LT & RT, INNER ROUNDABOUT,
 3 DRIVE COUNTERCLOCKWISE ARROWS
 PNR 72+36 ~ 72+48 RT, 2 RIGHT ARROW, 1 "ONLY" (1X4=4 EACH)
 PNR 72+47 ~ 72+58 RT, 2 LEFT ARROW, 1 "ONLY" (1X4=4 EACH)

BEGIN PROJECT CMG PARK (31)
 END PROJECT STP 0284 (17)
 POT US ROUTE 2 STA. 17+99.06
 = I-89 RAMP D STA. 54+53.65



KEY	DATE	BY	REVISION
[Symbol]	11/17/2015	VTRANS	NEW NO PARKING ANYTIME SIGN

PROJECT NAME: RICHMOND
 PROJECT NUMBER: CMG PARK (31)
 FILE NAME: z97c186pmbdr.dgn PLOT DATE: 4/30/2013
 PROJECT LEADER: JEFFREY MAXTUTIS DRAWN BY: Y.CAO/LALMY
 DESIGNED BY: J.SOBEL CHECKED BY: D.FLYNN
 PVMT. MARKING AND SIGNS LAYOUT SHEET SHEET 116 OF 133