

- LEGEND**
- WORK AREA
 - TEMPORARY TRAFFIC BARRIER
 - REFLECTORIZED PLASTIC DRUM
 - FLOW OF TRAFFIC
 - SIGN
 - IMPACT ATTENUATOR
 - DYCL DOUBLE YELLOW CENTER LINE
 - EL EDGE LINE
 - LL LANE LINE

- TEMPORARY 4 INCH WHITE LINE**
 U.S. ROUTE 2 STA. 3+50 ~ 14+50 RT, 1,100 LF (EL)
 U.S. ROUTE 2 STA. 9+03 ~ 10+80 LT, 177 LF (EL)
- TEMPORARY 4 INCH YELLOW LINE**
 U.S. ROUTE 2 STA. 3+50 ~ 6+13 LT & RT, 263 X 2 = 526 LF (DYCL)
 U.S. ROUTE 2 STA. 7+25 ~ 8+13 LT, 88 X 2 = 176 LF (DYCL)
 U.S. ROUTE 2 STA. 9+00 ~ 14+50 LT, 550 X 2 = 1,100 LF (DYCL)
- TEMPORARY 24 INCH STOP BAR**
 U.S. ROUTE 2 STA. 6+13 RT, 10 LF
 U.S. ROUTE 2 STA. 7+25 LT, 13 LF
- VEHICLE TRACKING PAD**
 U.S. ROUTE 2 STA. 6+60 RT
- ENERGY ABSORPTION ATTENUATOR**
 U.S. ROUTE 2 STA. 5+29 RT, 1EA
- REMOVAL OF EXISTING PAVEMENT MARKINGS**
 U.S. ROUTE 2 STA. 9+03 ~ 10+80 LT, 177 X 0.33 = 59 SF
 U.S. ROUTE 2 STA. 3+50 ~ 6+13 LT & RT, 263 X 2 X 0.33 = 174 SF
 U.S. ROUTE 2 STA. 7+25 LT ~ 8+13 LT, 88 X 2 X 0.33 = 58 SF
 U.S. ROUTE 2 STA. 9+00 ~ 14+50 LT, 550 X 2 X 0.33 = 363 SF

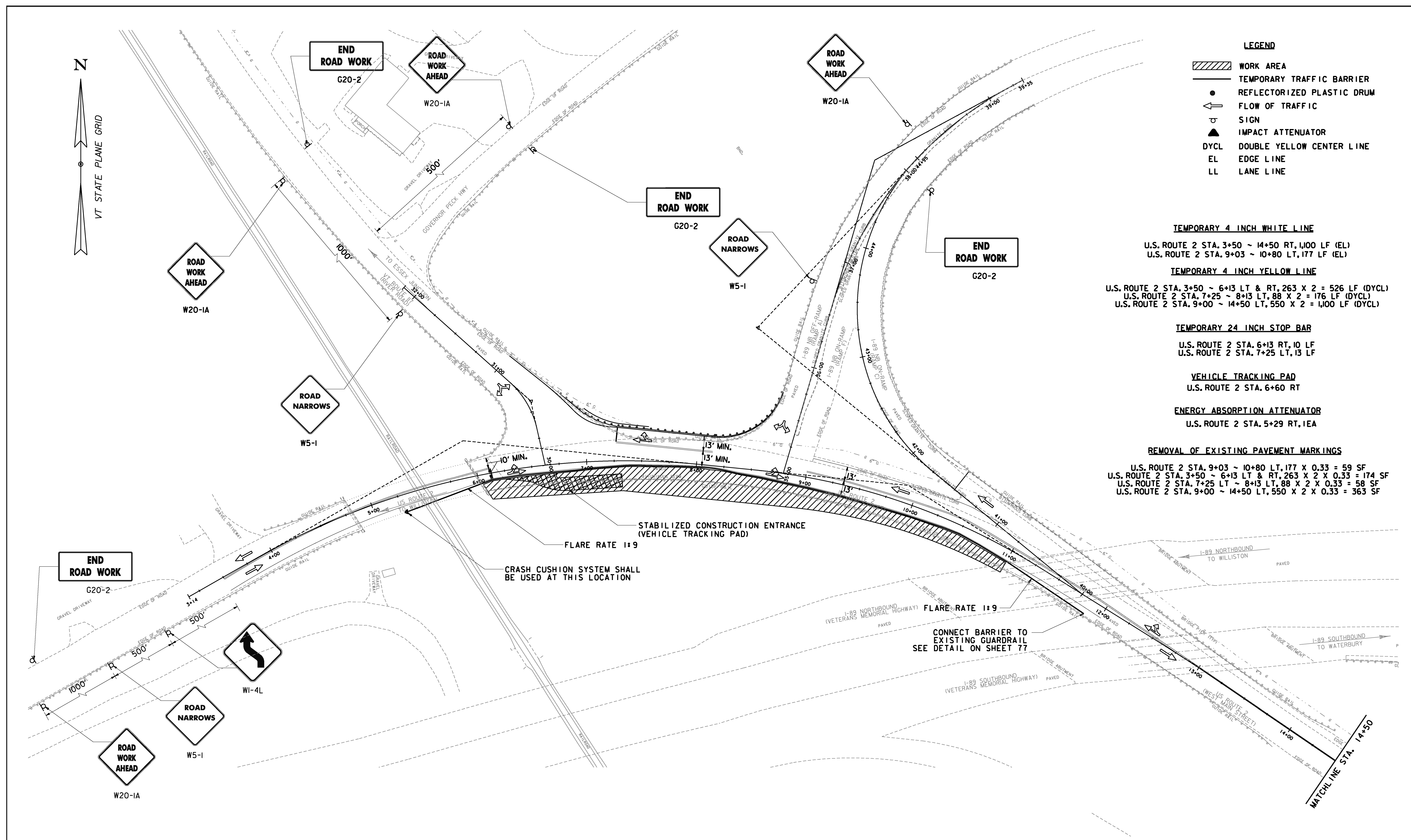

PROJECT NAME:	RICHMOND
PROJECT NUMBER:	STP 0284 (17)
FILE NAME:	z97ciB6rdwaytmp2.dgn
PROJECT LEADER:	JEFFREY MAXTUTIS
DESIGNED BY:	J.SOBEL
ROADWAY TMP PHASE 2 SHEET 1	
PLOT DATE:	4/29/2013
DRAWN BY:	Y.CAO/LALMY
CHECKED BY:	D.FLYNN
SHEET	79 OF 133