

STATE OF VERMONT AGENCY OF TRANSPORTATION

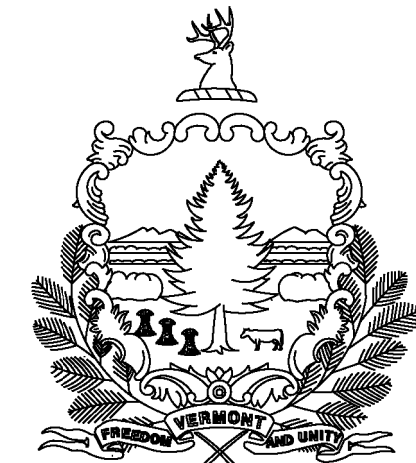

PROPOSED IMPROVEMENT TOWN OF RICHMOND COUNTY OF CHITTENDEN US ROUTE 2 (MAJOR COLLECTOR)

PROJECT STP 0284 (17)

BEGINNING AT A POINT ON US ROUTE 2 IN THE TOWN OF RICHMOND, APPROXIMATELY 62 FEET (0.012 MILE) WESTERLY OF VT ROUTE 117 AND EXTENDING EASTERLY ALONG US ROUTE 2 FOR A DISTANCE OF 1850 FEET (0.350 MILE), APPROXIMATELY 324 FEET (0.061 MILE) EASTERLY OF THE I-89 EXIT II SOUTHBOUND ON-RAMP "RAMP B".

THIS PROJECT CONSISTS OF BOX WIDENING OF US ROUTE 2, COLD PLANING AND PAVEMENT OVERLAY, PAVEMENT MARKINGS, DRAINAGE, NEW SIGNAGE, THE INSTALLATION OF NEW TRAFFIC SIGNALS AT THE INTERSECTION OF US ROUTE 2 AND VT ROUTE 117, AT THE INTERSECTION OF US ROUTE 2 AND I-89 SOUTHBOUND OFF-RAMP "RAMP D" WITH THE PARK AND RIDE ENTRANCE, AND OTHER HIGHWAY RELATED ITEMS.

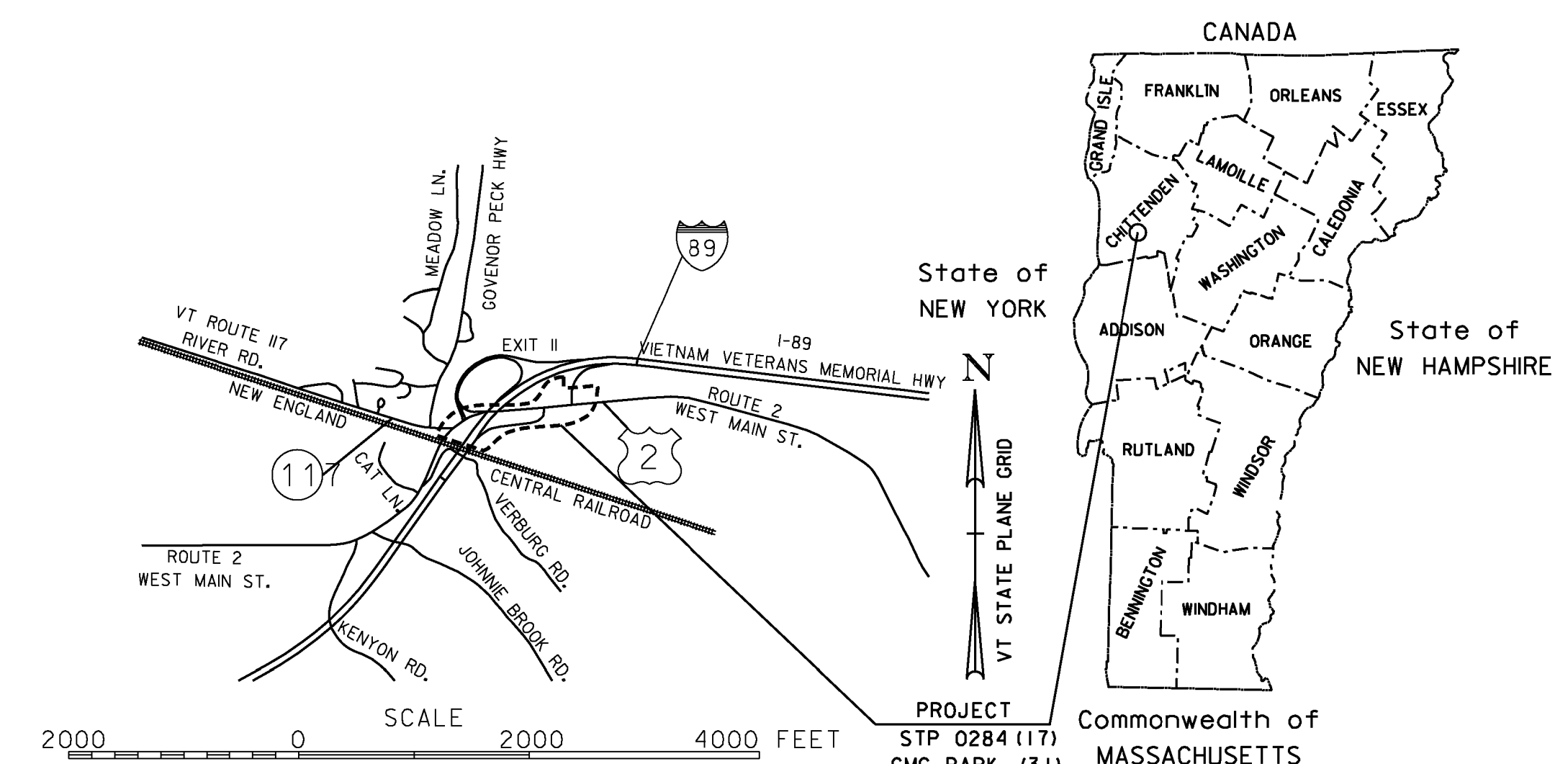

US ROUTE 2 (RAMP "B" TO RAMP "D") TRAFFIC DATA

2014 AADT	10,200
2034 AADT	12,700
2014 DHV	1,100
2034 DHV	1,400
D	75%
T	2.3%
V	25MPH (BETWEEN ROUTE 117 AND RAMP "C")
	45MPH (BETWEEN RAMP "C" AND END OF PROJECT)
2014-2034 ESAL	4,531,000 (RAMP F TO VT 117)
2014-2054 ESAL	11,851,000 (RAMP F TO VT 117)

VT ROUTE 117 (BETWEEN GOVERNOR PECK HIGHWAY & US ROUTE 2) TRAFFIC DATA

2014 AADT	7,500
2034 AADT	9,300
2014 DHV	930
2034 DHV	1,100
D	61%
T	6.7%
V	45MPH
2014-2034 ESAL	3,659,000
2014-2054 ESAL	9,591,000

I-89 EXIT 11 (RAMP "A") TRAFFIC DATA

2014 AADT	2,400
2034 AADT	3,000
2014 DHV	370
2034 DHV	440
D	100%
T	6.4%
V	25MPH
2014-2034 ESAL	977,000
2014-2054 ESAL	2,407,000

I-89 EXIT 11 (RAMP "B") TRAFFIC DATA

2014 AADT	2,100
2034 AADT	2,600
2014 DHV	330
2034 DHV	390
D	100%
T	7.0%
V	30MPH
2014-2034 ESAL	931,000
2014-2054 ESAL	2,272,000

I-89 EXIT 11 (RAMP "C") TRAFFIC DATA

2014 AADT	2,200
2034 AADT	2,800
2014 DHV	340
2034 DHV	410
D	100%
T	7.0%
V	25MPH
2014-2034 ESAL	835,000
2014-2054 ESAL	2,037,000

I-89 EXIT 11 (RAMP "D") TRAFFIC DATA

2014 AADT	3,500
2034 AADT	4,300
2014 DHV	590
2034 DHV	730
D	100%
T	7.1%
V	20MPH
2014-2034 ESAL	947,000
2014-2054 ESAL	2,289,000

I-89 EXIT 11 (RAMP "F") TRAFFIC DATA

2014 AADT	1,100
2034 AADT	1,300
2014 DHV	270
2034 DHV	320
D	100%
T	8.3%
V	25MPH
2014-2034 ESAL	438,000
2014-2054 ESAL	1,044,000

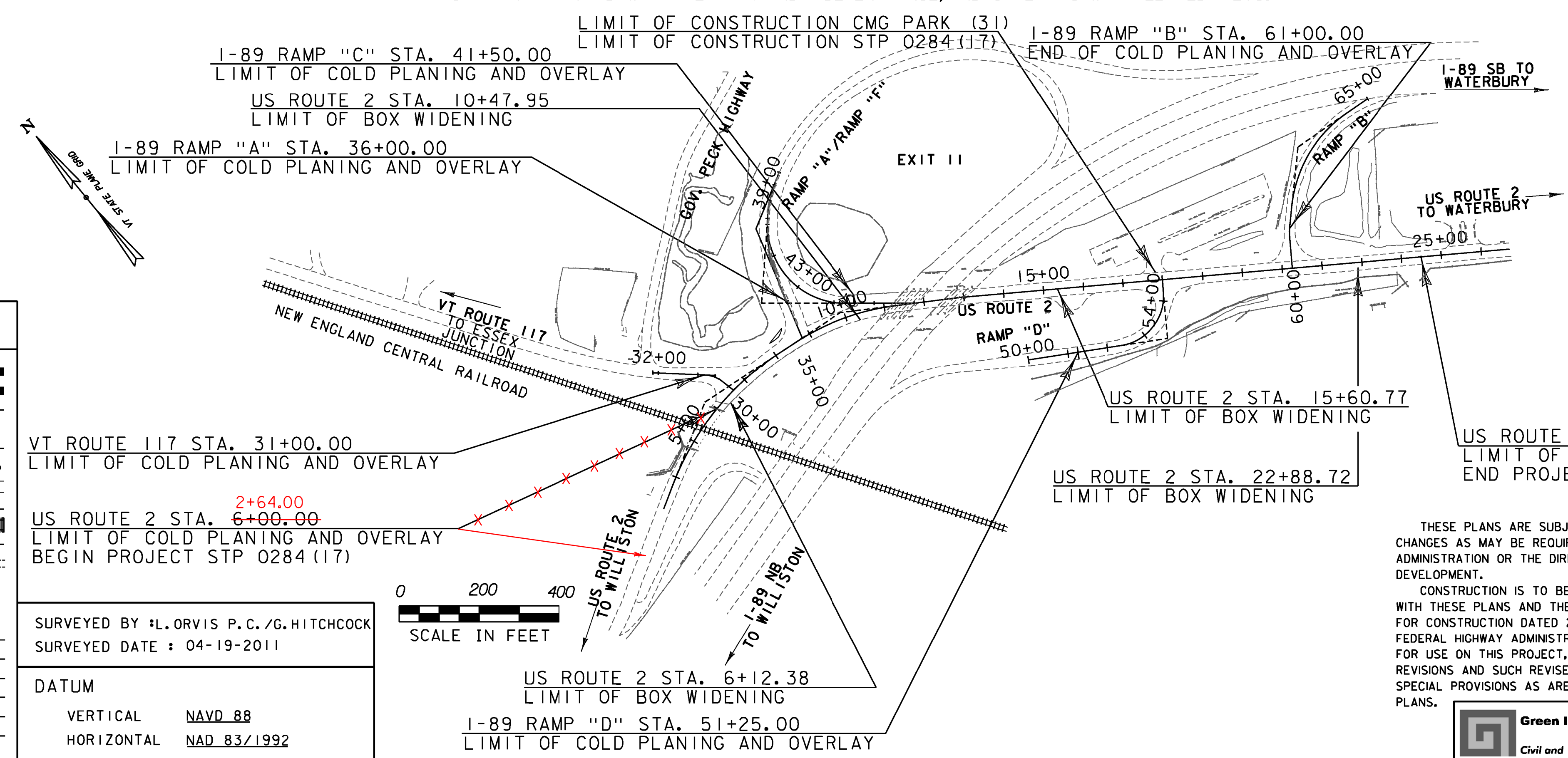

BITUMINOUS CONCRETE PAVEMENT SUPER PAVE MIXTURE DESIGN CRITERIA	
DESIGN LIFE ESAL (DESIGN LANE)	4,531,000
DESIGN NUMBER OF GYRATIONS	65
PERFORMANCE GRADED ASPHALT BINDER	SEE SUBSECTION 490.03 (b)

QUALITY ASSURANCE PROGRAM: LEVEL I

CONVENTIONAL SYMBOLS

COUNTY LINE	
TOWN LINE	
LIMITS OF ACCESS	
POINT OF ACCESS	
FENCE LINE	
STONE WALL	
TRAVELED WAY	
GUARD RAIL	
RAILROAD	
SURVEY LINE	
CULVERT	
POWER POLE	
TELEPHONE POLE	
TREES	
CONTROL OF ACCESS	
PROPERTY LINE	
R.O.W. TAKING LINE	
SLOPE RIGHTS	
TOP OF CUT	
TOE OF SLOPE	

SURVEYED BY: L. ORVIS P.C./G. HITCHCOCK
SURVEYED DATE: 04-19-2011

DATUM

VERTICAL: NAVD 88
HORIZONTAL: NAD 83/1992

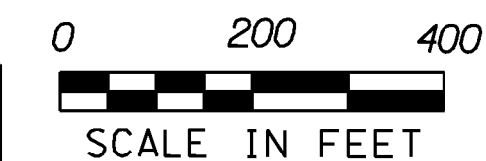

THESE PLANS ARE SUBJECT TO SUCH ENGINEERING CHANGES AS MAY BE REQUIRED BY THE FEDERAL HIGHWAY ADMINISTRATION OR THE DIRECTOR OF PROGRAM DEVELOPMENT.

CONSTRUCTION IS TO BE CARRIED ON IN ACCORDANCE WITH THESE PLANS AND THE STANDARD SPECIFICATIONS FOR CONSTRUCTION DATED 2011, AS APPROVED BY THE FEDERAL HIGHWAY ADMINISTRATION ON JULY 20, 2011 FOR USE ON THIS PROJECT, INCLUDING ALL SUBSEQUENT REVISIONS AND SUCH REVISED SPECIFICATIONS AND SPECIAL PROVISIONS AS ARE INCORPORATED IN THESE PLANS.



PROJECT MANAGER: JOSHUA SCHULTZ, P.E.

PROJECT NAME: RICHMOND

PROJECT NUMBER: STP 0284 (17)

SHEET 33 OF 133 SHEETS