

- DURABLE 4 INCH WHITE LINE**
  - VT RTE 117 31+00 RT ~ 1-89 NB OFF-RAMP (RAMP A) 35+30 LT, 255 LF (EL)
  - ~~U.S. ROUTE 2 5+96 LT ~ ROUTE 117 31+00 LT, 114 LF (EL)~~
  - ~~U.S. ROUTE 2 6+05 ~ 10+00 RT, 385 LF (EL)~~
  - U.S. ROUTE 2 7+16 ~ 8+41 LT, 126 LF (TL)
  - U.S. ROUTE 2 7+29 ~ 7+71 RT, 56 LF (DOTTED TL)
  - U.S. ROUTE 2 7+71 ~ 8+53 RT, 85 LF (TL)
  - U.S. ROUTE 2 8+50 ~ 9+00 LT, 462 LF (CH)
  - U.S. ROUTE 2 9+00 ~ 10+00 LT, 100 LF (EL)
- DURABLE 4 INCH YELLOW LINE**
  - VT RTE 117 30+34 ~ 31+00 LT & RT, 2X58=116 LF (DYCL)
  - ~~U.S. ROUTE 2 6+00 ~ 6+19 LT & RT, 2X19= 38 LF (DYCL)~~
  - U.S. ROUTE 2 7+12 ~ 7+75 LT & RT, 4X65=260 LF (DYCL)
  - U.S. ROUTE 2 7+75 ~ 8+53 LT & RT, 2X78=156 LF (DYCL)
  - U.S. ROUTE 2 9+06 ~ 10+00 LT & RT, 4X90=360 LF (DYCL)
- DURABLE 6 INCH WHITE LINE**
  - 1-89 NB OFF-RAMP (RAMP A) 35+30 ~ 36+00 LT, 80 LF (EL)
  - 1-89 NB ON-RAMP (RAMP F) 35+12 ~ 35+53 RT, 40 LF (EL)
- DURABLE 6 INCH YELLOW LINE**
  - 1-89 NB OFF-RAMP (RAMP A) 35+26 ~ 36+00 LT, 75 LF (EL)
  - 1-89 NB ON-RAMP (RAMP F) 35+26 ~ 35+52 RT, 30 LF (EL)
- DURABLE 8 INCH WHITE LINE**
  - U.S. ROUTE 2 8+50 ~ 9+00 LT, 148 LF (DNBBL)
- DURABLE 8 INCH YELLOW LINE**
  - U.S. ROUTE 2 7+12 ~ 7+75 RT, 25 LF (GORE)
  - U.S. ROUTE 2 9+06 ~ 10+00 RT, 50 LF (GORE)
- DURABLE 24 INCH STOP BAR**
  - VT RTE 117 30+34 LT, 24 LF
  - U.S. ROUTE 2 6+19 RT, 12 LF
  - U.S. ROUTE 2 7+16 LT, 25 LF
  - 1-89 NB OFF-RAMP (RAMP A) 35+30 LT, 31LF
- DURABLE LETTER OR SYMBOL**
  - U.S. ROUTE 2 7+20 ~ 7+71 LT, RIGHT ARROW, "ONLY" (1x4=4 EACH)
  - U.S. ROUTE 2 7+72 ~ 7+90 RT, LEFT ARROW
  - U.S. ROUTE 2 8+20 ~ 8+40 LT, RIGHT ARROW
  - U.S. ROUTE 2 8+20 ~ 8+40 RT, LEFT ARROW
- DELINEATORS WITH STEEL POST**
  - 1-89 OFF-RAMP (RAMP A) STA 35+37 LT (1 EACH)
  - REMOVE, STACK AND REINSTALL EACH
- REMOVING SIGNS**
  - 32 EACH
- ERECTING SALVAGED SIGNS**
  - 51 EACH
- TEMPORARY 4 INCH WHITE LINE**
  - VT RTE 117 31+00 RT ~ 1-89 NB OFF-RAMP (RAMP A) 35+30 LT, 255 LF (EL)
  - ~~U.S. ROUTE 2 5+96 LT ~ ROUTE 117 31+00 LT, 114 LF (EL)~~
  - ~~U.S. ROUTE 2 6+05 ~ 10+00 RT, 385 LF (EL)~~
  - U.S. ROUTE 2 7+16 ~ 8+41 LT, 126 LF (TL)
  - U.S. ROUTE 2 7+29 ~ 7+71 RT, 56 LF (DOTTED TL)
  - U.S. ROUTE 2 7+71 ~ 8+53 RT, 85 LF (TL)
  - U.S. ROUTE 2 8+50 ~ 9+00 LT, 462 LF (CH)
  - U.S. ROUTE 2 9+00 ~ 10+00 LT, 100 LF (EL)
- TEMPORARY 4 INCH YELLOW LINE**
  - VT RTE 117 30+34 ~ 31+00 LT & RT, 2X58=116 LF (DYCL)
  - ~~U.S. ROUTE 2 6+00 ~ 6+19 LT & RT, 2X19= 38 LF (DYCL)~~
  - U.S. ROUTE 2 7+12 ~ 7+75 LT & RT, 4X65=260 LF (DYCL)
  - U.S. ROUTE 2 7+75 ~ 8+53 LT & RT, 2X78=156 LF (DYCL)
  - U.S. ROUTE 2 9+06 ~ 10+00 LT & RT, 4X90=360 LF (DYCL)
- TEMPORARY 8 INCH WHITE LINE**
  - U.S. ROUTE 2 8+50 ~ 9+00 LT, 148 LF (DNBBL)

LEGEND	
	= EXISTING SIGN
	= NEW SIGN
B-B	= BACK TO BACK
CL	= CHANNELIZING LINE
DYCL	= DOUBLE YELLOW CENTER LINE
EL	= EDGE LINE
GORE	= GORING
LL	= LANE LINE
N	= NEW
R	= REMOVE EXISTING SIGN AND POST
R&N	= REMOVE EXISTING POST AND PROVIDE NEW POST
R&S	= REMOVE AND SALVAGE
RET	= RETAIN AT EXISTING LOCATION
S	= SALVAGE
TL	= TURN LANE
DNBBL	= DO NOT BLOCK BOX LINE
CH	= CROSSHATCH LINE (5' SPACING)

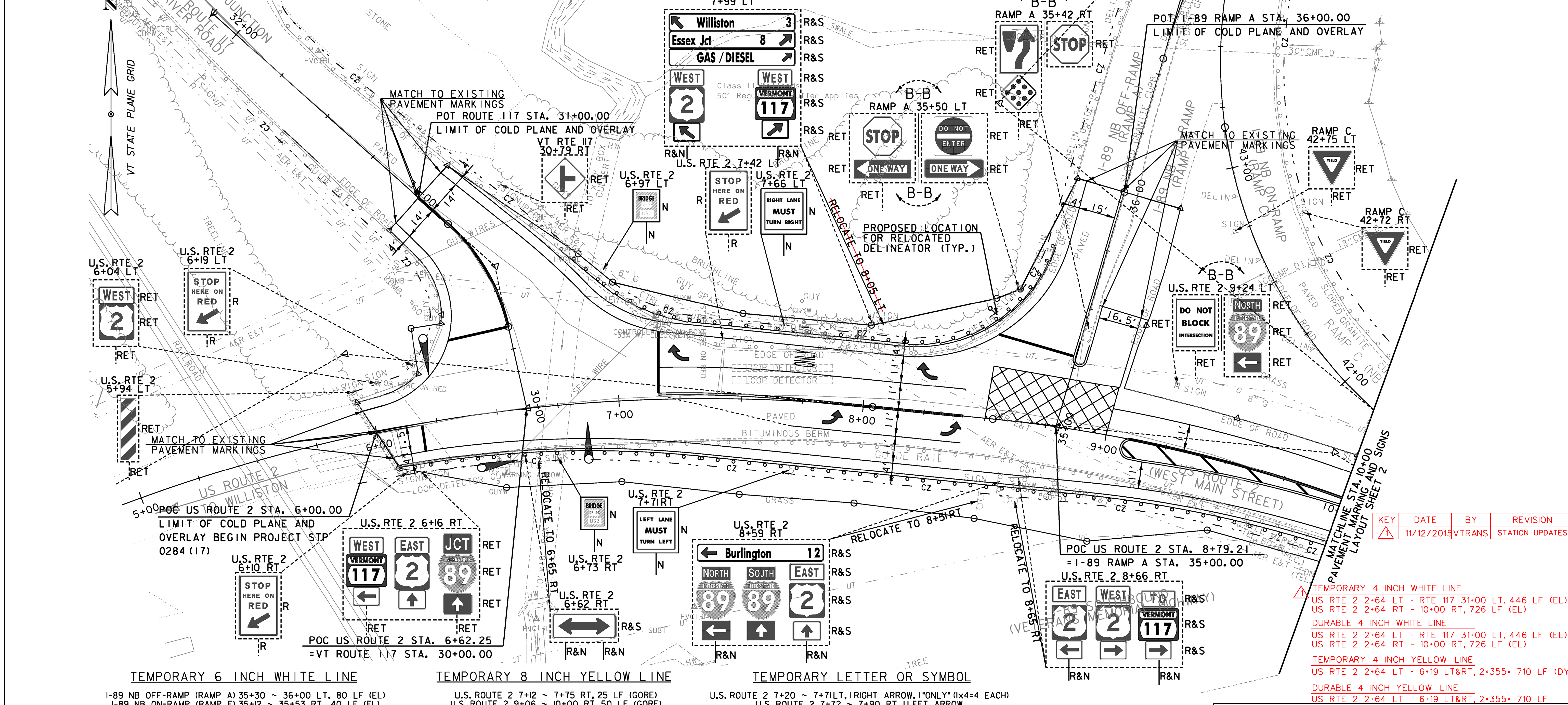

KEY	DATE	BY	REVISION
	11/12/2015	VTTRANS	STATION UPDATES

- TEMPORARY 4 INCH WHITE LINE**
  - US RTE 2 2+64 LT - RTE 117 31+00 LT, 446 LF (EL)
  - US RTE 2 2+64 RT - 10+00 RT, 726 LF (EL)
- DURABLE 4 INCH WHITE LINE**
  - US RTE 2 2+64 LT - RTE 117 31+00 LT, 446 LF (EL)
  - US RTE 2 2+64 RT - 10+00 RT, 726 LF (EL)
- TEMPORARY 4 INCH YELLOW LINE**
  - US RTE 2 2+64 LT - 6+19 LT&RT, 2+355+ 710 LF (DYCL)
- DURABLE 4 INCH YELLOW LINE**
  - US RTE 2 2+64 LT - 6+19 LT&RT, 2+355+ 710 LF

<b>TEMPORARY 6 INCH WHITE LINE</b> 1-89 NB OFF-RAMP (RAMP A) 35+30 ~ 36+00 LT, 80 LF (EL) 1-89 NB ON-RAMP (RAMP F) 35+12 ~ 35+53 RT, 40 LF (EL)	<b>TEMPORARY 8 INCH YELLOW LINE</b> U.S. ROUTE 2 7+12 ~ 7+75 RT, 25 LF (GORE) U.S. ROUTE 2 9+06 ~ 10+00 RT, 50 LF (GORE)	<b>TEMPORARY LETTER OR SYMBOL</b> U.S. ROUTE 2 7+20 ~ 7+71 LT, RIGHT ARROW, "ONLY" (1x4=4 EACH) U.S. ROUTE 2 7+72 ~ 7+90 RT, LEFT ARROW U.S. ROUTE 2 8+20 ~ 8+40 LT, RIGHT ARROW U.S. ROUTE 2 8+20 ~ 8+40 RT, LEFT ARROW	<b>PROJECT NAME:</b> RICHMOND <b>PROJECT NUMBER:</b> STP 0284 (17) <b>FILE NAME:</b> z97cl86pmbdr.dgn <b>PROJECT LEADER:</b> JEFFREY MAXTUTIS <b>DESIGNED BY:</b> J.SOBEL <b>PVMT. MARKING AND SIGNS LAYOUT SHEET 1</b>	<b>SCALE IN FEET</b> 	<b>PLOT DATE:</b> 4/30/2013 <b>DRAWN BY:</b> Y.CAO/1ALMY <b>CHECKED BY:</b> D.FLYNN <b>SHEET 56 OF 133</b>
---	--	--	--	--------------------------	---