

**REMOVE EXISTING PAVEMENT
(COMMON EXCAVATION)**
 US RTE 2 10+00.0 RT - US RTE 2 10+48.0 RT
COLD PLANING, BITUMINOUS PAVEMENT
 US RTE 2 10+00.0 - US RTE 2 15+00.0

STEEL BEAM GUARDRAIL, GALVANIZED
 US RTE 2 10+00.0 RT - US RTE 2 10+87.1 RT
 US RTE 2 13+83.0 RT - US RTE 2 15+00.0 RT
 US RTE 2 14+08.8 LT - US RTE 2 15+00.0 LT

REPLACE GUARDRAIL BEAM UNIT
 US RTE 2 11+03.6 LT - US RTE 2 13+23.5 LT
REMOVAL AND DISPOSAL OF GUARDRAIL
 US RTE 2 10+00.0 RT - US RTE 2 10+95.1 RT
 US RTE 2 13+83.0 RT - US RTE 2 13+95.5 RT
 US RTE 2 13+93.8 LT - US RTE 2 14+34.5 LT
REMOVAL AND DISPOSAL OF GUIDE POST
 US RTE 2 13+98.5 - US RTE 2 15+00.0 RT

EXISTING DRAINAGE
 US RTE 2 14+40.4 LT - US RTE 2 14+76.3 LT
 EXISTING PIPE - RETAIN
 EXISTING DI@ 14+40.4 LT - RETAIN

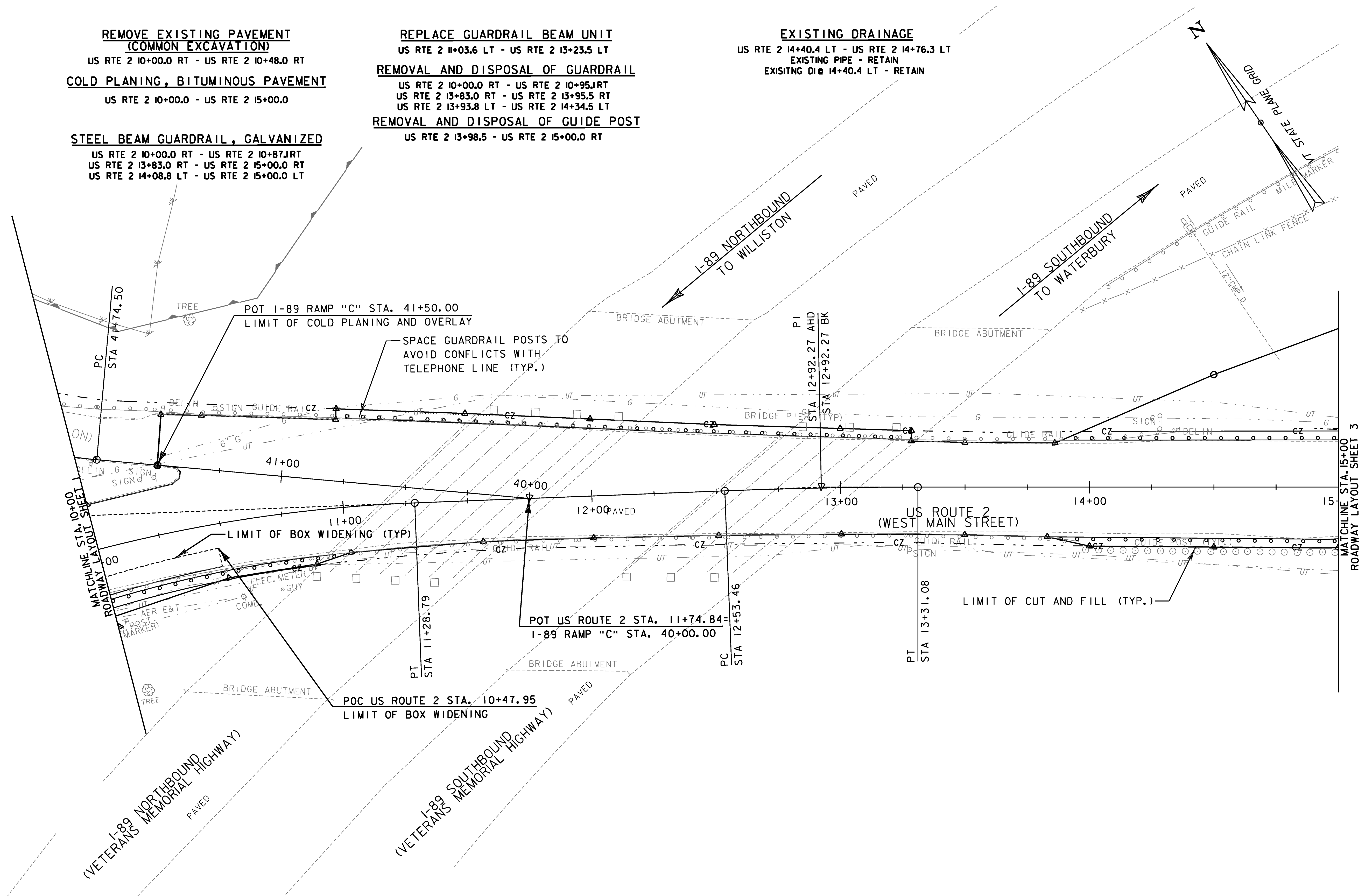

MATCHLINE STA. 10+00
ROADWAY LAYOUT SHEET 1

MATCHLINE STA. 15+00
ROADWAY LAYOUT SHEET 3

PROJECT NAME:	RICHMOND	PLOT DATE:	4/26/2013
PROJECT NUMBER:	STP 0284 (17)	DRAWN BY:	N. BOSAN
FILE NAME:	z97c186bdr.dgn	CHECKED BY:	E. ATKINS
PROJECT LEADER:	ERIK ATKINS	SHEET	50 OF 133
DESIGNED BY:	T. BIGELOW	ROADWAY LAYOUT SHEET 2	

