

646.40 DURABLE 4" WHITE LINE (THERMOPLASTIC)  
 (ALL LINES WILL INCLUDE EDGE LINE BREAKS AND  
 RADIUS FOR TOWN HIGHWAYS)

NEW HAVEN:  
 STA. 165+00.0 - STA. 181+00.0 LT & RT

646.41 DURABLE 4" YELLOW LINE (THERMOPLASTIC)  
 (ALL LINES WILL INCLUDE C/L BREAKS FOR  
 TOWN HIGHWAYS) S=SOLID, D=DASHED

NEW HAVEN: LT C RT  
 STA. 165+00.0 - STA. 168+50.0 S - D  
 STA. 168+50.0 - STA. 174+50.0 - D -  
 STA. 174+50.0 - STA. 181+00.0 D - S

675.50 REMOVING SIGNS  
 AS SHOWN - 2

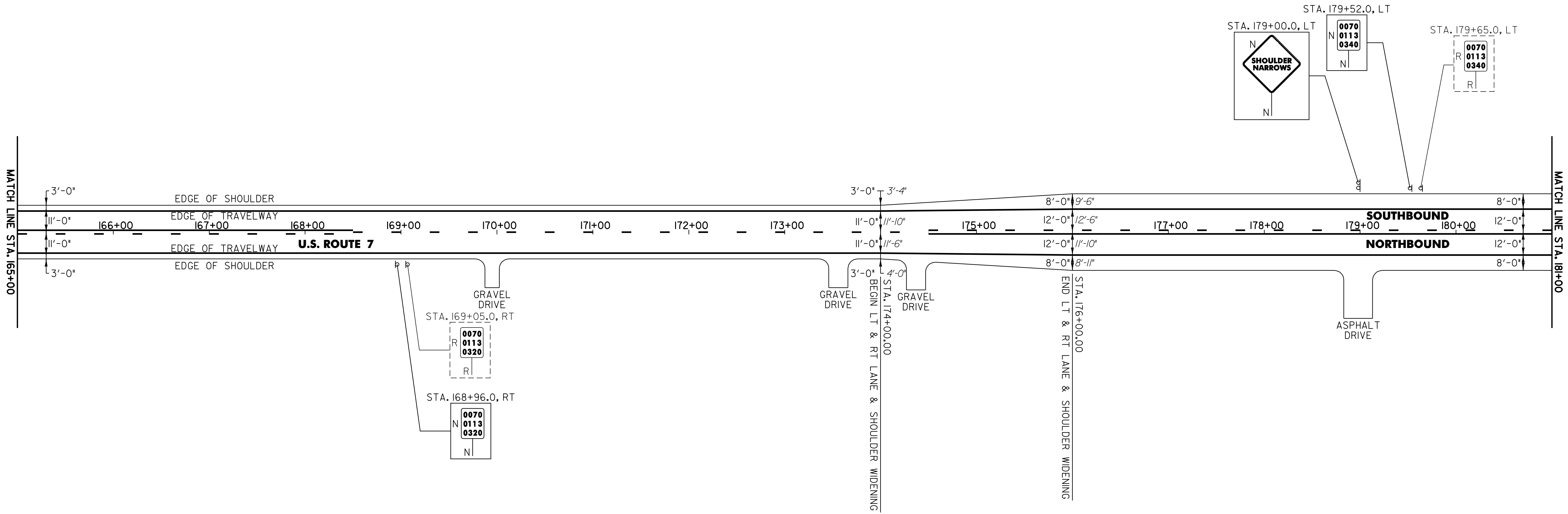

NOT TO SCALE

**SIGN LEGEND**  
 R = REMOVE  
 S = SALVAGE  
 N = NEW  
 RET = RETAIN  
 B-B = BACK TO BACK  
 EXISTING = -----  
 NEW = \_\_\_\_\_

**PROJECT LAYOUT SHEET #18**

PROJECT NAME: MIDDLEBURY - NEW HAVEN  
 PROJECT NUMBER: NH 9813(1)S

FILE NAME: p97b166.dgn  
 PROJECT LEADER: D.E.G.  
 DESIGNED BY: J.S.P.  
 IPARM FILE: pbl66118.i

PLOT DATE: \$DATE\$  
 DRAWN BY: C.A.K.  
 CHECKED BY: D.W.E.  
 SHEET 27 OF 63