

646.4 DURABLE 100 mm YELLOW LINE
 (ALL LINES WILL INCLUDE C/L BREAKS FOR TOWN HIGHWAYS) S=SOLID, D=DASHED
 MENDON:
 STA. 2+860.000 - STA. 3+400.000 LT S C RT S

646.40 DURABLE 100 mm WHITE LINE
 (ALL LINES WILL INCLUDE EDGE LINE BREAKS AND RADIUS FOR TOWN HIGHWAYS)
 MENDON:
 STA. 2+860.000 - STA. 3+400.000 LT & RT
 STA. 2+860.000 - STA. 3+400.000 DASHED LINE 3.6 m RT

675.50 REMOVING SIGNS
 AS SHOWN - 3

646.6 TEMPORARY 100 mm YELLOW LINE
 (ALL LINES WILL INCLUDE C/L BREAKS FOR TOWN HIGHWAYS) S=SOLID, D=DASHED
 MENDON:
 STA. 2+860.000 - STA. 3+400.000 LT S C RT S

646.60 TEMPORARY 100 mm WHITE LINE
 (ALL LINES WILL INCLUDE EDGE LINE BREAKS AND RADIUS FOR TOWN HIGHWAYS)
 MENDON:
 STA. 2+860.000 - STA. 3+400.000 LT & RT
 STA. 2+860.000 - STA. 3+400.000 DASHED LINE 3.6 m RT

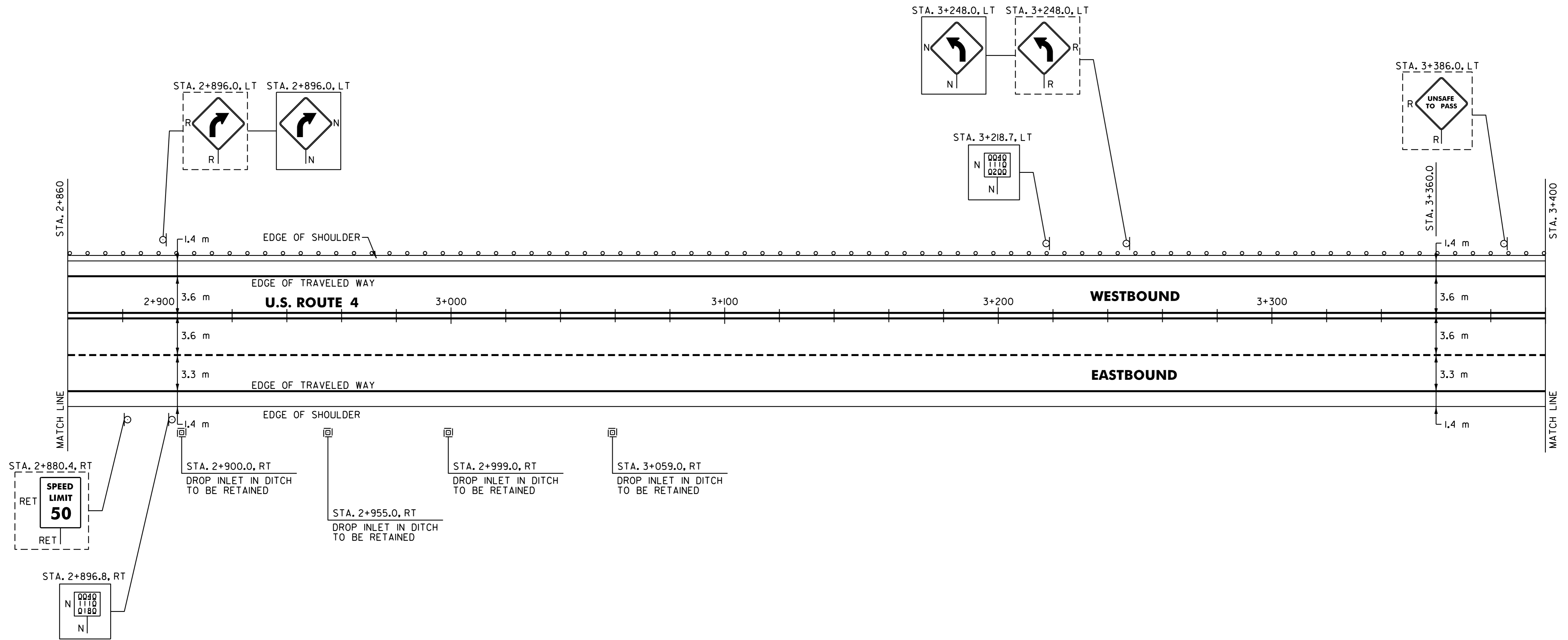

BUILT AS DESIGNED

**ARCHIVED
IN DPR**

DATUM
 VERTICAL N/A
 HORIZONTAL N/A

621.20 STEEL BEAM GUARDRAIL
 MENDON:
 STA. 2+860.0 - STA. 3+400.0 LT (540.0 m)

621.80 REMOVAL AND DISPOSAL OF GUARDRAIL
 MENDON:
 STA. 2+860.0 - STA. 3+400.0 LT (540.0 m)

SIGN LEGEND
 R= REMOVE
 S= SALVAGE
 N= NEW
 RET= RETAIN
 B-B= BACK TO BACK
 EXISTING= -----
 NEW= -----

PAVING PROJECT LAYOUT	SURVEYED BY <u>N/A</u> DATE <u>N/A</u>
	DRAWN BY <u>C.A.K.</u> DATE <u>11/99</u>
	SQUAD LEADER <u>I.P.K.</u>
	DESIGN FILE NO. <u>z pave / 97bl60 / pbl60.dgn</u>
	IPARM FILE <u>pbl60p10.i</u> DATE <u>N/A</u> PLOTTED <u>N/A</u>
PROJ. NAME <u>BUJLAND - KILLINGTON</u>	
PROJ. NO. <u>NH_9809(IIS)</u>	
SHEET <u>19</u> OF <u>83</u> SHEETS <u> </u>	