

INDEX OF SHEETS

- 1 TITLE SHEET
- 2 PROJECT TYPICAL SHEET
- 3 PAVING DETAILS AND PAVEMENT JOINT DETAIL SHEET
- 4 SHOULDER RECONSTRUCTION DETAIL SHEET
- 5-6 QUANTITY SHEETS
- 7-8 ITEM DETAIL SUMMARY SHEETS
- 9 DITCH CLEANING DETAIL SHEET
- 10-41 LAYOUT SHEETS
- 42-43 T-TURN LANE DETAIL SHEETS
- 44 T-82 INTERSECTION DETAIL SHEET
- 45 U-TURN JUG HANDLE DETAIL SHEET
- 46-78 TRAFFIC SIGN SUMMARY SHEETS
- 79-80 TRAFFIC SIGN DETAIL SHEETS
- 81-82 BRIDGE DETAIL SHEETS
- 83 CONSTRUCTION APPROACH SIGNING & GUARDRAIL DETAIL SHEET

VAOT STANDARDS

C-1M	TREATED TIMBER CURB	06-13-97
D-6M	REINFORCED CONCRETE DROP INLET WITH GRATE FOR USE IN DITCHES	06-13-97
D-6M	REINFORCED CONCRETE DROP INLET	06-13-97
D-9M	REINFORCED CONCRETE DROP INLET	06-13-97
D-11M	STEEL GRATE CAST IRON GRATE TYPE A, CAST IRON COVER	06-13-97
D-15M	CAST IRON GRATE WITH FRAME, TYPE D	06-13-97
E-100M	CONSTRUCTION APPROACH SIGNS	06-13-97
E-101M	CONSTRUCTION SIGN DETAILS	06-13-97
E-102M	CONSTRUCTION SIGN DETAILS	06-13-97
E-102AM	CONSTRUCTION SIGN DETAILS	06-13-97
E-103M	MAINLINE TRAFFIC CONTROL DIVIDED HIGHWAY ONE LANE CLOSED	09-24-98
E-106M	TRAFFIC CONTROL MISCELLANEOUS DETAILS	06-13-97
E-107M	DELINEATION, BARRICADES AND DETOURS FOR CONSTRUCTION AREAS	06-13-97
E-107AM	BREAKAWAY BARRICADE DETAILS	06-13-97
E-108M	LONGITUDINAL DROP OFFS	06-13-97
E-110M	MAJOR MAINTENANCE OPERATION LANE CLOSURE	06-13-97
E-111M	MAINTENANCE OPERATION APPROACH SIGNS	02-17-98
E-121M	STANDARD SIGN PLACEMENT CONVENTIONAL ROAD	06-13-97
E-123M	GUIDE SIGN PLACEMENT MISCELLANEOUS DETAILS	06-13-97
E-124M	TOWN LINE SIGNS	02-02-98
E-128AM	VILLAGE SIGNS A-M	06-13-97
E-128BM	VILLAGE SIGNS N-W	06-13-97
E-134M	BRIDGE NUMBER PLAQUE	06-13-97
E-136AM	US ROUTE MARKER SIGN DETAILS	06-13-97
E-136BM	STATE ROUTE MARKER SIGN DETAILS	06-13-97
E-138M	REFERENCE PLAQUE DETAILS STATE AND TOWN HIGHWAYS	06-13-97
E-140M	REGULATORY SIGN DETAILS	06-13-97
E-141M	REGULATORY SIGN DETAILS	06-13-97
E-142M	REGULATORY SIGN DETAILS	06-13-97
E-143M	REGULATORY SIGN DETAILS	06-13-97
E-144M	REGULATORY SIGN DETAILS	03-29-99
E-145AM	REGULATORY SIGN DETAILS	06-13-97
E-150M	WARNING SIGN DETAILS	06-13-97
E-151M	WARNING SIGN DETAILS	06-13-97
E-152M	WARNING SIGN DETAILS	06-13-97
E-153M	WARNING SIGN DETAILS	06-13-97
E-154M	WARNING SIGN DETAILS	06-13-97
E-155M	WARNING SIGN DETAILS	06-13-97
F-160M	FLANGED CHANNEL STEEL SIGN POST	06-13-97
E-162M	TUBULAR ALUMINUM SIGN POST	06-13-97
E-173M	PULLBOXES AND JUNCTION BOXES	06-13-97
E-175M	POWER DROP STANCHIONS	06-13-97
E-191M	PAVEMENT MARKING DETAILS	06-13-97
E-192M	PAVEMENT MARKING DETAILS	12-28-98
E-193M	PAVEMENT MARKING DETAILS	06-13-97
G-1M	STEEL BEAM GUARDRAIL WITH STEEL POSTS	06-13-97
G-1DM	ANCHOR FOR STEEL BEAM GUARDRAIL	06-13-97
G-4M	YIELDING MARKER POSTS	06-13-97
G-19M	GENERIC GRADING PLAN FOR GUARDRAIL TERMINALS	10-21-98
J-3M	MAILBOX SUPPORT DETAIL	06-13-97

STATE OF VERMONT
AGENCY OF TRANSPORTATION



PROPOSED IMPROVEMENT
TOWNS OF RUTLAND/MENDON/
KILLINGTON
COUNTY OF RUTLAND
U.S. ROUTE 4

BEGINNING AT THE CITY OF RUTLAND / RUTLAND TOWN LINE AT
MILE MARKER 0.000 = STA. 0+000.000 AND EXTENDING EASTERLY ALONG U.S. ROUTE 4 FOR A
DISTANCE OF 15 929.287 m (9.898 MILES) TO A POINT IN KILLINGTON AT MILE MARKER 2.728 = STA. 4+390.290.

LENGTH OF ROADWAY 15 929.287 m (9.898 MILES)
LENGTH OF PROJECT 15 929.287 m (9.898 MILES)

WORK TO BE PERFORMED UNDER THIS PROJECT INCLUDES COLD PLANING, RESURFACING
WITH A SHIM / LEVELING COURSE AND WEARING COURSE; SHOULDER RECONSTRUCTION;
NEW PAVEMENT MARKINGS; NEW SIGNS; GUARDRAIL IMPROVEMENTS; DRAINAGE IMPROVEMENTS
AND INCIDENTAL ITEMS.

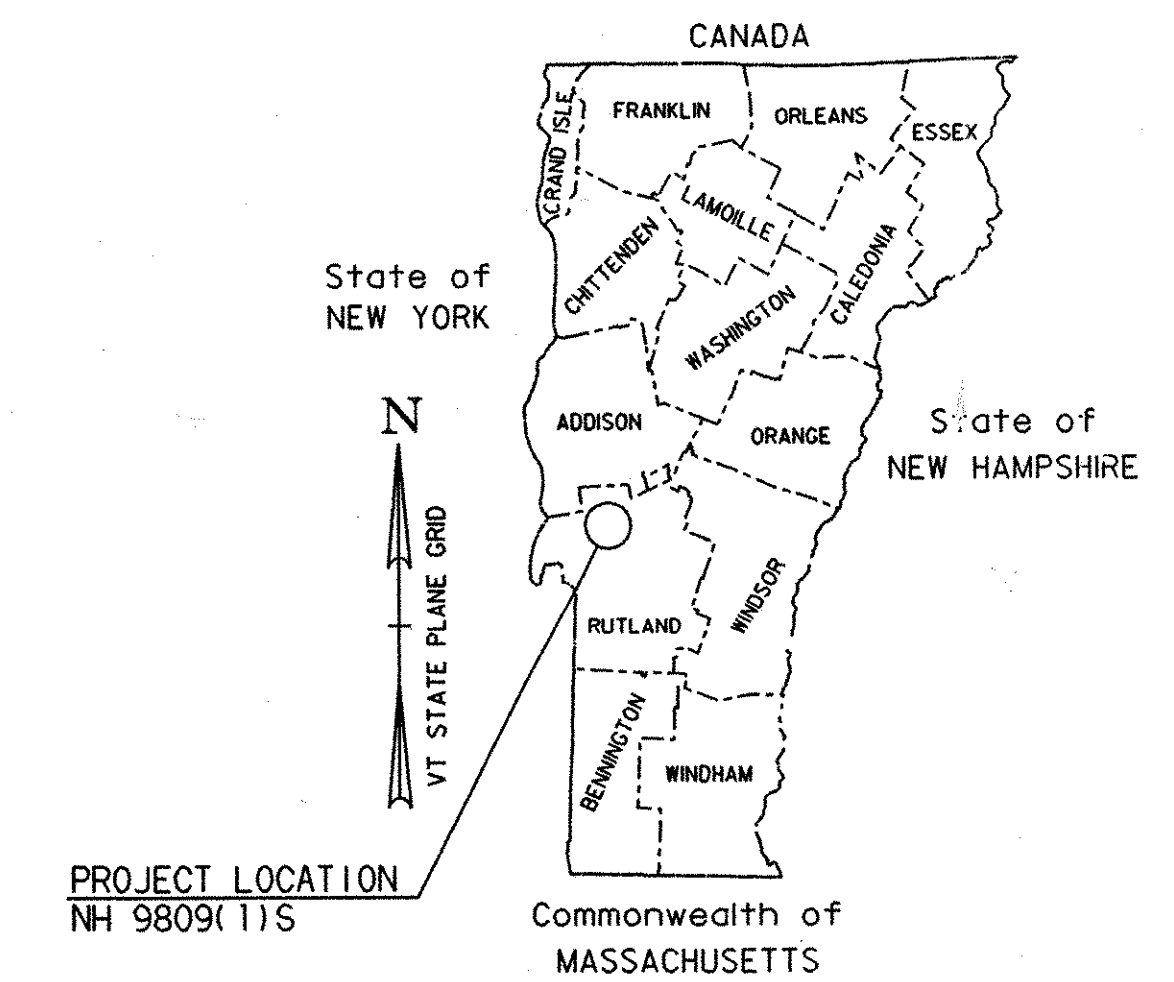
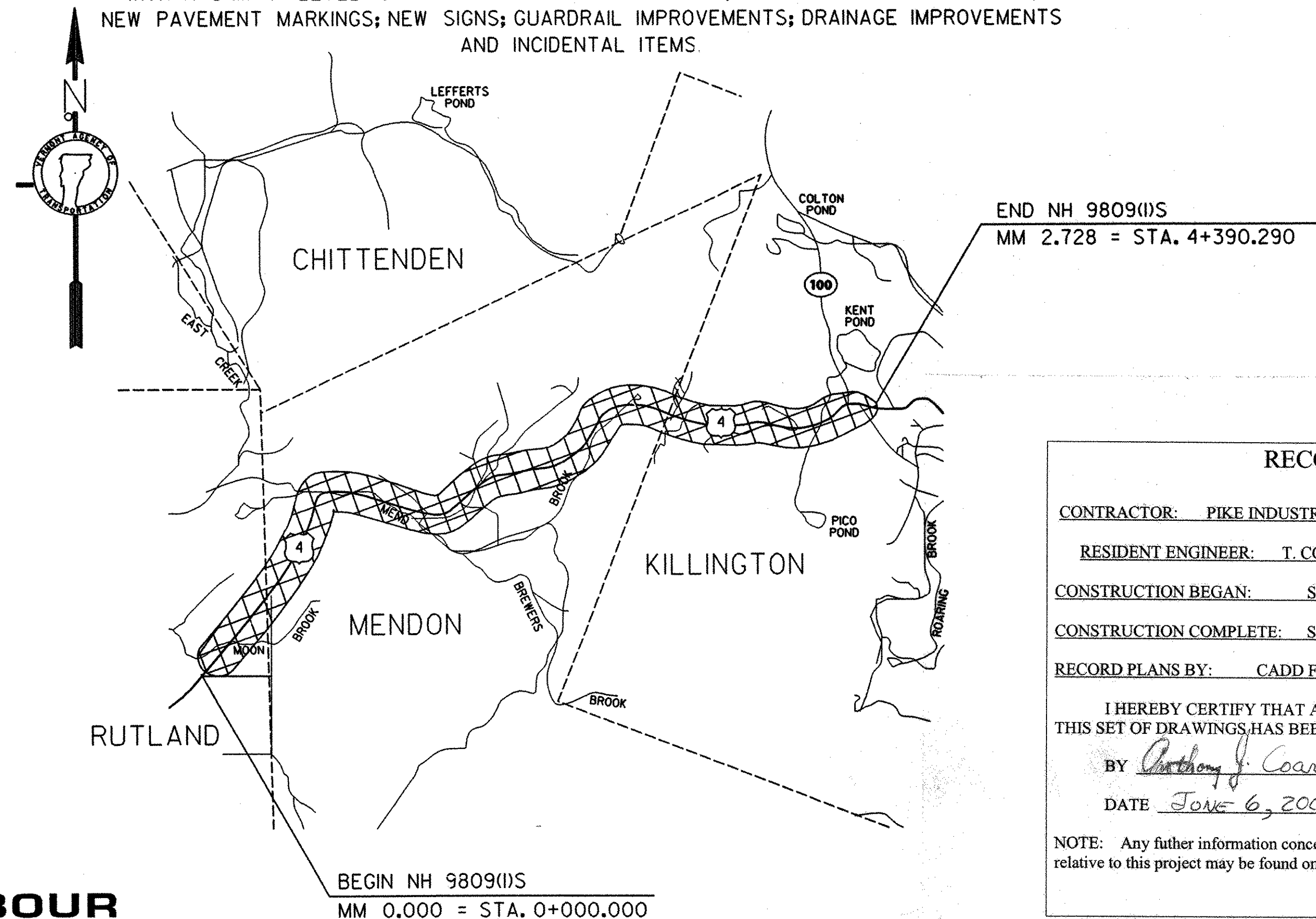

TRAFFIC DATA

U.S. ROUTE 4 (RUTLAND CITY LIMIT TO SHOPPING CENTER)

2000 ADT = 16590
2000 DHV = 1660
2010 ADT = 18960
2010 DHV = 1895
2000 ~ 2010 CUM. ESALS = 6,433,000
2000 ~ 2020 CUM. ESALS = 7,663,000

U.S. ROUTE 4 (SHOPPING CENTER TO T-4)

2000 ADT = 11970
2000 DHV = 1225
2010 ADT = 13680
2010 DHV = 1370
2000 ~ 2010 CUM. ESALS = 6,283,000
2000 ~ 2020 CUM. ESALS = 12,763,000

U.S. ROUTE 4 (T-4 TO PROJECT END)

2000 ADT = 11880
2000 DHV = 1570
2010 ADT = 14410
2010 DHV = 1900
2000 ~ 2010 CUM. ESALS = 6,132,000
2000 ~ 2020 CUM. ESALS = 12,316,000

BITUMINOUS CONCRETE PAVEMENT SUPERPAVE MIXTURE DESIGN CRITERIA	
DESIGN LANE / DESIGN LIFE ESAL	6,381,500
DESIGN NUMBER OF GYRATIONS	100
PERFORMANCE GRADED ASPHALT BINDER	PG 58-34

RECORD PLANS

CONTRACTOR: PIKE INDUSTRIES - BERLIN, VT

RESIDENT ENGINEER: T. COURSE

CONSTRUCTION BEGAN: SEPTEMBER 19, 2000

CONSTRUCTION COMPLETE: SEPTEMBER 19, 2001

RECORD PLANS BY: CADD FINALS & T. COURSE

I HEREBY CERTIFY THAT ALL THE CONSTRUCTION REQUIRED BY THIS SET OF DRAWINGS HAS BEEN ACCOMPLISHED AS INDICATED HEREIN.

BY *Anthony J. Course* RESIDENT ENGINEER

DATE *June 6, 2002*

NOTE: Any further information concerning final quantities, amounts or other details relative to this project may be found on microfiche in Central Files.

UNLESS OTHERWISE NOTED, ALL DRAWINGS AND DETAILS OF THE PROJECT PLANS ARE NOT TO SCALE

RIGHT OF WAY LIMITS, IF APPLICABLE, ARE PROVIDED SOLELY FOR THE CONVENIENCE OF THE STATE AND ITS CONTRACTOR DURING THE COURSE OF THIS PAVING PROJECT. ANY REFERENCES TO OFFSETS ON THESE PLANS ARE APPROXIMATE AND SHOULD NOT BE RELIED UPON FOR ANY OTHER PURPOSES



THESE PLANS ARE SUBJECT TO SUCH ENGINEERING CHANGES AS MAY BE REQUIRED BY THE FEDERAL HIGHWAY ADMINISTRATION OR THE DIRECTOR OF PROJECT DEVELOPMENT.

CONSTRUCTION IS TO BE CARRIED ON IN ACCORDANCE WITH THESE PLANS AND THE STANDARD SPECIFICATIONS FOR CONSTRUCTION DATED 1995, AS APPROVED BY THE FEDERAL HIGHWAY ADMINISTRATION ON AUGUST 21, 1995 FOR USE ON THIS PROJECT, INCLUDING ALL SUBSEQUENT REVISIONS AND SUCH REVISED SPECIFICATIONS AND SPECIAL PROVISIONS AS ARE INCORPORATED IN THESE PLANS.

APPROVED *[Signature]* DATE *11/2/02*
DIRECTOR OF PROJECT DEVELOPMENT

DEPARTMENT OF TRANSPORTATION
FEDERAL HIGHWAY ADMINISTRATION

APPROVED _____ DATE _____
DIVISION ADMINISTRATOR

PROJECT RUTLAND - KILLINGTON
AC NH 9809(1)S
SHEET 1 OF 93 SHEETS

CONVENTIONAL SIGNS

COUNTY LINE	---
TOWN LINE	----
LIMITS OF ACCESS	—o—o—o—
POINT OF ACCESS	X
FENCE LINE	-x-x-
STONE WALL	=====
TRAVELED WAY	=====
GUARD RAIL	—o—o—o—
RAILROAD	+++++
SURVEY LINE	—+—+—+—
CULVERT	—x—x—x—
POWER POLE	—o—o—o—
TELEPHONE POLE	—o—o—o—
TREES	* * *
CONTROL OF ACCESS	///
PROPERTY LINE	—+—+—+—
R.O.W. TAKING LINE	—SR—
SLOPE RIGHTS	—o—o—o—
TOP OF CUT	—▲—▲—▲—
TOE OF SLOPE	—o—o—o—

PLANS PREPARED BY

CHA CLOUGH, HARBOUR & ASSOCIATES LLP
ENGINEERS, SURVEYORS, PLANNERS
& LANDSCAPE ARCHITECTS

WINNERS CIRCLE ALBANY, NEW YORK, 12205

BY *[Signatures]*

DATUM VERTICAL N/A
HORIZONTAL N/A

FILE NAME = \$FILES\$
DATE/TIME = \$DATE\$ \$TIME\$
USER = \$USER\$