

FOR INDEX
SEE SHEET # 2

STATE OF VERMONT AGENCY OF TRANSPORTATION



PROPOSED IMPROVEMENT TOWN OF LUDLOW COUNTY OF WINDSOR VT. ROUTE 103 (N.H.S.) PRINCIPAL ARTERIAL

BEGINNING AT A POINT ON VT. ROUTE 103, IN THE TOWN OF LUDLOW, 0.705 MILES NORTHWEST OF THE CAVENDISH-LUDLOW TOWN LINE AND EXTENDING NORTHWESTERLY 0.174 MILES.

LENGTH OF ROADWAY 919.44 FEET = 0.174 MILES
LENGTH OF PROJECT 919.44 FEET = 0.174 MILES

PROJECT CONSISTS OF REMOVAL OF EXISTING LEDGE ON RIGHT SIDE, NORTHBOUND LANE.

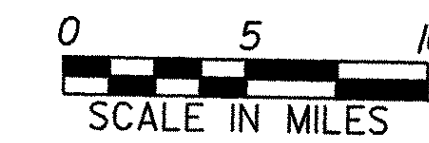
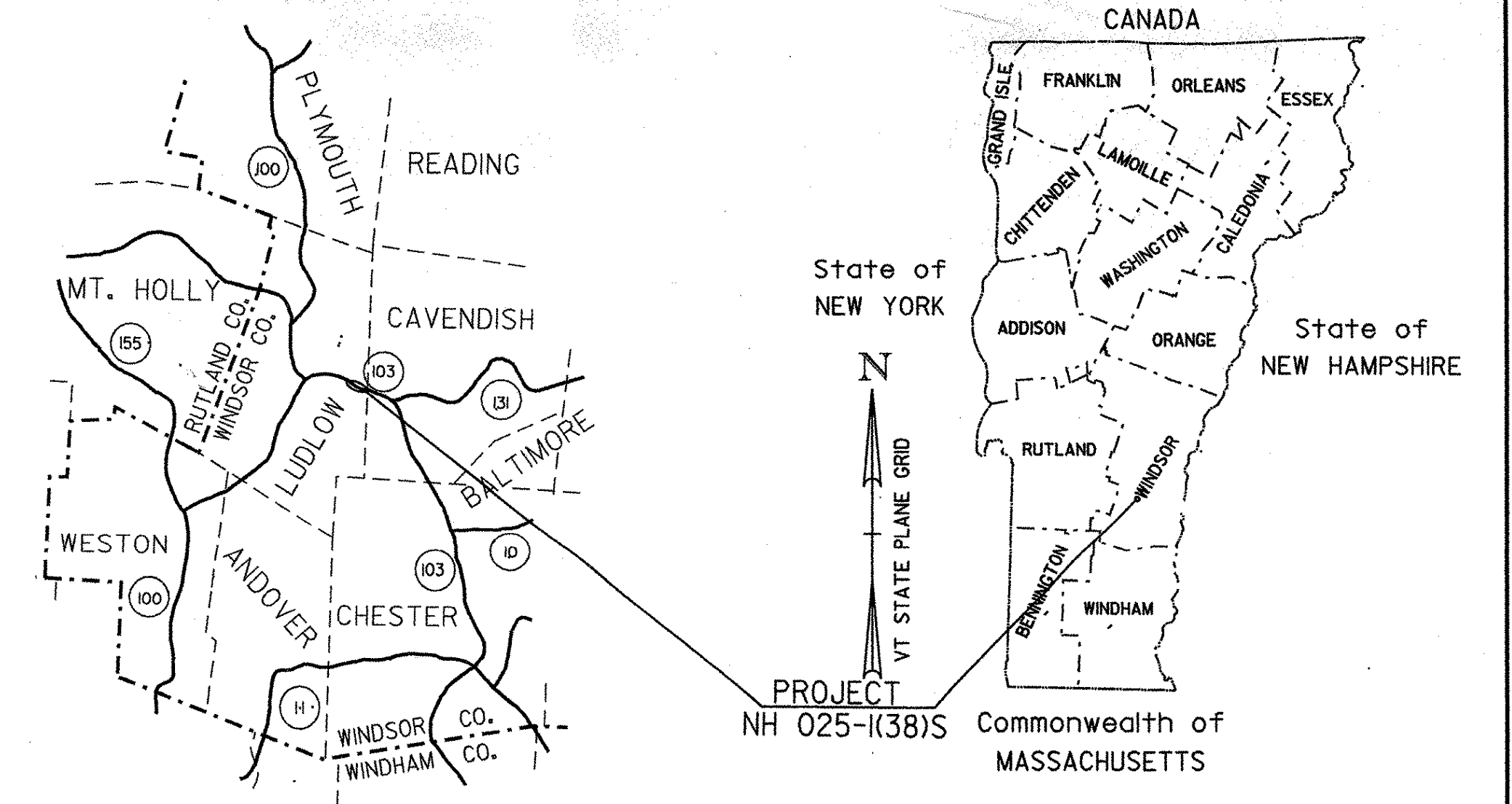

TRAFFIC DATA

2000 ADT	=	8200
2000 DHV	=	890
2020 ADT	=	10700
2020 DHV	=	1200
2000 ADTT	=	600
2020 ADTT	=	940
D	=	51%
2000 T	=	5%
2020 T	=	6%
V	=	50 MPH
20 YEAR ESALS	=	7,029,000
40 YEAR ESALS	=	18,684,000

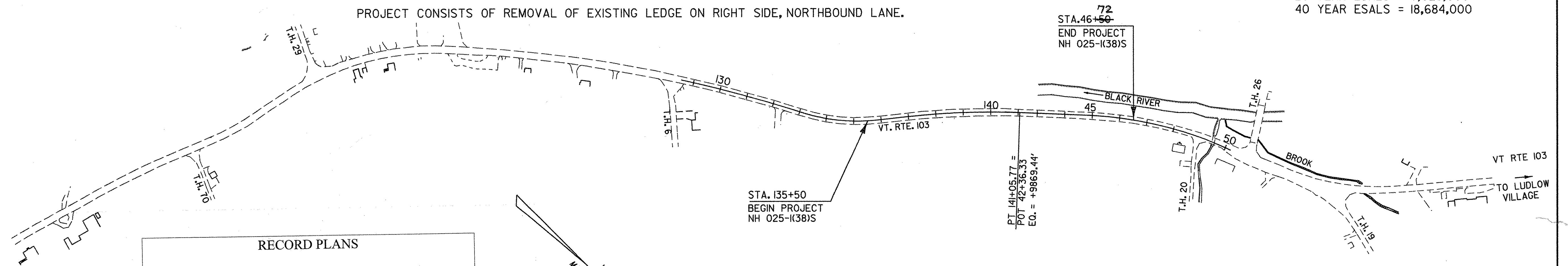

RECORD PLANS

CONTRACTOR: MORRIL CONSTRUCTION - NO. HAVERHILL, NH

RESIDENT ENGINEER: W. STODDARD

CONSTRUCTION BEGAN: MAY 5, 2000

CONSTRUCTION COMPLETE: OCTOBER 18, 2001

RECORD PLANS BY: CADD FINALS & W. STODDARD

I HEREBY CERTIFY THAT ALL THE CONSTRUCTION REQUIRED BY THIS SET OF DRAWINGS HAS BEEN ACCOMPLISHED AS INDICATED HEREIN.

BY *[Signature]* RESIDENT ENGINEER

DATE 5-2-02

NOTE: Any further information concerning final quantities, amounts or other details relative to this project may be found on microfilm in Central Files.

CONVENTIONAL SYMBOLS	
COUNTY LINE	
TOWN LINE	
LIMITS OF ACCESS	
POINT OF ACCESS	
FENCE LINE	
STONE WALL	
TRAVELED WAY	
GUARD RAIL	
RAILROAD	
SURVEY LINE	
CULVERT	
POWER POLE	
TELEPHONE POLE	
TREES	
CONTROL OF ACCESS	
PROPERTY LINE	
R.O.W. TAKING LINE	
SLOPE RIGHTS	
TOP OF CUT	
TOE OF SLOPE	

SURVEYED BY : ORVIS
SURVEYED DATE : 9/15/97

DATUM
VERTICAL NAVD88
HORIZONTAL NAD83 (92)

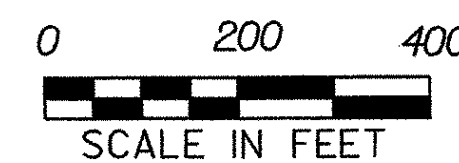

THESE PLANS ARE SUBJECT TO SUCH ENGINEERING CHANGES AS MAY BE REQUIRED BY THE FEDERAL HIGHWAY ADMINISTRATION OR THE DIRECTOR OF PROJECT DEVELOPMENT.

CONSTRUCTION IS TO BE CARRIED ON IN ACCORDANCE WITH THESE PLANS AND THE STANDARD SPECIFICATIONS FOR CONSTRUCTION DATED 1990, AS APPROVED BY THE FEDERAL HIGHWAY ADMINISTRATION ON MARCH 15, 1990 FOR USE ON THIS PROJECT, INCLUDING ALL SUBSEQUENT REVISIONS AND SUCH REVISED SPECIFICATIONS AND SPECIAL PROVISIONS AS ARE INCORPORATED IN THESE PLANS.

DIRECTOR OF PROJECT DEVELOPMENT
APPROVED *[Signature]* DATE 3/27/00

PROJECT MANAGER : G.H. DUBRAY

PROJECT NAME : LUDLOW
PROJECT NUMBER : NH 025-(138)S

16-FEB-2000 DB076TLE SHEET 1 OF 31 SHEETS