

Profile Along Detour Centerline (with offsets)

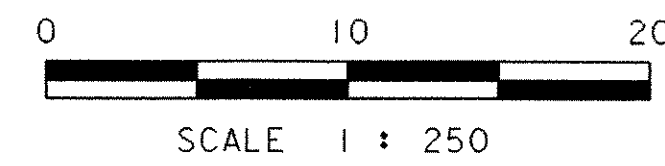

Abutment Retaining Structure Notes

1. All fill required within the limits of the abutment retaining structure and up to the bottom of subbase elevation, shall be Granular Backfill for Structures and be paid under item 204.30 Granular Backfill for Structures.
2. All existing material within a horizontal distance of 1 meter from the abutment foundation shall be removed down to 600 millimeters below the proposed bottom of abutment foundation and filled with Granular Backfill for Structures. The excavation for the abutment foundation shall be paid for under the item 204.25 "Structure Excavation".
3. The abutment retaining structure shall extend a minimum of 0.3 meters and a maximum of 1.0 meters above the fill that it is retaining.
4. At the abutment 1 location, the abutment retaining structure shall extend a minimum of 1.0 meter into the existing ground. At the abutment 2 location, the abutment retaining structure shall extend to elevation 166.0 or to ledge, whichever is higher.
5. To avoid a potential conflict with the bridge constructed under contract 2, no portion of the abutment retaining structure shall extend further than 7.5 meters left of the proposed centerline.
6. See Special Provisions for more information.

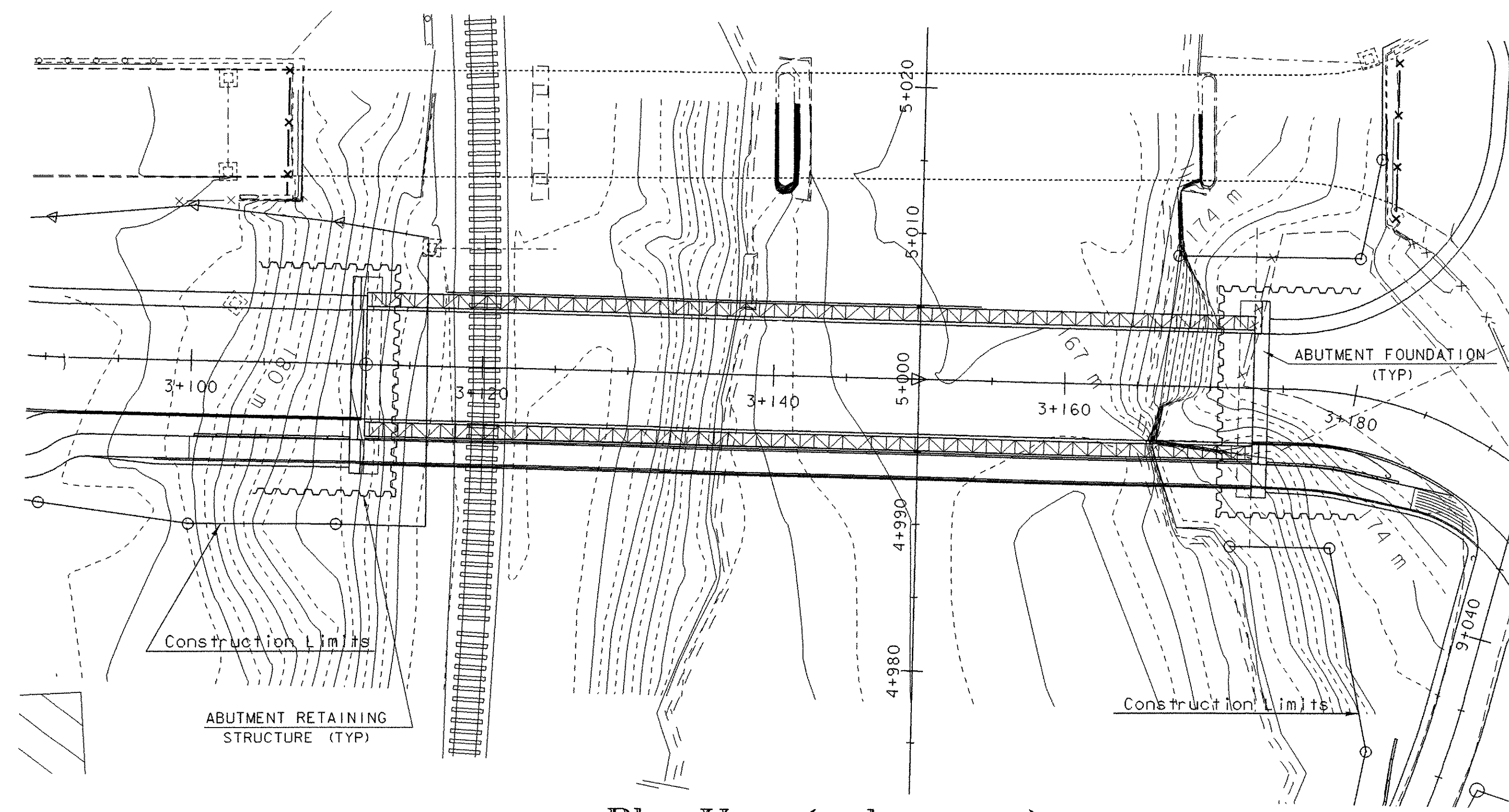

Plan View (with contours) Contour interval 0.5 meters

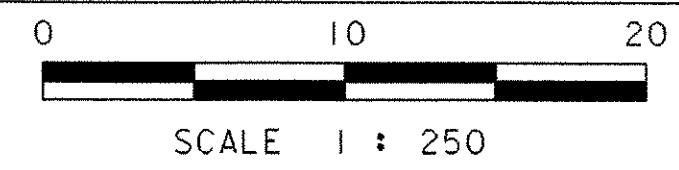

PROJECT NAME:	Bethel	FILE NAME:	s96j250abutret.dgn	PLOT DATE:	09-JUL-2003
PROJECT NUMBER:	BRF 024(33) - CI	PROJECT LEADER:	C. Williams	DRAWN BY:	C. Williams
		DESIGNED BY:	K. Higgins	CHECKED BY:	K. Higgins
		Abutment Retaining Structure		SHEET 27	OF 47