

APPROXIMATE AERIAL RELOCATION
ROUTE BY BARTON VILLAGE, INC. AND
NEW ENGLAND TELEPHONE & TELEGRAPH CO.

ALL NECESSARY EASEMENTS AND/OR
AGREEMENTS FOR AERIAL UTILITIES
WITHIN THE RAILROAD RIGHT-OF-WAY
SHALL BE OBTAINED BY NEW ENGLAND
TELEPHONE & TELEGRAPH CO.

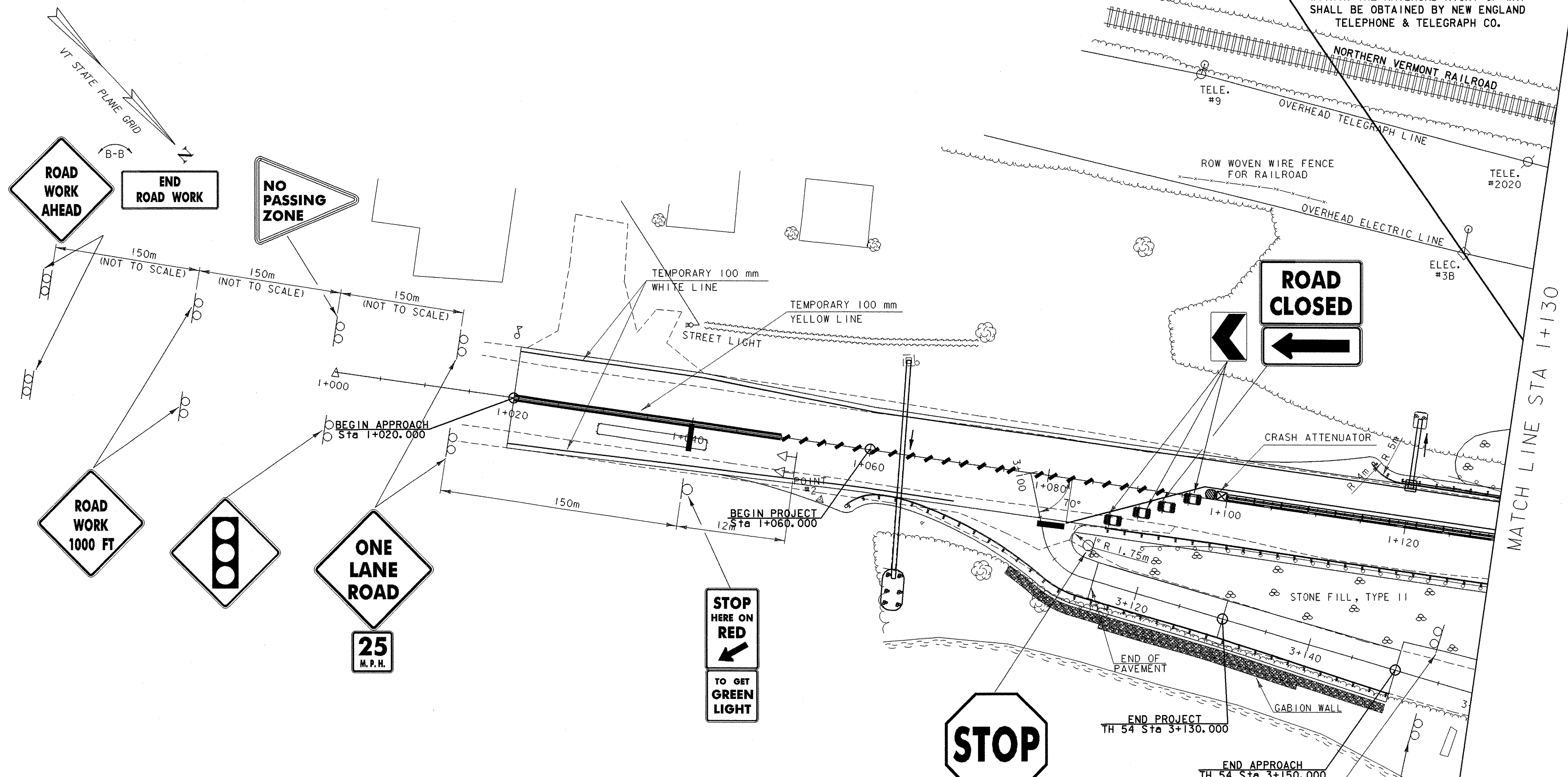

REMOVAL OF EXISTING PAVEMENT MARKINGS
SEE PHASE 2

TEMPORARY 100mm WHITE LINE
STA. 1+070 LT - 1+130 LT
STA. 1+080 RT - 1+130 LT

TEMPORARY 100mm YELLOW LINE
SEE PHASE 2

TEMPORARY STOP BAR
SEE PHASE 2

TEMPORARY VEHICLE DETECTOR
SEE PHASE 2

TEMPORARY SHEET PILING
SEE PHASE 2

TEMPORARY TRAFFIC BARRIER
STA. 1+100 LT - STA. 1+130 LT

ENERGY ABSORPTION ATTENUATOR
SEE PHASE 2

DATUM
VERTICAL NAVD 88
HORIZONTAL NAD 83 (93)

PHASE 3
DETOUR LAYOUT #6

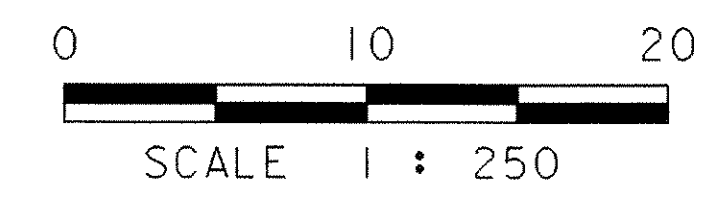

LEGEND

	- SIGN POSTS
	- TYPE III BARRICADES (MOD.)
	- TEMP. TRAFFIC BARRIER
	- LUMINARE
	- STRAIN POLE
	- SIGNAL HEAD
	- ENERGY ABSORPTION ATTENUATOR
	- TEMPORARY SHEET PILING
	- REFLECTORIZED BARREL
	- PAVEMENT MARKING REMOVAL

PROJECT: BARTON	PROJECT NO. : STP 0113 (58) S
DESIGN FILE NAME: 96c116/structures/sc116dr.dgn	PLOT DATE: 03-JAN-2002
IPARM FILE NAME: sc116det6.i	SURVEY DATE: 8/96,5/99
SURVEYED BY: R. BULLOCK, R. GILMAN	DRAWN BY: T.G. ANDERSON
SQUAD LEADER: C.P. WILLIAMS	
DETOUR LAYOUT #6 (PHASE 3)	SHEET: 26 OF 120