

ALL NECESSARY EASEMENTS AND/OR AGREEMENTS FOR AERIAL UTILITIES WITHIN THE RAILROAD RIGHT-OF-WAY SHALL BE OBTAINED BY NEW ENGLAND TELEPHONE & TELEGRAPH CO.

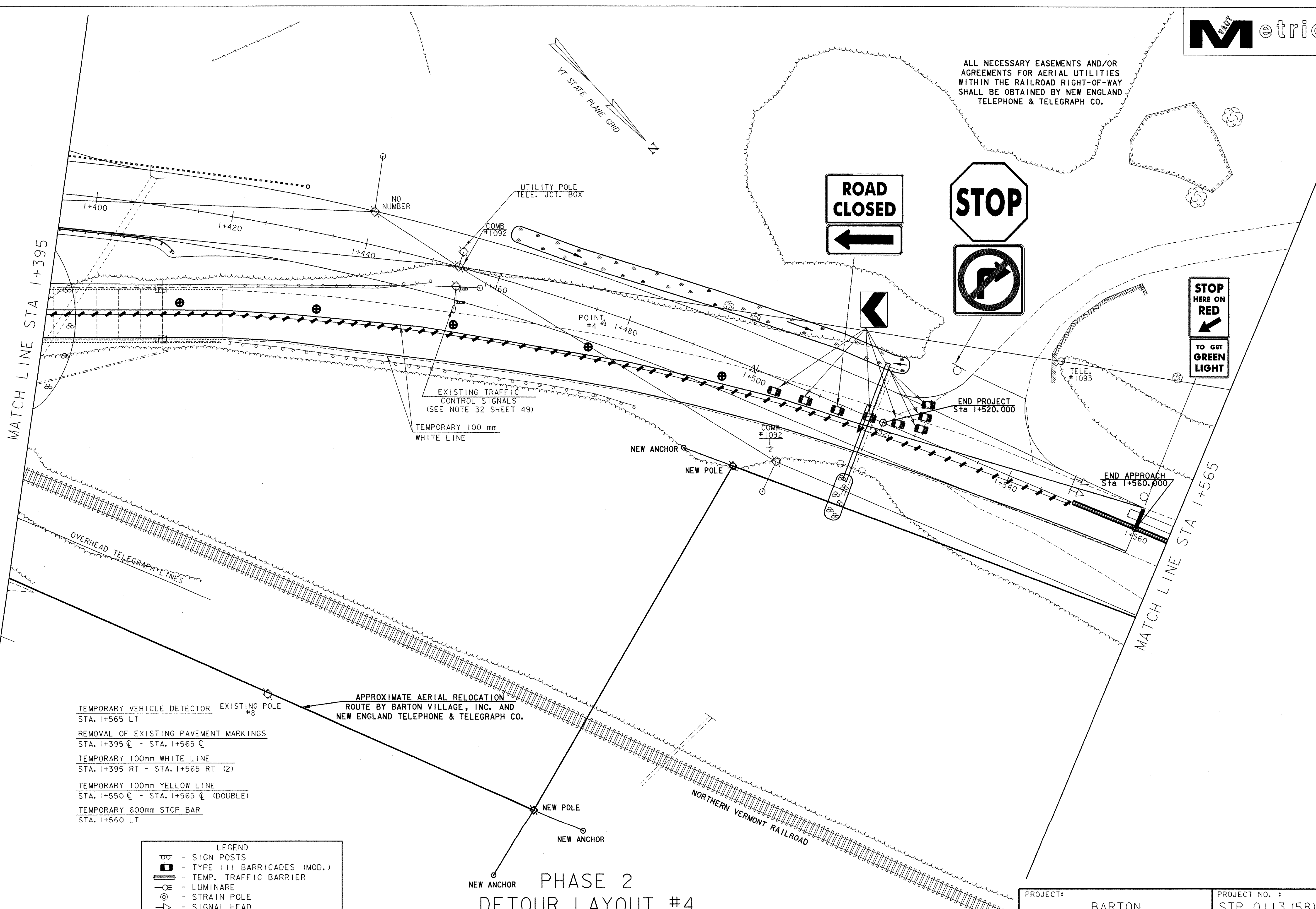

- TEMPORARY VEHICLE DETECTOR EXISTING POLE #8 STA. 1+565 LT
- REMOVAL OF EXISTING PAVEMENT MARKINGS STA. 1+395 CL - STA. 1+565 CL
- TEMPORARY 100mm WHITE LINE STA. 1+395 RT - STA. 1+565 RT (2)
- TEMPORARY 100mm YELLOW LINE STA. 1+550 CL - STA. 1+565 CL (DOUBLE)
- TEMPORARY 600mm STOP BAR STA. 1+560 LT

LEGEND	
	- SIGN POSTS
	- TYPE III BARRICADES (MOD.)
	- TEMP. TRAFFIC BARRIER
	- LUMINARE
	- STRAIN POLE
	- SIGNAL HEAD
	- ENERGY ABSORPTION ATTENUATOR
	- TEMPORARY SHEET PILING
	- REFLECTORIZED BARREL
	- PAVEMENT MARKING REMOVAL

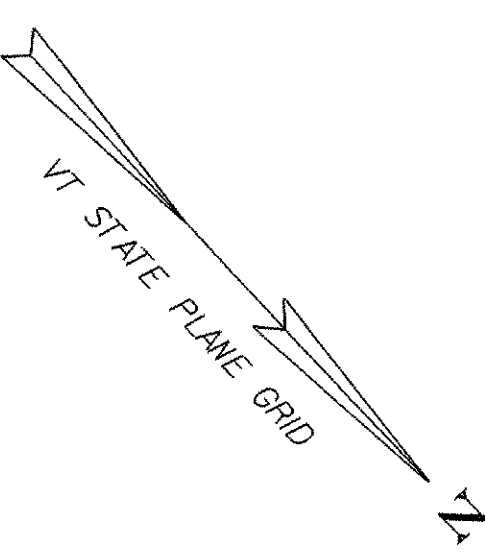
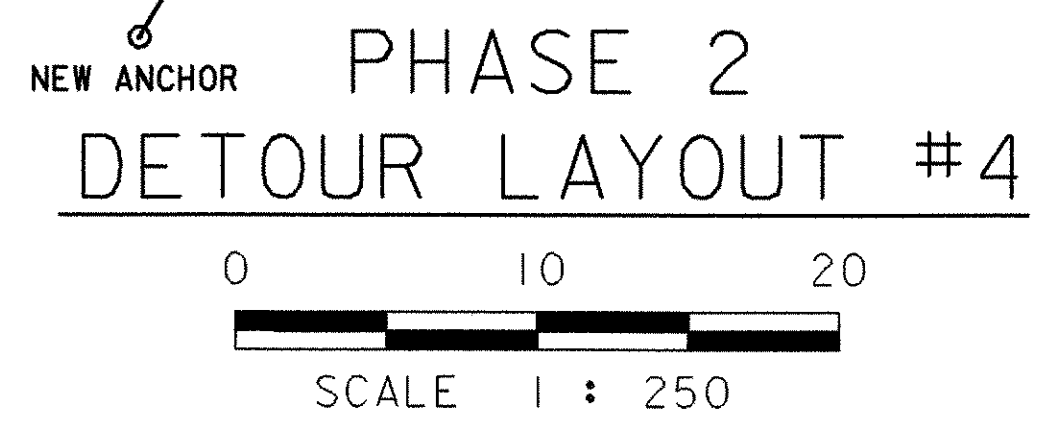

DATUM  
VERTICAL NAVD 88  
HORIZONTAL NAD 83 (93)

PROJECT: BARTON	PROJECT NO.: STP 0113 (58) S
DESIGN FILE NAME: 96c116/structures/sc116bdr.dgn	PLOT DATE: 03-JAN-2002
IPARM FILE NAME: sc116det4.i	SURVEY DATE: 8/96,5/99
SURVEYED BY: R. BULLOCK, R. GILMAN	DRAWN BY: D.G. BASSETT
SQUAD LEADER: C.P. WILLIAMS	SHEET: 24 OF 120
DETOUR LAYOUT #4 (PHASE 2)	