

APPROXIMATE AERIAL RELOCATION
ROUTE BY BARTON VILLAGE, INC. AND
NEW ENGLAND TELEPHONE & TELEGRAPH CO.

ALL NECESSARY EASEMENTS AND/OR
AGREEMENTS FOR AERIAL UTILITIES
WITHIN THE RAILROAD RIGHT-OF-WAY
SHALL BE OBTAINED BY NEW ENGLAND
TELEPHONE & TELEGRAPH CO.

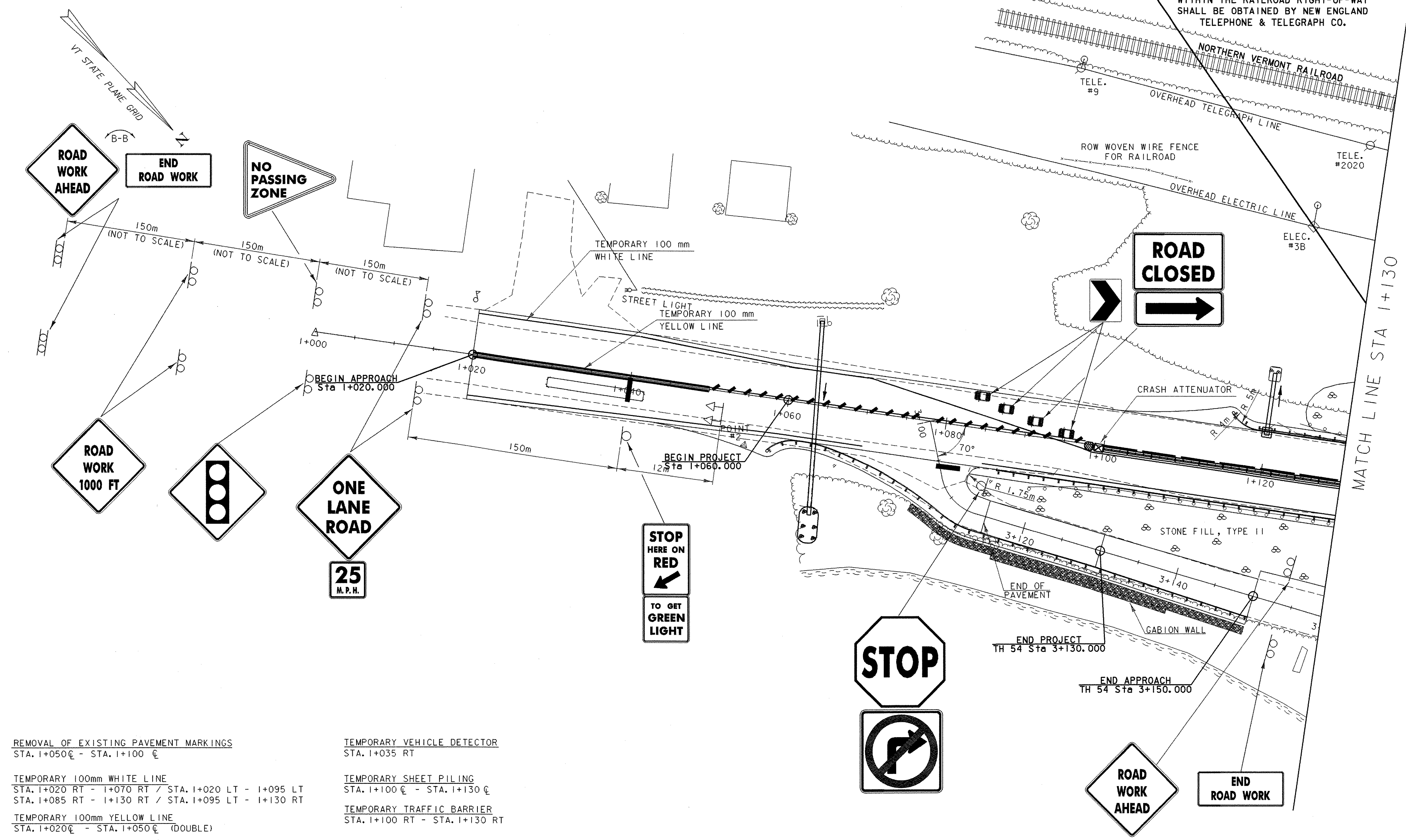

REMOVAL OF EXISTING PAVEMENT MARKINGS
STA. 1+050¢ - STA. 1+100 ¢

TEMPORARY 100mm WHITE LINE
STA. 1+020 RT - 1+070 RT / STA. 1+020 LT - 1+095 LT
STA. 1+085 RT - 1+130 RT / STA. 1+095 LT - 1+130 RT

TEMPORARY 100mm YELLOW LINE
STA. 1+020¢ - STA. 1+050¢ (DOUBLE)

TEMPORARY STOP BAR
STA. 1+040 RT
STA. 3+106 RT

TEMPORARY VEHICLE DETECTOR
STA. 1+035 RT

TEMPORARY SHEET PILING
STA. 1+100 ¢ - STA. 1+130 ¢

TEMPORARY TRAFFIC BARRIER
STA. 1+100 RT - STA. 1+130 RT

ENERGY ABSORPTION ATTENUATOR
STA. 1+100 ¢

PHASE 2
DETOUR LAYOUT #1

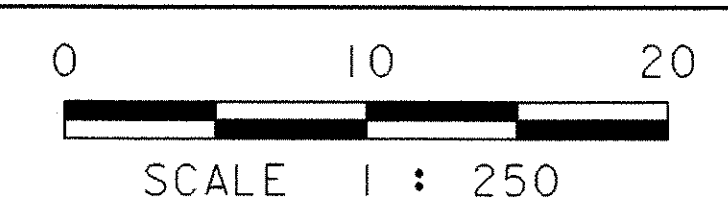

- LEGEND
- SIGN POSTS
 - TYPE III BARRICADES (MOD.)
 - TEMP. TRAFFIC BARRIER
 - LUMINARE
 - STRAIN POLE
 - SIGNAL HEAD
 - ENERGY ABSORPTION ATTENUATOR
 - TEMPORARY SHEET PILING
 - REFLECTORIZED BARREL
 - PAVEMENT MARKING REMOVAL

DATUM
VERTICAL NAVD 88
HORIZONTAL NAD 83 (93)

PROJECT:	BARTON	PROJECT NO. :	STP 0113 (58) S
DESIGN FILE NAME:	96c116/structures/sc116bdr.dgn	PLOT DATE:	03-JAN-2002
IPARM FILE NAME:	sc116det1.i	SURVEY DATE:	8/96,5/99
SURVEYED BY:	R. BULLOCK, R. GILMAN	DRAWN BY:	D.G. BASSETT
SQUAD LEADER:	C.P. WILLIAMS		
DETOUR LAYOUT #1 (PHASE 2)		SHEET:	21 OF 120