

CONSTRUCTION APPROACH SIGNS

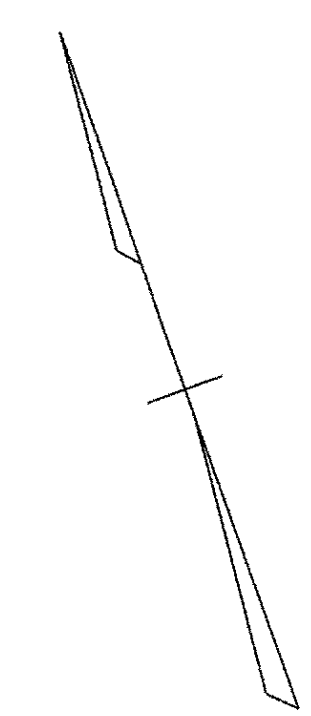
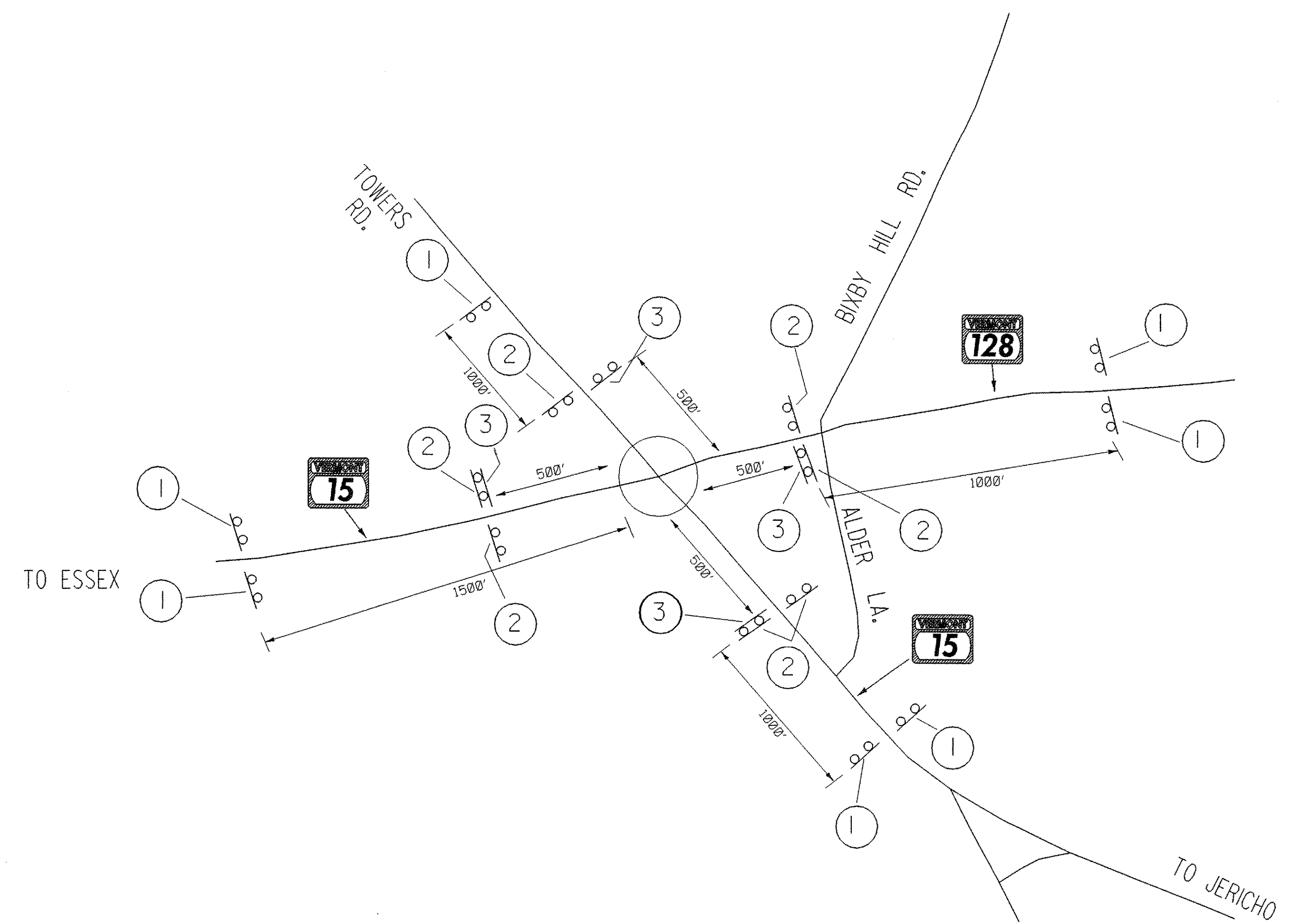
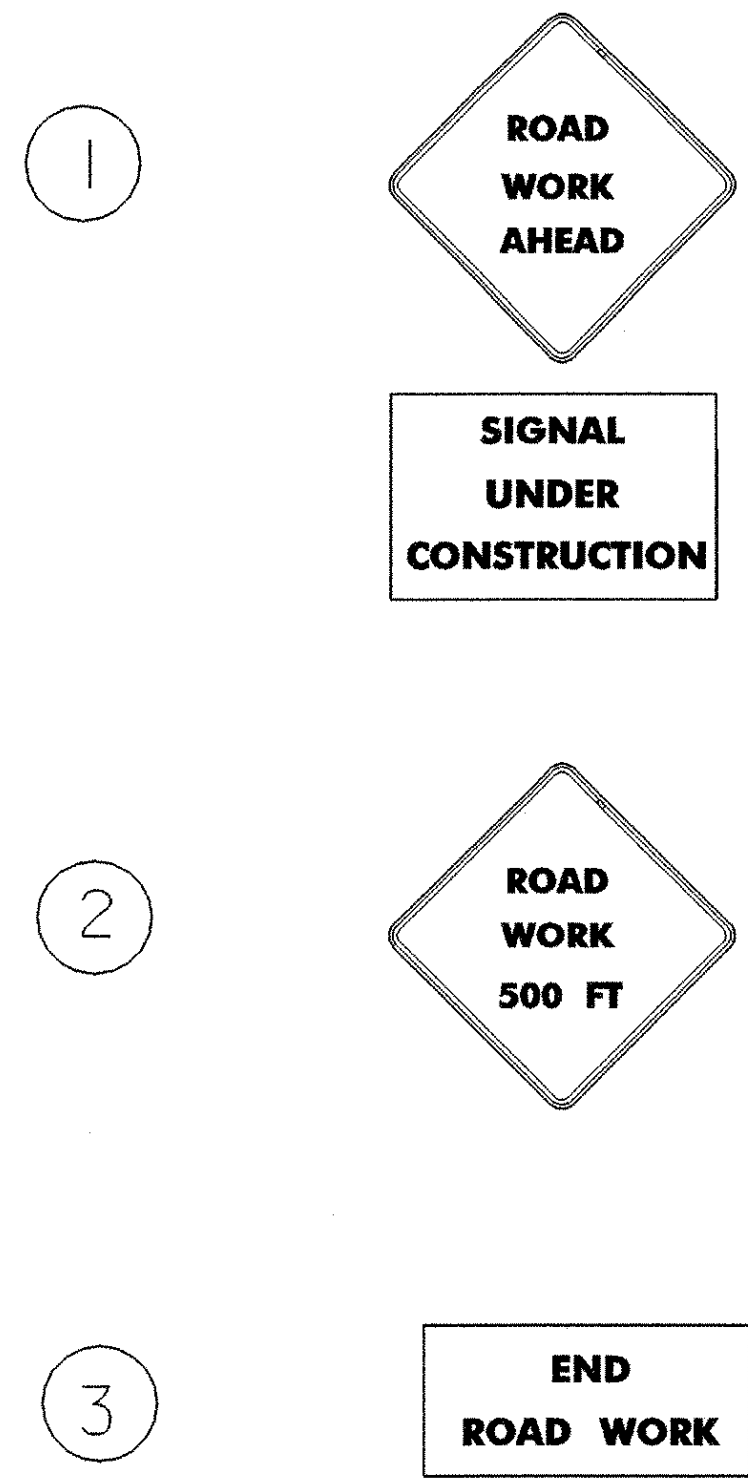

TRAFFIC CONTROL NOTES

1. DURING CONSTRUCTION A MINIMUM OF TWO-WAY TRAFFIC SHALL BE MAINTAINED AT ALL TIMES.
2. NO WORK SHALL BE DONE WITHIN THE HIGHWAY R.O.W. WITHOUT THE APPROPRIATE CONSTRUCTION SIGNING IN PLACE AS SHOWN ON STD E-100 AND THIS SHEET.
3. TRAFFIC CONTROL SIGNING AND CHANNELIZING DEVICES SHALL BE IN ACCORDANCE WITH STANDARD DRAWINGS E-100, 101, 102, 106, 107A, 110, AND THE 2003 MUTCD.
4. CONSTRUCTION APPROACH SIGNING SHALL REMAIN IN PLACE DURING THE ENTIRE CONSTRUCTION PERIOD. THE 'SIGNAL UNDER CONSTRUCTION' SIGNS ARE NOT NECESSARY UNTIL SIGNAL WORK STARTS. WHEN THEY ARE INSTALLED, THEY SHOULD REMAIN UNTIL COMPLETION OF THE PROJECT. OTHER SIGNING SHALL BE REMOVED OR COVERED WHEN NOT APPLICABLE.
5. VARIATIONS IN THE SIGNING PACKAGES MAY BE DICTATED BY UNIQUE GEOMETRY AND/OR TRAFFIC CONDITIONS.
6. IF APPLICABLE, COORDINATE CONSTRUCTION SIGNING WITH OTHER CONSTRUCTION PROJECTS SO AS NOT TO DUPLICATE OR CONTRADICT OTHER SIGNING.
7. PAYMENT FOR TRAFFIC CONTROL WILL BE MADE UNDER CONTRACT ITEM 641.10.
8. SIGNS SHALL NOT INTERFERE WITH OR OBSTRUCT EXISTING TRAFFIC CONTROL DEVICES.

NOT TO SCALE

CONSTRUCTION APPROACH SIGNING SHEET

PROJECT NAME: <u>ESSEX</u>	FILE NAME: 96b182/1b182dw/dgn/1b18200d.i	PLOT DATE: 16-NOV-2006
PROJECT NUMBER: <u>SIPG_SGNL (17)</u>	PROJECT LEADER: <u>B.NYQUIST</u>	DRAWN BY: <u>B.MCAVOY</u>
	DESIGNED BY: <u>B.MCAVOY</u>	CHECKED BY: <u>B.NYQUIST</u>
		SHEET <u>13</u> OF <u>29</u>